

=====
4. National Park Service Certification
=====

I, hereby certify that this property is:

- entered in the National Register _____
 See continuation sheet.
- determined eligible for the _____
National Register
 See continuation sheet.
- determined not eligible for the _____
National Register
- removed from the National Register _____
- other (explain): _____

Signature of Keeper Date
 of Action

=====
5. Classification
=====

Ownership of Property (Check as many boxes as apply)

- private
 public-local
 public-State
 public-Federal

Category of Property (Check only one box)

- building(s)
 district
 site
 structure
 object

Number of Resources within Property

Contributing	Noncontributing
<u>1226</u>	<u>39</u> buildings
	_____ sites
<u>9</u>	_____ structures
	_____ objects
<u>1235</u>	<u>39</u> Total

Number of contributing resources previously listed in the National Register 3

Name of related multiple property listing (Enter "N/A" if property is not part of a multiple property listing.)

N/A

6. Function or Use

Historic Functions (Enter categories from instructions)

Cat: <u>DOMESTIC</u>	Sub: <u>single dwelling, multiple dwelling</u>
<u>RELIGION</u>	<u>Religious facility</u>
<u>EDUCATION</u>	<u>Library, school</u>
<u>TRANSPORTATION</u>	<u>Road-related (vehicular)</u>

Current Functions (Enter categories from instructions)

Cat: <u>DOMESTIC</u>	Sub: <u>single dwelling, multiple dwelling</u>
<u>RELIGION</u>	<u>Religious facility</u>
<u>EDUCATION</u>	<u>Library, school</u>
<u>TRANSPORTATION</u>	<u>Road-related (vehicular)</u>

7. Description

Architectural Classification (Enter categories from instructions)

LATE 19th AND 20th CENTURY REVIVALS
LATE 19th AND EARLY 20th CENTURY AMERICAN MOVEMENTS MODERN MOVEMENT

Materials (Enter categories from instructions)

foundation CONCRETE
roof ASPHALT, TILE, WOOD, ASBESTOS, SLATE
walls BRICK, STUCCO, WOOD, STONE

other _____

Narrative Description (Describe the historic and current condition of the property on one or more continuation sheets.)

8. Statement of Significance

Applicable National Register Criteria (Mark "x" in one or more boxes for the criteria qualifying the property for National Register listing)

- A Property is associated with events that have made a significant contribution to the broad patterns of our history.
- B Property is associated with the lives of persons significant in our past.
- C Property embodies the distinctive characteristics of a type, period, or method of construction or represents the work of a master, or possesses high artistic values, or represents a significant and distinguishable entity whose components lack individual distinction.
- D Property has yielded, or is likely to yield information important in prehistory or history.

Criteria Considerations (Mark "X" in all the boxes that apply.)

- A owned by a religious institution or used for religious purposes.
- B removed from its original location.

- C a birthplace or a grave.
- D a cemetery.
- E a reconstructed building, object, or structure.
- F a commemorative property.
- G less than 50 years of age or achieved significance within the past 50 years.

Areas of Significance (Enter categories from instructions)

ARCHITECTURE
COMMUNITY PLANNING AND DEVELOPMENT
LANDSCAPE ARCHITECTURE
TRANSPORTATION

Period of Significance 1909-1958

Significant Dates 1909, 1916, 1945

Significant Person (Complete if Criterion B is marked above)

Cultural Affiliation n/a

Architect/Builder Various, see Continuation Sheets (Section 7)

Narrative Statement of Significance (Explain the significance of the property on one or more continuation sheets.)

=====

9. Major Bibliographical References

=====

(Cite the books, articles, and other sources used in preparing this form on one or more continuation sheets.)

Previous documentation on file (NPS)

- preliminary determination of individual listing (36 CFR 67) has been requested.
- previously listed in the National Register
- previously determined eligible by the National Register
- designated a National Historic Landmark
- recorded by Historic American Buildings Survey # _____
- recorded by Historic American Engineering Record # _____

Primary Location of Additional Data

- State Historic Preservation Office
- Other State agency
- Federal agency
- Local government
- University
- Other

Name of repository: Lincoln/Lancaster County Planning Dept., 555 S. 10th Street, Lincoln, NE 65808

=====

10. Geographical Data

=====

Acres of Property 450 acres (more or less)

UTM References (Place additional UTM references on a continuation sheet)

	Zone	Easting	Northing	Zone	Easting	Northing	
1	14	695250	4518000	3	14	696450	4517850
2	14	696200	4518000	4	14	696500	4517100

See continuation sheet.

Verbal Boundary Description (Describe the boundaries of the property on a continuation sheet.)

Boundary Justification (Explain why the boundaries were selected on a continuation sheet.)

11. Form Prepared By

name/title Ed Zimmer, Historic Preservation Planner

organization Lincoln/Lancaster County Planning Dept. date September 19, 2008

street & number 555 S. 10th Street telephone (402)441-6360

city or town Lincoln state NE zip code 68508

Additional Documentation

Submit the following items with the completed form:

Continuation Sheets

Maps

A USGS map (7.5 or 15 minute series) indicating the property's location.

A sketch map for historic districts and properties having large acreage or numerous resources.

Photographs

Representative black and white photographs of the property.

Additional items (Check with the SHPO or FPO for any additional items)

Property Owner

(Complete this item at the request of the SHPO or FPO.)

name Various

street & number _____ telephone _____

city or town _____ state _____ zip code _____

Paperwork Reduction Act Statement: This information is being collected for applications to the National Register of Historic Places to nominate properties for listing or determine eligibility for listing, to list properties, and to amend existing listings. Response to this request is required to obtain a benefit in accordance with the National Historic Preservation Act, as amended (16 U.S.C. 470 et seq.). A federal agency may not conduct or sponsor, and a person is not required to respond to a collection of information unless it displays a valid OMB control number.

Estimated Burden Statement: Public reporting burden for this form is estimated to range from approximately 18 hours to 36 hours depending on several factors including, but not limited to, how much documentation may already exist on the type of property being nominated and whether the property is being nominated as part of a Multiple Property Documentation Form. In most cases, it is estimated to average 36 hours per response including the time for reviewing instructions, gathering and maintaining data, and completing and reviewing the form to meet minimum National Register documentation requirements. Direct comments regarding this burden estimate or any aspect of this form to the Chief, Administrative Services Division, National Park Service, 1849 C St., NW, Washington, DC 20240.

**United States Department of the Interior
National Park Service**

**National Register of Historic Places
Continuation Sheet**

Section number 7 Page 1

Boulevards Historic District

Name of Property

Lancaster County, Nebraska

County and State

Summary

The Boulevards Historic District is a large, early 20th century residential neighborhood two miles southeast of Downtown Lincoln, Nebraska. The area is generally bounded on the north by South Street; on the southwest by Lincoln County Club and west by Irvingdale Park, South 22nd Street, and South 24th Street; on the south by Lincoln Country Club and Calvert Street; and on the east by Sheridan Blvd. and the Rock Island Trail (former Rock Island Railroad). The area comprises about 450 acres and includes 1226 contributing buildings and nine structures (a bridge and eight segments of brick-paved streets). Two historic churches (Westminster Presbyterian Church of 1925 and Tifereth Israel Synagogue of 1954) mark the north and south ends of Sheridan Blvd. in the district; two historic schools (Irving Middle School of 1927 and Sheridan Elementary School of 1925) are located at the west and northeast edges. The central Sheridan Boulevard, a 150-foot-right-of-way with a wide, landscaped center median, deviates from Lincoln's street grid to follow a high ridge of land in a southeasterly direction away from central Lincoln, towards the neighborhood (and formerly independent town) of College View. Several smaller streets follow the topography and display special treatments including medians, such as Woodscrest Avenue, Woodsdale Blvd., Bradfield Drive, Stratford Avenue, and Manse Avenue. Other streets continue the Lincoln grid. The integrity of the historic buildings and of the historic land development patterns is very high.

Pattern of Land Development

The Boulevards Historic District consists of a series of closely related residential subdivisions in the vicinity of Sheridan Boulevard, a 150-foot right-of-way with a wide center median and wide grassy "parkings" between curb and sidewalk. Mark Woods House of 1913 (2501 South Street) and Westminster Presbyterian Church of 1925 (2110 Sheridan Blvd.) stand as grand gateways at the north end of the Boulevard. The Frank Spalding House at 2221 Sheridan Blvd. of 1909 (NRHP), a Mission Revival house of Colorado redstone, was under construction even before the street was formally platted. Many of the houses in Sheridan Place are bungalows and American four-squares, with larger homes on the big lots on the boulevard and more modest houses on the lots to the east and west. Sheridan Place of 1909 was platted with alleys behind the residential lots. These were vacated after the original platting and none of the subsequent developments in the historic district were platted with alleys.

At Lake Street Sheridan Boulevard curves and adopts the generally southeasterly course it follows for the rest of its length. The Woods Bros. platted Woodscrest south of Sheridan Place in 1916 and that same year Harvey Rathbone platted Sheridan Park, continuing the land development from 27th Street east to 31st Street, from South Street south to Van Dorn Street. Woodscrest consisted of 60 acres of land organized into two dozen lots (averaging two acres east) in the eastern two-thirds and about twice as many more conventionally sized lots in the western third. Jens Jensen of Chicago laid out that subdivision as well as designing the landscape for Frank Woods House of 1916 at 2501 Sheridan (NRHP). South 24th Street and the eastern portion of Woodscrest Avenue features landscaped center medians, which widen into a little park at the crook of Woodscrest northwest of 27th and Van Dorn. Rathbone's Sheridan Park extends the wide central Sheridan Boulevard and echoes its diagonal with the roughly parallel Stratford Avenue to the north and Manse Avenue to the south. Bradfield Drive runs generally north-south through

**United States Department of the Interior
National Park Service**

**National Register of Historic Places
Continuation Sheet**

Section number 7 Page 2

Boulevards Historic District

Name of Property

Lancaster County, Nebraska

County and State

the center of Sheridan Park, with gentle curves at the north and south ends. Stratford, Manse, and Bradfield all feature center medians of narrower dimensions than the main Boulevard. Ernst Herminghaus, Nebraska's first academically trained landscape architect, and his classmate Tell Nicholet designed Sheridan Park. Hedges outline sidewalks and curb-lines at several locations in the subdivision and appear to be early features.

South of east-west Van Dorn Street, the Woods Bros. platted Woodsdale Subdivision in 1917 and Woods Bros Country Club Addition in 1921. South of these developments and west of South 27th Street, the Woods Bros. developed Lincoln Country Club, which opened in 1924 and forms the south limit of the residential district. Woodsdale Boulevard features generous medians, while South 24th Street continues the narrower center islands of that street between Lake and Van Dorn. The west end of Woodsdale Boulevard (the Woods Bros. Country Club Add.) meanders through several curves opposite the Country Club and offers large lots developed with large, Period Revival houses.

East of the Country Club (hence east of 27th Street) and south of Van Dorn, the Woods Bros. and Harvey Rathbone developed several smaller subdivisions in the 1910s and early 1920s, completing the historic development of the area as far south as Calvert Street. The streets in this area such as Woodsdale, Jackson Drive, South 31st, and Georgian Court have neither alleys nor sidewalks in their original development. At the south edge of the district, the Woods Bros.'s 1894 plat of Capitol Hill was not built out until post-World War II. Reflecting its early date of subdivision, that area is a traditional grid, originally with alleys. In the subsequent development few sidewalks were built, most of the alleys were vacated, and narrow streets were paved, creating with the generally Colonial Revival and ranch style residences a character very compatible with the overall district. Lastly, Harvey Rathbone and his associates platted Rathbone's Colonial Village on the northeast edge of the district between Sheridan Park and the Rock Island Railroad right-of-way, beginning in 1939. The build-out with small houses of ranch and Colonial Revival style on narrow streets is very similar to the south edge of the district.

Architectural Description

The Boulevards District features many of Lincoln's largest Period Revival style houses, principally along Sheridan Boulevard, Woodscrest from the Boulevard to 24th Street, along Van Dorn Street, and on Woodsdale facing the Country Club. Many of these houses were designed by Lincoln's leading architects including Davis & Wilson, Fiske & Meginnis, Miller & Craig. (A full listing of the architects or designer/builders of the District houses is included in this Description.) Specific subtypes with the Period Revival include numerous Tudor examples, many Colonial and Federal Revival homes, and a smaller but significant representation of Renaissance Revival, Chateausque, French Eclectic, Mission, and Spanish Colonial examples. In the northern parts of the district, the "side" streets include both smaller Period Revival examples and many bungalows and American Four-squares of the early 20th century American movements. In the southeastern part of the district off the major streets, smaller Period Revival homes, especially of Colonial and Federal Revival types, predominate, mixed with ranch style houses after World War II. Many of these were designed and built by Selmer Solheim or Unthank & Unthank. The final build-out of the district, in the decade or so following World War II, occurred on the south end of Sheridan Boulevard, along Summit

**United States Department of the Interior
National Park Service**

**National Register of Historic Places
Continuation Sheet**

Section number 7 Page 3

Boulevards Historic District

Name of Property

Lancaster County, Nebraska

County and State

Boulevard, south of Woodsdale to Calvert, and in Rathbone's Colonial Village (Mayflower, Colonial Drive, Winthrop). Colonial Revival and ranch style houses were the primary forms built.

Properties listed on the National Register of Historic Places and designated Lincoln Landmarks

Frank Spalding House, 2221 Sheridan Blvd., NRHP.

1909, F. C. Fiske (architect), Mission Style, Colorado red sandstone

Frank & Nelle (Cochrane) Woods House, 2501 Sheridan Blvd., NRHP

1916, Paul V. Hyland (Chicago, architect), Jens Jensen (landscape architect), Renaissance Revival, stucco

William F. Hitchcock House, 2733 Sheridan Blvd., NRHP and Lincoln Landmark

1922, Jesse B. Miller (architect), Colonial Revival, stucco/tile roof

Charles Roberts House, 3158 Sheridan Blvd., Lincoln Landmark

Ca. 1917, Artemas Roberts (architect), American Four-square, red brick.

George Fawell House, 2401 Ryons Street, Lincoln Landmark.

1916, F. C. Fiske (architect), Period Revival (Mediterranean villa), stucco over frame.

Public and religious properties

Westminster Presbyterian Church at 2110 Sheridan Blvd. is a red-brick Gothic Revival church with limestone trim, designed by Davis & Wilson and built in 1925. The primary facade is oriented west to the Boulevard. The east side faces a parking area that steps down across most of the block. (The South Branch Library and Wishard House, at the northeast and southwest corners of the block, are the only structures remaining on the block with the church.)

Congregation Tifereth Israel Synagogue at 3219 Sheridan Blvd., also a Davis & Wilson design, was constructed in 1954 in the International Style. It is set back from the Boulevard on a brick-paved access road. The red brick structure has a tall, blocky, three-bay central sanctuary with banded windows at the base, a symbolic menorah at the top of the central panel, and a large, limestone-framed window in each side bay. To each side of the central block is a lower wing, featuring the primary entrance on the taller north (right) side.

Irving Middle School at 2745 South 22nd Street anchors the west edge of the district with a red brick Collegiate Gothic public school building with limestone trim, constructed in 1926 from designs by Meginnis and Schaumberg. The school is oriented to the east, towards the residences, rather than south towards Van Dorn Street or the Country Club. A new, lower brick wing to the west houses Irving Recreation Center, a joint facility operated by Lincoln

**United States Department of the Interior
National Park Service**

**National Register of Historic Places
Continuation Sheet**

Section number 7 Page 4

Boulevards Historic District

Name of Property

Lancaster County, Nebraska

County and State

Parks & Recreation Dept. The three-story school has a major addition to the north, designed in the 1990s in fine, complementary manner by Sinclair Hille Architects.

South Branch City Library at 2675 South Street is an urban building which hugs the corner of a busy intersection, with tall windows framed in limestone. Designed by Martin I. Aitken and built in 1955, the structure is a pristine example of the International Style applied to small public building.

Sheridan Elementary School at 3100 Plymouth Avenue was designed by Davis & Wilson and built for Lincoln Public Schools in 1925. The principal entrance is inconspicuously located to the west, towards dead-end Wendover Avenue. A playground stands between Plymouth and the narrow south end of the building, which features a limestone framed Colonial Revival doorway. Other Colonial Revival ornaments include bay windows and balustrades at the parapet. The school has newer additions for a gymnasium and mechanical rooms towards the north (rear). A renovation of 2007-8 reinstalled full-height windows similar to the long-lost original fenestration.

“Penny” Bridge is a twin-span, reinforced concrete structure of 193_, with cast-concrete railings on both sides of both roadways. The bridges carry Sheridan Boulevard over the Rock Island Railroad right-of-way, now developed as a paved hiker-biker trail. Sidewalks are provided on both of the outer edges. A wooden trestle structure between the roadways formerly carried streetcar tracks over the railroad. It was removed after the cessation of trolley service in 1945.

Brick-paved streets remain exposed at several areas of the district, comprising eleven blocks or approximately 3000 linear feet. South 24th Street from South Street to Lake Street is the longest segment and links to brick-paved Ryons and Sewell Streets, connecting eastward to Sheridan Boulevard. The other segments are Ryons between South 27th and Jackson Drive, Sewell between Sheridan Boulevard and South 27th Street, Wendover from Bradfield to Sheridan School, Manse Avenue from Bradfield Drive to Van Dorn Street (where the brick pavement is split by a landscaped median), and a segment of service road south off Sheridan Boulevard at East Summit.

NOTES on Integrity and Contributing Properties:

1) *Due to the very large number of contributing primary buildings in this district, secondary structures such as garages are not counted separately.*

2) *98% of the structures in the district were built within the period of significance (1909-1958).*

2) *The district has a high degree of integrity of pattern of land development and condition of individual buildings. 97% of the buildings in the district are regarded as contributing to the character of the district. 3% (39 buildings) are non-contributing by date of construction or because of alterations that prevent them from conveying their essential design qualities and their contribution to the overall streetscapes. Brick and stone houses are predominant in the district. Some of the frame structures have been re-sided with vinyl or metal products but still contribute in scale, mass, and overall form to the district's historic character and therefore are included among the contributing structures.*

**United States Department of the Interior
National Park Service**

**National Register of Historic Places
Continuation Sheet**

Section number 7 Page 5

Boulevards Historic District

Name of Property

Lancaster County, Nebraska

County and State

Property listing
(Attached, Section 7, pages 5-45)

Address	BP Date	BP #	Builder/Architect	Status	NeHBS LC13:	Occupant	Occupation
Alden Ave 3100	1940	33463	Lincoln Housing Co./Rathbone, Harvey	C	E-5 415	Norval, Richard (Florence)	
Alden Ave 3107	1940	31920	Gage, Rex T.	C	E-5 405		
Alden Ave 3110	1941	35152	Trott, Russell C.	C	E-5 416	Trott, Russell C. (Vivian)	mail carrier
Alden Ave 3116	1941	34109	Hoesch, Albert W.	C	E-5 417	Johnston, Wilford (Pauline)	Sales Super., Consumer Power
Alden Ave 3117	1940	31922	Miller, Max H.	C	E-5 404	Wright, Flavel (Marion)	lawyer
Alden Ave 3127	1940	32683	Mahoney, J. Phillip	C	E-5 403		
Alden Ave 3128	1940	32518	Hoesch, Albert W.	C	E-5 418	Hahn, Herbert (Pearl)	sec., NE Petroleum Industries Cmte
Alden Ave 3131	1945	41058	Sweeney-Solheim Co.	C	E-5 402		
Alden Ave 3140	1940	33042	Lincoln Housing Co./Rathbone, Harvey	C	E-5 419	Trott, Ella	widow Charles
Alden Ave 3141	1945	40232	Sweeney-Solheim Co.	C	E-5 401		
Alden Ave 3156	1941	34188	Edwards, M. F.	C	E-5 420	Edwards, Michl (Verna)	asst used car mngr, Fred Sidles Motors
Alden Ave 3158	1941	35696	Hoesch, Albert W.	C	E-5 421		
Alden Ave 3161	1944	39112	Sweeney-Solheim Co.	C	E-5 400		
Alden Ave 3170	1941	35006	Lincoln Housing Co.	C	E-5 422		
Alden Ave 3171	1944	39111	Sweeney-Solheim Co.	C	E-5 399		
Alden Ave 3181	1949	51318	Kessler, Clarence E.	C	E-5 398		
Bradfield Dr 2100	1922	10066	Rathbone Carpenter Co.	C	E-5 224	Marshall, Fred. C.	printer
Bradfield Dr 2101	1923	11046	Unthank, George R.	C	E-5 312	Trenholm, Earl S.	
Bradfield Dr 2110	1925	13990	Dunn, Mrs. Lester/C. A. Nootz	C	E-5 225	Dunn, Lester L.	attorney, legislator
Bradfield Dr 2111	1928	18242	Larsen, C.M.	C	E-5 311	Misch, Fred. W.	exec. VP, Smith Dorsey
Bradfield Dr 2120	1925	13316	Rathbone Carpenter Co.	C	E-5 226	Ashton, Thomas	saleman
Bradfield Dr 2125	1919	7829	Harvey Enslow Lumber Co.	C	E-5 310	Latsch, Jerome E.	
Bradfield Dr 2135	1922	10140	Searce, Fred	C	E-5 309	Schmidt, August C.	Insurance
Bradfield Dr 2145	1919	7948	Parks, William N.	C	E-5 308	Moreland, Otto F.	pres., Biz Men's Protective Assoc.
Bradfield Dr 2200	1924	12807	Cobel, George	C	E-5 228	Cobel, Geo. W.	Cobel Banking Systems
Bradfield Dr 2222	1918	7578	Jacobs, H.	C	E-5 229	Gebhard, Adolph	clerk, Mayer Bros. clothing
Bradfield Dr 2236	1918	7579	Jacobs, H.	C	E-5 230	Illingsworth, Alfred	
Bradfield Dr 2244	1925	13753	Rathbone Carpenter Co.	C	E-5 231	Strohecker, Wm	Insurance
Bradfield Dr 2252	1922	9665	Grubb, W.G.	C	E-5 232	Alspaugh, Phillip C.	buyer, Golds & Co.

United States Department of the Interior
National Park Service

National Register of Historic Places
Continuation Sheet

Section number 7 Page 6

Boulevards Historic District

Name of Property

Lancaster County, Nebraska

County and State

Address	BP Date	BP #	Builder/Architect	Status	NeHBS LC13:	Occupant	Occupation
Bradfield Dr 2302	1920	8786	Madden, Herbert B.	C	E-5 233	Westphal, Geo. R.	auditor, Bankers Life
Bradfield Dr 2305	1920	8569	Jeary, Clark	C	E-5 253	Jeary, Clark	Atty, mayor, legislator
Bradfield Dr 2312	1920	8784	Madden, Herbert B.	C	E-5 234	Hurd, James E.	Bank supervisor, St. of NE
Bradfield Dr 2315	1920	8570	Jeary, Clark	C	E-5 252	Coats, Albert J.	physician
Bradfield Dr 2318	1920	8785	Madden, Herbert B.	C	E-5 235	Jeary, Edwin	Banker, legislator
Bradfield Dr 2324	1919	8268	Madden, Herbert B.	C	E-5 236	Stahl, Chas. C.	wholesale druggist supply
Bradfield Dr 2325	1919	7732	Cooper, John	C	E-5 251	Breunsbach, Daniel F.	insurance
Bradfield Dr 2329	1922	9871	Fullagar, William G.	C	E-5 250	Wertheimer, Gabriel L.	Sales mnger, Beatrice Creamery
Bradfield Dr 2335	1922	10026	Davis & Wilson/Fullagar, W. G.	C	E-5 249	Wilson, Walter F.	architect, Davis & Wilson
Bradfield Dr 2336	1920	8787	Madden, Herbert B.	C	E-5 237	Traphagen, Chas. V.	investments
Bradfield Dr 2345	1917	7285	Rathbone Co., Harvey	C	E-5 248	Hosburgh, Archibald J.	resident, sales co.
Bradfield Dr 2400	1924	12080	Penrod, Carl A.	C	E-5 238	Butler, Bernice C.	sales, Lord Auto
Bradfield Dr 2403	1921	9160	Madden, Herbert B.	C	E-5 247	Masterman, Clyde	sec/treas, Gooch Foods
Bradfield Dr 2408	1938	28555	Miller, A.W. Co., Inc.	C	E-5 239	Wiese, Lillian & Lydia Schwarz	
Bradfield Dr 2411	1927	16160	Alexander, John M.	C	E-5 246	Watson, Wm. W.	real estate
Bradfield Dr 2419	1918	7386	Cooper, John	C	E-5 245	Selleck, John	NU biz manager, chancellor
Bradfield Dr 2424	1927	16654	Bstandig, Ed J.	C	E-5 240	Zimmer, John F.	pres., insurance co.
Bradfield Dr 2435	1929	18898	Star Real Estate Co.	C	E-5 244	Hummel, Ray O.	physician & surgeon
Bradfield Dr 2441	1922	9875	Hanson, A.L.	C	E-5 243		
Bradfield Dr 2500	1940	33760	Lorenz, Felix A.	C	E-5 242	Weir, Edwin S.	NU instructor
Bradfield Dr 2501	1916	6784	Lorenz, Felix A.	C	E-5 82		
Bradfield Dr 2515	1925	13327	Assenmacher, W.J.	C	E-5 81	Grainger, W. B.	buyer, Grainger Bros
Bradfield Dr 2701	1939	30099	Unthank, John O./Miller, AW Co.	C	E-5 30	Peterson, John C.	physician, eye specialist
Bradfield Dr 2702	1922	10021	Blauser, C.L.E.	C	E-5 29	Blauser, C.L.E.	
Bradfield Dr 2721	1930	19346	Pierson, A. E.	C	E-5 31	Henn, Joseph L.	mngnr, Internat'l Harvester
Bradfield Dr 2724	1935	22994	Davis & Wilson	C	E-5 28	Heppner, Amanda	NU Dean of Women
Bradfield Dr 2735	1925	13361	Rathbone Carpenter Co.	C	E-5 32	Upson, Fred & Georgia	NU professor
Bradfield Dr 2745	1919	8113.5	Sheridan Park Inv. Co.	C	E-5 33	Spalding, Phineas & Blanche	F. M. Spalding Lmbr Co.
Calumet Court 2300	1925	13609	Alexander, John M.	C	E-5 255	Whitten, John C. (Vivian)	VP 1st Trust Co., pres. of School Board
Calumet Court 2311	1919	8293	Star Real Estate Co.	C	E-5 274	Beach, Allen R.	Security Mutual Life Ins.

United States Department of the Interior
National Park Service

National Register of Historic Places
Continuation Sheet

Section number 7 Page 7

Boulevards Historic District

Name of Property

Lancaster County, Nebraska

County and State

Address	BP Date	BP #	Builder/Architect	Status	NeHBS LC13:	Occupant	Occupation
Bradfield Dr 2302	1920	8786	Madden, Herbert B.	C	E-5 233	Westphal, Geo. R.	auditor, Bankers Life
Bradfield Dr 2305	1920	8569	Jeary, Clark	C	E-5 253	Jeary, Clark	Atty, mayor, legislator
Bradfield Dr 2312	1920	8784	Madden, Herbert B.	C	E-5 234	Hurd, James E.	Bank supervisor, St. of NE
Bradfield Dr 2315	1920	8570	Jeary, Clark	C	E-5 252	Coats, Albert J.	physician
Bradfield Dr 2318	1920	8785	Madden, Herbert B.	C	E-5 235	Jeary, Edwin	Banker, legislator
Bradfield Dr 2324	1919	8268	Madden, Herbert B.	C	E-5 236	Stahl, Chas. C.	wholesale druggist supply
Bradfield Dr 2325	1919	7732	Cooper, John	C	E-5 251	Breunsbach, Daniel F.	insurance Sales mngr, Beatrice Creamery
Bradfield Dr 2329	1922	9871	Fullagar, William G.	C	E-5 250	Wertheimer, Gabriel L.	architect, Davis & Wilson
Bradfield Dr 2335	1922	10026	Davis & Wilson/Fullagar, W. G.	C	E-5 249	Wilson, Walter F.	investments
Bradfield Dr 2336	1920	8787	Madden, Herbert B.	C	E-5 237	Traphagen, Chas. V.	resident, sales co.
Bradfield Dr 2345	1917	7285	Rathbone Co., Harvey	C	E-5 248	Hosburgh, Archibald J.	sales, Lord Auto
Bradfield Dr 2400	1924	12080	Penrod, Carl A.	C	E-5 238	Butler, Bernice C.	sec/treas, Gooch Foods
Bradfield Dr 2403	1921	9160	Madden, Herbert B.	C	E-5 247	Masterman, Clyde	real estate
Bradfield Dr 2408	1938	28555	Miller, A.W. Co., Inc.	C	E-5 239	Wiese, Lillian & Lydia Schwarz	NU biz manager, chancellor
Bradfield Dr 2411	1927	16160	Alexander, John M.	C	E-5 246	Watson, Wm. W.	pres., insurance co.
Bradfield Dr 2419	1918	7386	Cooper, John	C	E-5 245	Selleck, John	physician & surgeon
Bradfield Dr 2424	1927	16654	Bstandig, Ed J.	C	E-5 240	Zimmer, John F.	
Bradfield Dr 2435	1929	18898	Star Real Estate Co.	C	E-5 244	Hummel, Ray O.	
Bradfield Dr 2441	1922	9875	Hanson, A.L.	C	E-5 243		
Bradfield Dr 2500	1940	33760	Lorenz, Felix A.	C	E-5 242	Weir, Edwin S.	NU instructor
Bradfield Dr 2501	1916	6784	Lorenz, Felix A.	C	E-5 82		
Bradfield Dr 2515	1925	13327	Assenmacher, W.J.	C	E-5 81	Grainger, W. B.	buyer, Grainger Bros
Bradfield Dr 2701	1939	30099	Unthank, John O./Miller, AW Co.	C	E-5 30	Peterson, John C.	physician, eye specialist
Bradfield Dr 2702	1922	10021	Blauser, C.L.E.	C	E-5 29	Blauser, C.L.E.	
Bradfield Dr 2721	1930	19346	Pierson, A. E.	C	E-5 31	Henn, Joseph L.	mngr, Internat'l Harvester
Bradfield Dr 2724	1935	22994	Davis & Wilson	C	E-5 28	Heppner, Amanda	NU Dean of Women
Bradfield Dr 2735	1925	13361	Rathbone Carpenter Co.	C	E-5 32	Upson, Fred & Georgia	NU professor
Bradfield Dr 2745	1919	8113.5	Sheridan Park Inv. Co.	C	E-5 33	Spalding, Phineas & Blanche	F. M. Spalding Lmbr Co. VP 1st Trust Co., pres. of School Board
Calumet Court 2300	1925	13609	Alexander, John M.	C	E-5 255	Whitten, John C. (Vivian)	
Calumet Court 2311	1919	8293	Star Real Estate Co.	C	E-5 274	Beach, Allen R.	Security Mutual Life Ins.

**United States Department of the Interior
National Park Service**

**National Register of Historic Places
Continuation Sheet**

Boulevards Historic District

Name of Property

Lancaster County, Nebraska

County and State

Section number 7 Page 8

Address	BP Date	BP #	Builder/Architect	Status	NeHBS LC13:	Occupant	Occupation
Calumet Court 2312	1922	10674	Star Real Estate Co.	C	E-5 256	Rockey, Vernon F. (Cora)	Lincoln Journal-Star
Calumet Court 2316	1924	13258	Star Real Estate Co.	C	E-5 257	Erhardt, George (Josie)	Munger & Erhardt, real estate
Calumet Court 2321	1919	8292	Star Real Estate Co.	C	E-5 273	Theobald, Herbert J.	
Calumet Court 2330	1927	16162	Alexander, John M.	C	E-5 258	McMillan, Glen (Stella)	University Drug Co.
Calumet Court 2333	1919	7870	Miller, James B.	C	E-5 272	Troup, Lewis M.	lawyer, real estate, City Council
Calumet Court 2338	1922	9594	Rathbone Carpenter Co.	C	E-5 259	Decker, Leon M.	sec. & sales mngr, Queen Incubator Co.
Calumet Court 2341	1918	7391	Rathbone Co., Harvey	C	E-5 271	Deurmyer, Frank H.	pres., Duermyer Dental Lab
Calumet Court 2346	1925	14393	Rathbone Carpenter Co.	C	E-5 260	Hoppe, Albert A.	salesman, Nebr. Buick Co.
Calumet Court 2354	1922	10233	Rathbone Carpenter Co.	C	E-5 261	Chamber, Guy C.	attorney
Calumet Court 2355	1925	14803	Star Real Estate Co.	C	E-5 270	Gates, W. Edgar	
Calumet Court 2360	1926	15559	King, C. W., Const. Co.	C	E-5 262	Snyder, J. Lloyd	engineer, Western Glass & Paint Co.
Calumet Court 2402	1919	7861	Robertson, Harvey	C	E-5 263	Crannell, Edwin M.	
Calumet Court 2403	1920	8453	Miller, James B.	C	E-5 269	Smith, Glenn (Margaret)	mngr, Pioneer Const. Co.
Calumet Court 2414	1926	15560	Alexander, John M.	C	E-5 264	Hoover, Lester W.	dept. mngr, Rudge & Guenzel Dept. Store
Calumet Court 2415	1922	10138	Woods, Chas D.	C	E-5 268	Strain, Thurl B.	v.p./treas. 1st Trust Co.
Calumet Court 2418	1922	10326	Rathbone Carpenter Co.	C	E-5 265	Colburn, William O.	physician, children's specialist
Calumet Court 2419	1919	7945	Burford & Randolph	C	E-5 267	Johnson, John H. (Florence)	sec/treas. Western Brick Supply Co.
Calumet Court 2428	1924	12443	Nootz, C.A.	C	E-5 266	Jennings, Jessie G.	widow of Henry
Calvert St 2700	1978	123968	unknown	NC	E-4 254		
Calvert St 2740	1953	61697	Dietrich, Carl J.	C	E-4 255	King, O. J.	
Calvert St 2800	1941	33829	Kaiser & Steel Constr. Co.	C	E-4 285	Fitzpatrick, Walter R. (Edna)	asst mngr, Continental Oil
Calvert St 2840	1950	52141	Penton, H. M.	C	E-4 286	James, Dr. Ben	
Calvert St 2900	1983	134964	unknown	NC	E-4 320	Weaver, Art	
Calvert St 2930	1952	58071	Slothower, John R.	C	E-4 321	Polsky, Preston A.	
Calvert St 2940	1952	58072	Consolidated Constr. Co.	C	E-4 322	Slothower, J. R.	
Cedar Ave 2811	1925	14061	Rogers, Walter	C	D-4 88	Hollenbeck, Don (Jessie)	
Cedar Ave 2818	1925	14266	Rogers, Walter	C	D-4 122	Gould, Edwin G. (Onnolee)	spl agt N W Mut Life Ins Co
Cedar Ave 2828	1929	18274	Sweeney & Co.	C	D-4 123	Young, Clement W. (Florence)	pres Young Oil Co
Cedar Ave 2835	1925	14482	Dimick, N.A.	C	D-4 90	Dimick, Nelson A. (Lillian L)	contr (name also spelled "Dimich")

United States Department of the Interior
National Park Service

National Register of Historic Places
Continuation Sheet

Boulevards Historic District

Name of Property

Lancaster County, Nebraska

County and State

Section number 7 Page 9

Address	BP Date	BP #	Builder/Architect	Status	NeHBS LC13:	Occupant	Occupation
Cedar Ave 2836	1925	14716	Rogers, Walter	C	D-4 124	Baer, Edwin B. (Augusta)	mgr real est dept Guardian Mtge Sec Co
Cedar Ave 2841	1926	14983	Rogers, Walter	C	D-4 91	Steidl, Edward J. (Clara)	agt Aetna Life Ins Co
Cedar Ave 2845	1926	15298	Rogers, Walter	C	D-4 92	Caddis, Albert M. & A.H.	Albert - eng Bureau of Rds & Bridges
Cedar Ave 2850	1938	28046	Lorenz, Felix A.	C	D-4 125	Todd, Jesse W. (Ella M)	office mgr Miller & Paine Inc.
Cedar Ave 2900	1939	30481	Lorenz, Felix A.	C	D-4 132	Hatfield, Omer G. (Dora D)	rep
Cedar Ave 2909	1931	20168	Townsend, P.	C	D-4 104	Freeman, James R. (Helen)	buyer Grainer Bros Co
Cedar Ave 2910	1939	31131	Lorenz, Felix A.	C	D-4 133	Garey, Frank E. (Zorah)	dist agt Equitable Life Ins Co of Iowa
Cedar Ave 2916	1926	15957	Woods, Chas D.	C	D-4 134	McGinley, Otto J. (Eliz)	v-pres Austin Credit Co
Cedar Ave 2917	1932	20695	Hutson, Frank	C	D-4 105	Suter Jr., Robert B. (Maye B)	clk R B Suter
Cedar Ave 2920	1926	15238	Bickford, R.A.	C	D-4 135	Boomer, Ralph E. (Melba K)	The Boomers Agencies 111 S 12th
Cedar Ave 2929	1925	13803	Yetter, W.S.	C	D-4 106	Hunt, Earl R.	Piano Tuner
Cedar Ave 2930	1926	15239	Bickford, R.A./Hanna, Bob	NC	D-4 136	Titzel, Wayne L. (Getha G)	photo engr State Journal/ contemporary remoel, home of architect/artist Bob Hanna
Cedar Ave 2935	1938	28207	Lorenz, Felix A.	C	D-4 107	Foster, Frank C. (Florence)	slsmn la-Neb L&P Co
Cedar Ave 2940	1939	30389	Lorenz, Felix A.	C	D-4 137	Loosbrock, Homer N. (Edna)	sec-treas Globe Finance Co
Cedar Ave 2950	1929	18701	Rogers, Walter	C	D-4 138	Quinn, John Burnham (Louise M)	slsmn George Bros
Cedar Ave 3105	1953	61915	Chapin, Lee	C	D-4 116	Seacrest, Jay F. (Grace E)	production mgr Journal Star Printing Co
Cedar Ave 3125	1939	30350	Brown, H. A.	C	D-4 118	Rice, Mrs. Ida B. Rathburn, Winthrop G. (M Helen)	Widow William asst genl mgr Western Sup Co
Cedar Ave 3128	1939	30469	Unthank, John O.	C	D-4 175	Eicher, Clayton W. (Edith)	parts mgr DuTeau Chev Co
Cedar Ave 3131	1940	33166	Lorenz, Felix A.	C	D-4 119	Bruning, Frank G. (Sadie P)	
Cedar Ave 3140	1938	29189	Unthank, John O.	C	D-4 176	Beechner, Ralph (Frances A)	tchr Lincoln High School
Cedar Ave 3141	1937	25763	Hazen, N. Bruce	C	D-4 120	Sandall, S. Alvin (Jane)	dept. mngr, Miller & Paine
Colonial Dr 2320	1950	54117	Sandall, S. A.	C	E-5 363	Koll, Sylvis C. (Freda)	inspector, Beatrice Foods
Colonial Dr 2332	1951	56255	Pritz, Harold W.	C	E-5 364	Kos, John (Barbara)	facilities splst, Vets Admin
Colonial Dr 2340	1950	52953	Kos, John	C	E-5 365	Haas, Chas. W. (Grace)	dist supr, US Bureau Motor Carriers
Colonial Dr 2400	1952	57268	Pritz, Harold W.	C	E-5 366	Will, Albert A. (Dorothy)	Servisoft Co.
Colonial Dr 2401	1951	54496	Vakoe, Robt. L.	C	E-5 361	Dean, Geo. W. (Mary)	physician
Colonial Dr 2409	1950	53988	Card-Adams Co.	C	E-5 360		

United States Department of the Interior
National Park Service

National Register of Historic Places
Continuation Sheet

Section number 7 Page 10

Boulevards Historic District

Name of Property

Lancaster County, Nebraska

County and State

Address	BP Date	BP #	Builder/Architect	Status	NeHBS LC13:	Occupant	Occupation
Colonial Dr 2412	1951	54339	Strauss, James	C	E-5 367	Strumpler, Erwin A. (Bernice)	Elgin Watch Co.
Colonial Dr 2415	1950	53912	Card-Adams Co.	C	E-5 359	Scheitel, Homer P. (Esther)	
Colonial Dr 2424	1949	50691	Witt & Juckette	C	E-5 368	Roberts, Myron J. (Virginia)	assoc. prof, U of N
Colonial Dr 2425	1951	54340	Strauss, James	C	E-5 358	Bitler, Roy	mngnr, Pyramid Insurance
Colonial Dr 2430	1951	56426	Vogel, Edw. F	C	E-5 369	Vavrick, Frank (Josephine)	mechanical engineer
Colonial Dr 2435	1951	56717	Schmidt, Herman	C	E-5 357	Diers, Wm. H. (Marjorie)	chairman, St. Bd of Control
Colonial Dr 2444	1951	57137	Vogel, Edw. F	C	E-5 370	Fenton, Robert B. (Harriet)	salesman, Dietz Music
Colonial Dr 2452	1954	62517	Arnold, Howard F.	C	E-5 371		
Colonial Dr 2600	1940	31780	Rathbone, Harvey	C	E-5 386	Lincoln Housing Co./Stein, Carl	spec agt, Equitable Life
Colonial Dr 2610	1946	42196	Anderson, M. W.	C	E-5 387	Hyland, Paul W. (Jean)	Landy Clark Co. (lumber)
Colonial Dr 2626	1949	49901	Hanson, Ernest E.	C	E-5 388	Hanson, Ernest E. (Nettie)	mason
Colonial Dr 2640	1947	44128	Anderson, M. W.	C	E-5 389	Hurlbut, Lloyd W. (Margaret)	prof. & dept. chair, ag engineering, U of Nebr.
Colonial Dr 2646	1950	54099	Card-Adams Co.	C	E-5 390	Carlson, Alvie A. (Barbara)	salesman unit head, FSA; medical secretary
Colonial Dr 2650	1940	32020	Lincoln Housing Co.	C	E-5 391	Lawson, Jack & Dorothy	
Colonial Dr 2656	1954	63052	Anderson, M. W.	C	E-5 392		
Colonial Dr 2666	1946	43272	Sweeney-Solheim Co.	C	E-5 393	Brown, John A. III (Gladys)	physician
Colonial Dr 2667	1941	337878	Coolidge, John D.	C	E-5 424	Coolidge, John D. (Betty)	asst mngnr, Miller & Paine
Colonial Dr 2675	1941	35579	Beal, Henry	C	E-5 423	Bruce, Gilbert L. (Kath M)	salesman, Lincoln Steel
Colonial Dr 2676	1947	46438	Sweeney-Solheim Co.	C	E-5 394	Prudhon, Dale L. (Bess)	inspector
Colonial Dr 2690	1946	42357	Anderson, M. W.	C	E-5 395	Hermanson, Edw. C. (Ethelyn)	ofc sec, First Trust Co.
Colonial Dr 2696	1940	32392	Harper, Philip	C	E-5 396	Harper, Philip (Fern)	airport engineer estimator, Assenmacher Constr. Co.
Colonial Dr 2702	1946	43150	Pierson, A. E.	C	E-5 397	Edgren, Robert (Barbara)	
Eastgate 2700	1959	74255	Chapin, Lee	NC	E-4 133		
Eastgate 2740	1970	97880	Chapin, Lee	NC	E-4 132		
Eastgate 2745	1922	10476	Hansen, Peter	C	E-4 131		
Garden Rd 2470	1956	68756	Aitken, Martin/Dietrick, Carl J.	C	D-5 483	Hoppe, John	
Garden Rd 2490	1954	63832	Aitken, Martin/Fullagar, Walt	C	D-5 484	McGreer, John	physician widow of Aaron of Lincoln Drug Co.
Georgian Court 2900	1926	15624	Randolph, Theo	C	E-4 51	Raymond, Dorothy	
Georgian Court 2904	1936	25560	Petersen, Ervin E.	C	E-4 50	Lingenfelder, Fred (Hazel)	postal clerk
Georgian Court 2905	1926	14930	Dennis, Charles	C	E-4 55	Ford, Roy (Ethel)	attorney

**United States Department of the Interior
National Park Service**

**National Register of Historic Places
Continuation Sheet**

Boulevards Historic District

Name of Property

Lancaster County, Nebraska

County and State

Section number 7 Page 11

Address	BP Date	BP #	Builder/Architect	Status	NeHBS LC13:	Occupant	Occupation
Georgian Court 2908	1927	16642	Alexander, John M.	C	E-4 49	Thomas, Jasper (Ruth)	physician
Georgian Court 2914	1925	14902	Alexander, John M.	C	E-4 48	Todd, Jesse (Ella)	Miller & Paine office mgr
Georgian Court 2915	1926	No BP	Unknown	C	E-4 56	Hopper, Ernest	professor of agriculture
Georgian Court 2922	1929	19224	Bstandig, Ed J.	C	E-4 47	Plank, Neil (Olive)	ins pector, U. S. Bureau of Animal Husbandry
Georgian Court 2929	1937	27057	Smith, Linus B./Lorenz, Felix A.	C	E-4 57	Smith, Linus Burr	UNL professor of architecture
Georgian Court 2930	1932	20782	Bstandig, Ed J.	C	E-4 46	Camp, Chester (Marie)	UNL math professor
Georgian Court 2935	1925	14852	Rathbone Carpenter Co.	C	E-4 58	Martins, Lederle (Mercedes)	mngr, State Oil Co.
Georgian Court 2940	1931	20149	Bstandig, Ed J.	C	E-4 45	Breed, Frank (Carol)	vet. medicine, Norden Labs
Georgian Court 2945	1936	24747	Kaiser, John H.	C	E-4 59	Devoe, Ivan (Della)	insurance
Georgian Court 3000	1926	15333	Rathbone Carpenter Co.	C	E-4 44	Potter, Cedric (Mildred)	investments
Georgian Court 3001	1927	16172	Rathbone Carpenter Co.	C	E-4 60	Geddes, Earl (Pearl)	insurance
Georgian Court 3017	1926	16086	Rathbone Carpenter Co.	C	E-4 61		
Georgian Court 3024	1927	16799	Robey, Frank A.	C	E-4 43	Johnson, Albert S.	attorney
Georgian Court 3028	1925	14909	Rathbone Carpenter Co.	C	E-4 42	Hellmers, Chas. (Estelle)	District manager, Central Electric & Gas
Georgian Court 3033	1935	22630	Anderson, A. O. & Sons	C	E-4 62		
Georgian Court 3040	1926	15790	Rathbone Carpenter Co.	C	E-4 41	Corey, Orville (Ethel)	Corey Fuel & Oil Co.
Georgian Court 3045	1927	16977	Joy, George C.	C	E-4 63		
Harrison Ave 2001	1929	19244	Burr, Edwin H.	C	D-5 640	Scholkopf, W.	
Harrison Ave 2009	1940	33389	Solheim, S. A./Sweeney Const.	C	D-5 639	Slavik, V. J.	
Harrison Ave 2010	1927	17127	Bstandig, Ed J.	C	D-5 642	Keith, George & Marie	swtichbd installer,LT&T
Harrison Ave 2015	1924	12403	Wall, James D.	C	D-5 638	Hosford, L. R./Sharp, Fred (Clara)	cashier, Eiche Floral Co.
Harrison Ave 2020	1924	12747	Reed, W	NC	D-5 643	Russ Raybould	major remodeling
Harrison Ave 2025	1946	no permit	unknown	C	D-5 637		
Harrison Ave 2034	1950	53598	Cornell & Sampson	C	D-5 644	Sweeney, Tom	
Harrison Ave 2035	1926	15582	Sinkola, J.	C	D-5 636	Svoboda, F. L./Snyder, Mrs. Effie	widow John Snyder
Harrison Ave 2040	1926	15083	Decker, H. M.	C	D-5 645	Potter, Earl H. (Abigail)	Midwest Life
Harrison Ave 2045	1923	11709	Maycod, C. H.	C	D-5 635	Atkinson, C. E./McDonald, Laurel (Irene)	McD: mng, Frey & Frey
Harrison Ave 2100	1939	30201	Petersen, Ervin E.	C	D-5 646	Collins, Wilkie Jr. (Alice)	agronomist
Harrison Ave 2103	1923	11348	Deffenbaugh, J. L.	C	D-5 634	Newbert, George (Bertha)	baker

United States Department of the Interior
National Park Service

National Register of Historic Places
Continuation Sheet

Boulevards Historic District

Name of Property

Lancaster County, Nebraska

County and State

Section number 7 Page 12

Address	BP Date	BP #	Builder/Architect	Status	NeHBS LC13:	Occupant	Occupation
Harrison Ave 2109	1925	14058	Bickford, R. A.	C	D-5 633	Wilmeth, Ossie (Hettie)	physician
Harrison Ave 2112	1928	18110	Christian, Mary (remodel)	C	D-5 647	Christian, George (Mary)	Geo. M Christian Realty
Harrison Ave 2118	1947	46147	Jensen, Deane L.	C	D-5 648	Jensen, Deane L.	
Harrison Ave 2119	1927	16775	Decker, H. M.	C	D-5 632	West, Robert D. (Eleanor)	salesman
Harrison Ave 2126	1922	10151	Copeland, P. L.	C	D-5 649	Edgar, Foster D. (Sadie)	
Harrison Ave 2127	1922	10688	Stewart, Owen P.	C	D-5 631	Long, Paul (Ethel)	statistician, Neb. State Journal
Harrison Ave 2141	1924	12209	Fiske & Meginnis	C	D-5 630	Gillen, Frank R. (Tillie)	vp, Gillen&Boney (candy)
Harrison Ave 2144	1937	25903	Bstandig, Ed J.	C	D-5 650	Keitges, Waldo S. (Mary)	sec-treas Midwest Lumbermans Inter-insurance Exchange
Harrison Ave 2201	1925	13932	Hanson, Paul G.	C	D-5 529	Levy, Martin & Cecile	pres., Neb. Printing Co.
Harrison Ave 2211	1925	14790	Robey, Frank A.	C	D-5 530	Steckley, Edwin & Grace	buyer, Miller & Paine
Harrison Ave 2220	1923	11130	Rische, Albert E.	C	D-5 527	Van Gorkham, Geo & Frances	Remington Typewriter Co.
Harrison Ave 2230	1925	14063	Robey, Frank A.	C	D-5 526	Meier, Louis & Hazel	Dentist
Harrison Ave 2235	1921	9331	Fullagar, William G.	C	D-5 531	Houtz, Fred & Hollie	investments
Harrison Ave 2240	1920	8366	Fullagar, William G.	C	D-5 525	Schmittel, Leo/Turner, Geo.	LS: 1st Nat'l Bank; GT: Nebr. Supreme Ct Clerk 1927-76
Harrison Ave 2244	1923	11203	Hanson, Paul G.	C	D-5 524	Guenzel, Carl J.	Rudge & Guenzel Dept. store son of Carl J.; Rudge & Guenzel, VP 1st Nat'l Bk
Harrison Ave 2245	1924	13132	Craig, Fritz	C	D-5 532	Guenzel, Ernest U.	owner, C.S.Guenzel Co., sheet metal
Harrison Ave 2300	1924	12339	Robey, Frank A.	C	D-5 523	Guenzel, Carl S.	
Harrison Ave 2303	1923	11182	Hanson, A.L.	C	D-5 533	Hoppe, Wm. F. & Gertrude	W. F. Hoppe Lumber Co.
Harrison Ave 2312	1921	9314	Roberts, G.H.	C	D-5 522	Schaeffer, H. J./Butler, John M.	Scheffer: Mary Jane Garment Co.; Butler: served 51 yrs as RR mail clerk
High 2620	1939	29235	Unthank, John O.	C	D-4 177	Schneider, James H. (Cecile B)	ofc mge O'Shea-Rogers Motor Co
High 2628	1940	32931	Unthank, John O.	C	D-4 178	Dawley, Charles C. (Georgia L)	autos 116 S 16th
High 2636	1937	25862	Bstandig, Ed J.	C	D-4 179	Chase, Fred M	sec Chase Plow Co
High 2648	1939	31406	Hazen, N. Bruce	C	D-4 180	Junge, Carl L. (Lucille N)	asst genl mgr Neb Salesbook
High 2658	1952	57350	Hock Jr., Adolf	C	D-4 181	Hoyt, C. Edward (Helen)	director State Dept of Agri
High 2666	1952	57352	Hock Jr., Adolf	C	D-4 182	McCabe, Leo B. (Lydia A)	Cornhusker Tile & Marble Co
Jackson Dr 2724	1949	51319	Kessler, Clarence E.	C	E-4 114		
Jackson Dr 2736	1932	20727	Davis & Wilson	C	E-4 113	Wilson, Helen	teacher, Lincoln High Sch.

United States Department of the Interior
National Park Service

National Register of Historic Places
Continuation Sheet

Section number 7 Page 13

Boulevards Historic District

Name of Property

Lancaster County, Nebraska

County and State

Address	BP Date	BP #	Builder/Architect	Status	NeHBS LC13:	Occupant	Occupation
Jackson Dr 2741	1938	28587	Anderson, A. O. & Sons	C	E-4 101	Schmelkin, Philip (Ruth)	Philip: dept. manager, Ruth, NU Panhellenic advisor
Jackson Dr 2744	1927	17078	Randolph, Theo	C	E-4 112	Weaver, Louis W. (Sr.)	Lanc. County engineer
Jackson Dr 2745	1937	25932	Miller, A.W. Co., Inc.	C	E-4 102	Moyle, John (Mildred)	salesman
Jackson Dr 2800	1937	26707	Lorenz, Felix A.	C	E-4 111	Osborn, Ray (Fay)	VP, gen mng, Sullivan Transfer & Storage Co.
Jackson Dr 2808	1927	17160	Baker & Holder	C	E-4 110	White, Walter (Frances)	advertising mng, Star Printing
Jackson Dr 2809	1937	25864	Petersen, Ervin E.	C	E-4 103	Sandlovich, Samuel (Louise)	Nebr. Motor Co.
Jackson Dr 2820	1939	29625	Johnson, Leonard	C	E-4 109	Johnson, Leonard (Emma)	Leonard: Real estate; Emma: teacher
Jackson Dr 2821	1927	16894	Bstandig, Ed J.	C	E-4 104	Robinson, Edward (Mabel)	salesman, Grainger Bros. purchasing agent, Woods Bros. Co.
Jackson Dr 2828	1926	15246	McGuire, A.	C	E-4 108	Kurtz, Albert (Helen) tenants	Locke: athlete, attorney; Chappell: NE Supreme Ct Justice
Jackson Dr 2829	1928	17590	Alexander, John M.	C	E-4 105	Locke, Roland "Gipp"/Chappell, Ellwood	
Jackson Dr 2835	1950	53125	Kessler, Clarence E.	C	E-4 106		
Jackson Dr 2838	1930	19553	Lowell, E.L.	C	E-4 107	Latman, Louis (Edith)	real estate
Jackson Dr 2900	1929	18530	Anderson, F.A.	C	E-4 74	Johnson, Mrs. Lena	widow Dr. Czar Johnson
Jackson Dr 2901	1936	24750	Pierson, A. E.	C	E-4 75	Housh, Roy (Bettie)	dept mng, Golds & Co.
Jackson Dr 2911	1927	17012	Bstandig, Ed J.	C	E-4 76	Urbach, Henry (Christine)	superintendent motive power, CB&Q RR
Jackson Dr 2912	1927	18461	Vorhees, M.E.	C	E-4 73	Chaloupka, Adelmarr (Beulah)	dentist
Jackson Dr 2924	1928	18206	Alexander, John M.	C	E-4 72		
Jackson Dr 2925	1935	23258	Sweeney & Co.	C	E-4 77	Burt, Lloyd (Ruth)	vp, Geo. F. Burt & Co., wholesale fruit
Jackson Dr 2930	1930	19490	Bstandig, Ed J.	C	E-4 71	Batley, C. Wheaton	pres., Cont'l Nat'l Bank co-founders, People's Accident Insur. Co.
Jackson Dr 2933	1933	21099	Hazen, N. Bruce/Larsen, Carl	C	E-4 78	VanVliet, Cedric & Annagrace	
Jackson Dr 2940	1927	17109	Bstandig, Ed J.	C	E-4 70	Bennett, John (May)	dentist
Jackson Dr 2941	1928	17509	Decker, H.M.	C	E-4 79	Bigford, Clara & Pinney, Mrs. Ruth	Pinney--teacher, Whittier & Lincoln HS
Jackson Dr 3000	1927	16267	Rathbone Carpenter Co.	C	E-4 69	DeVriendt, Camille (Maude)	pres., Capital Engraving Co.
Jackson Dr 3001	1927	17177	Decker, H.M.	C	E-4 80	Kerns, Norman (Kathryn)	district freight agt, CB&Q RR
Jackson Dr 3009	1927	16590	Larsen, C.M.	C	E-4 81	Davis, Arthur (Elizabeth)	pres., Extruded Sash Co.
Jackson Dr 3010	1938	29013	Hazen, N. Bruce	C	E-4 68	DeVriendt, Willis (DeZera)	advertising
Jackson Dr 3018	1928	17469	Pierson, A. E.	C	E-4 67	Hitchcock, Ralph (Valeria)	mng, Stewart Motor Co.

**United States Department of the Interior
National Park Service**

**National Register of Historic Places
Continuation Sheet**

Boulevards Historic District

Name of Property

Lancaster County, Nebraska

County and State

Section number 7 Page 14

Address	BP Date	BP #	Builder/Architect	Status	NeHBS LC13:	Occupant	Occupation
Jackson Dr 3019	1929	18284	Star Real Estate Co.	C	E-4 82	Potter, Herbert (Blanche)	sec/treas LT&T Co.
Jackson Dr 3030	1930	19554	Lowell, E.L.	C	E-4 66	Bemis, Albert (Vera)	Lafayette Life Insurance
Jackson Dr 3033	1938	27104	Miller, A.W. Co., Inc.	C	E-4 83	Stover, Willis (Frances)	Internat'l Harvester
Jackson Dr 3038	1925	14731	Rathbone Carpenter Co.	C	E-4 65	Stoll, Carl (Myrtle)	Chief, Receivership Div., State Dept. of Trade & Commerce
Jefferson Ave 2808	1918	7580	Jacobs, H.	C	E-5 290	Grubb, Ralph C.	salesman
Jefferson Ave 2812	1921	8958	Hanson, Paul G.	C	E-5 291	Dalton, William H.	
Jefferson Ave 2816	1918	7581	Jacobs, H.	C	E-5 292	Wertheimer, Gabriel	dept. mng'r, Beatrice Creamery
Jefferson Ave 2832	1921	9547	Rathbone Carpenter Co.	C	E-5 293	Sellek, John K.	NU biz mng'r, Chancellor
Lafayette 2430	1925	13396	Miller & Craig	C	D-4 25	Barber, Oril A. (Iva)	Prop A B A Independent Oil & Gasoline Co
Lafayette 2500	1939	30784	Farrens, Bill	C	D-4 76	Doty, Ralph H. (Elsie)	supt of agts Lincoln Liberty Life Ins Co
Lafayette 2501	1927	16363	Lindblad, Axel L.	C	D-4 93	Green, Horace G. (Elnora)	
Lafayette 2510	1938	29174	Petersen, Ervin E.	C	D-4 77	Lymes, E. Hal (Mildred M)	assoc Van Boskirk-Reminton & Associates
Lafayette 2525	1926	15312	Kingery Construction Co.	C	D-4 101	Wickstrum, Parker M. (Julia)	Wickstrum Auto Exch
Lafayette 2526	1942	35873	Rush, Clyde D.	C	D-4 78	Tedrick, Raymond E. (Ruth)	dept mgr Fredrich Bros
Lafayette 2535	1938	27499	Pierson, A. E.	C	D-4 102	Eno Jr., Delwin G. (Maxine M)	clk Safeway Stores Inc
Lafayette 2536	1931	20307	Sweeney & Co.	C	D-4 79	Pierce, Harry G. (Helen)	mng'r Gelhaars Clnrs
Lafayette 2540	1925	13405	Robey, Frank A.	C	D-4 80	Gregory, Warner (Pearl F)	slsmn Woods Bros Corp traffic mgr Gooch Mill & Elev Co
Lafayette 2544	1931	20313	Rush, Clyde D.	C	D-4 81	Becquet, Louis J. (Myrtle)	
Lafayette 2545	1927	16720	Collinsworth, W.C.	C	D-4 103	Gilligan, John F. (Mary A)	slsmn
Lafayette 2600	1937	25995	Kaiser, John H.	C	D-4 126	Hazen, N. Bruce (Sidna S)	archt 226 Stuart bldg
Lafayette 2601	1939	29297	Hazen, N. Bruce/Fullagar, W. G.	C	D-4 151	Miles, Clarence G. (Elsie C.)	lawyer, mayor 1947-50
Lafayette 2612	1928	17395	Alexander, John M.	C	D-4 127	Soukup, Mrs. Emma	Widow Frank G.
Lafayette 2620	1928	17550	Star Real Estate Co.	C	D-4 128	Eckery, Thomas J. (Agnes J)	bkpr Sullivan Transfer & Storage Co
Lake Street 2003	1928	17337	Decker, H. M.	C	D-5 436	Magee, Walter J.	
Lake Street 2009	1923	11057	Fullagar, William G.	C	D-5 437	Gillen, Ronald	
Lake Street 2019	1925	13913	Bstandig, Ed J.	C	D-5 438	Schilling, Charles F.	contractor
Lake Street 2025	1948	48340	Wilsam, Charles A.	C	D-5 439	Glynn, J. P.	
Lake Street 2035	1929	18693	Bstandig, Ed J.	C	D-5 440	Phillips, Floyd A.	

United States Department of the Interior
National Park Service

National Register of Historic Places
Continuation Sheet

Boulevards Historic District

Name of Property

Lancaster County, Nebraska

County and State

Section number 7 Page 15

Address	BP Date	BP #	Builder/Architect	Status	NeHBS LC13:	Occupant	Occupation
Lake Street 2041	1934	21650	Mathews/Larson, Paul	C	D-5 441	Rouse, F. V.	
Lake Street 2101	1925	13788	Lampshire, John	C	D-5 442	Yoder, Byron E.	
Lake Street 2109	1926	15289	Bstandig, Ed J.	C	D-5 443	Hamilton, Bryan J.	
Lake Street 2119	1925	13669	Star Real Estate Co.	C	D-5 444	Kiker, Roy E.	
Lake Street 2127	1930	19581	Mehuron, John L.	C	D-5 445	McLaughlin, Nellie	
Lake Street 2135	1923	10741	Ridgway, George	C	D-5 446	Hanna, R. J.	
Lake Street 2143	1922	10441	Ridgway, George	C	D-5 447	Snowden, John M.	
Lake Street 2201	1928	17749	Alexander, John M.	C	D-5 448	Fuchs, Gustave	
Lake Street 2207	1940	32301	Seaton, G. O.	C	D-5 449	Keens, Albert	interior designer
Lake Street 2215	1940	32390	Lorenz, Felix A.	C	D-5 450	Grant, James R.	salesman, Korskmeier Plumbing
Lake Street 2225	1924	13182	Bstandig, Ed J.	C	D-5 451	Beuthuer, J. C.	
Lake Street 2235	1950	52140	Penton, H. M.	C	D-5 452	Cosier, Harold K.	
Lake Street 2301	1924	12568	Fiske, F. C./Tobin, Geo.	C	D-5 453	Flansburg, Harry E.	physician & surgeon
Lake Street 2400	1921	9136	Parks, William N.	C	D-5 372		
Lake Street 2418	1923	10884	Stewart, Don W.	C	D-5 371		
Lake Street 2430	1923	10902	Fiske & Meginnis	C	D-5 370		
Lake Street 2435	1918	7565	Fullagar, William G.	C	D-5 478	Elwell, Edgar W. (Myrtie)	real estate
Lake Street 2438	1925	13984	Alexander, John M.	C	D-5 369		
Lake Street 2450	1926	15010	Hanson, Paul G.	C	D-5 368		
Lake Street 2458	1921	9050	Fullagar, William G.	C	D-5 367		
Lake Street 2466	1919	7996	Ryman, C.W.	C	D-5 366		
Lake Street 2472	1916	6547	Larsen, L. J.	C	D-5 365		
Lake Street 2475	1921	9557	McArthur, Joseph G./B.J.Jobst Bldg Co.	C	D-5 471	Woods, Thos. C.	pres., LT&T Co.
Lake Street 2480	1924	12236	Olson Construction Co.	C	D-5 364		
Lake Street 2620	1924	12387	Fullagar, William G.	C	D-5 506	Pothast, Edw. & Mary M.	banker
Lake Street 2636	1926	15352	Douthett, D.M.	C	D-5 505	Pegler, Edmund & Lenora	vp Pegler-McEachen Co.
Lake Street 2640-46	1929	19071	Irvine, Frank	C	D-5 504	Stephens, D. V. & Paige, F. G.	built as 4 dwellings
Manse Ave 2700	1939	29959	Hazen, N. Bruce/Robey, Frank A.	C	E-5 24	McArthur, Harry E.	pres., Nebr. Typewriter Co.
Manse Ave 2701	1940	33199	Petersen, Ervin E.	C	E-5 25	Cather, Elsie M.	Linc. HS English teacher
Manse Ave 2712	1926	15056	Fullagar, William G.	C	E-5 23	Lauer, Paul D.	Lincoln Paint & Color

United States Department of the Interior
National Park Service

National Register of Historic Places
Continuation Sheet

Boulevards Historic District

Name of Property

Lancaster County, Nebraska

County and State

Section number 7 Page 16

Address	BP Date	BP #	Builder/Architect	Status	NeHBS LC13:	Occupant	Occupation
Manse Ave 2720	1925	14157	Alexander, John M.	C	E-5 22	Doyle, Eliza R.	widow of atty Thos Doyle
Manse Ave 2727	1920	8643	Ewing, Wesley	C	E-5 26	DuTeau, Alfred A.	auto dealer, city council
Manse Ave 2730	1925	14165	Rathbone Carpenter Co.	C	E-5 21	Senning, John Peter	NU prof, political sci.
Manse Ave 2740	1926	15332	Rathbone Carpenter Co.	C	E-5 20	Porter, Elsie & Esteline	Elsie P was Prescott teacher
Manse Ave 2745	1935	22214	Hazen, N. Bruce	C	E-5 27	Mallory, Robt. & Lois	mngnr, NE Inspection Bureau
Manse Ave 2752	1938	27398	Sweeney Construction Co.	C	E-5 19	Larsen, Villette	cashier, State Securities
Manse Ave 2800	1927	16647	Miller & Craig/Fullagar, WG	C	E-5 18	Shaw, O. J. & Edith	Shaw Oil Co.
Manse Ave 2801	1925	13839	Assenmacher, Phil	C	E-5 34	Assenmacher, Phil & Elsa	Assenmacher Constructn
Manse Ave 2825	1925	14663	Miller & Craig/Nootz, C.A>	C	E-5 35	Strader, Chas & Nellie	pres, Neon Sign Co.
Manse Ave 2832	1923	10809	Star Real Estate Co.	C	E-5 17	Lahr, Albert L.	Lahr Hardware Co.
Manse Ave 2835	1953	59901	Moser, Melvin Dale	C	E-5 36	Burke, W. J.	
Manse Ave 2840	1926	15939	Alexander, John M.	C	E-5 16	Voight, Fred H.	Voight Meat Market
Manse Ave 2845	1924	12456	Rathbone Carpenter Co.	C	E-5 37	Letton, Harry P.	engineer
Manse Ave 2850	1927	16517	Fullagar, William G.	C	E-5 15	Easterday, Fred R.	sec, 1st Trust Co.
Manse Ave 2860	1925	14041	Hirsch, O.C.	C	E-5 14	Forsyth, Evald & Gladys	pres, 1st Fed Svng & Loan
Manse Ave 2870	1927	16431	Meginnis & Schaumberg/ Randolph, Theo	C	E-5 13	Strain, Thurl B.	banker
Mayflower Ave 3100	1941	34691	Terry, Robert	C	E-5 461	Terry, Robert (Susan)	salesman
Mayflower Ave 3112	1940	32875	Bentley, John S.	C	E-5 462	Bentley, John S. (Ethel)	sports ed., State Journal
Mayflower Ave 3119	1949	50849	Card-Adams Co.	C	E-5 430		
Mayflower Ave 3120	1944	39911	Sweeney-Solheim Co.	C	E-5 434		
Mayflower Ave 3130	1948	47700	Strough, Rufus	C	E-5 435		
Mayflower Ave 3135	1941	33967	Rathbone, Harvey	C	E-5 429	Jones, Thaddeus (Ruth L.)	USArmy
Mayflower Ave 3140	1946	41735	Sweeney-Solheim Co.	C	E-5 436		
Mayflower Ave 3145	1939	31444	Rathbone, Harvey	C	E-5 428	Lincoln Housing Co./Robinson, Marvin (Peggy)	instructor, U of NE
Mayflower Ave 3150	1946	42875	Sweeney-Solheim Co.	C	E-5 437		
Mayflower Ave 3155	1944	39912	Sweeney-Solheim Co.	C	E-5 427		
Mayflower Ave 3165	1940	33752	Rathbone, Harvey	C	E-5 426	Lincoln Housing Co.	
Mayflower Ave 3171	1944	39913	Sweeney-Solheim Co.	C	E-5 425		
Mayflower Ave 3176	1946	42707	Rosenthal, Don	C	E-5 438		
Park Ave 2400	1915	5884	Campbell, A.	C	D-5 265		

United States Department of the Interior
National Park Service

National Register of Historic Places
Continuation Sheet

Boulevards Historic District

Name of Property

Lancaster County, Nebraska

County and State

Section number 7 Page 17

Address	BP Date	BP #	Builder/Architect	Status	NeHBS LC13:	Occupant	Occupation
Park Ave 2401	1922	10085	Hillgraves, H.P.	C	D-5 355		
Park Ave 2410	1920	8740	Lyman, B.F.	C	D-5 264		
Park Ave 2419	1921	9255	Buchuberg, Alfred	C	D-5 356		
Park Ave 2420	1921	9491	Truebuilt Const. Co.	C	D-5 263		
Park Ave 2426	1916	6596	Unthank, George R.	C	D-5 262		
Park Ave 2427	1922	10182	Gaddis, E.W.	C	D-5 357		
Park Ave 2434	1920	8804	Bredenberg, Alfred	C	D-5 261		
Park Ave 2435	1922	10339	Grubb, W.G.	C	D-5 358		
Park Ave 2444	1915	5901	Gehrke, Ed A.	C	D-5 260		
Park Ave 2445	1935	23459	Henderson, Martin L.	C	D-5 359		
Park Ave 2451	1916	6701	NE Building & Investment Co.	C	D-5 360	Sorensen, C. A.	attorney
Park Ave 2456	1919	8046	Saues, Aliec	C	D-5 259		
Park Ave 2459	1923	10964	Wilkinson, D.E.	C	D-5 361		
Park Ave 2466	1914	5482	Parks, William N.	C	D-5 258		
Park Ave 2467	1915	5846	Rathbone Co., Harvey	C	D-5 362		
Park Ave 2474	1916	6480	Cordner, J.G.	C	D-5 257		
Park Ave 2475	1927	16657	Rogers, Bert	C	D-5 363		
Park Ave 2626	1926	16093	Alexander, John M.	C	D-5 603	Ingham, Frances & Laura	
Park Ave 2627	1924	13056	Koop, A.H.	C	D-5 604	Koop, Amel H.	
Park Ave 2634	1923	11895	Lindblad, Axel L.	C	D-5 602	Leabman, Max (Ruth)	clothing store, 914 P
Park Ave 2640	1926	15627	Alexander, John M.	C	D-5 601	Hinman, William H.	roofing contractor
Park Ave 2641	1923	11453	Fullagar, William G.	C	D-5 605	Devoe, Ivan ('27-36); Nihon, John T. (1936-81)	Devoe, insurance; Nihon, Calculating Mach.
Park Ave 2652	1925	13479	Alexander, John M.	C	D-5 600	Pieper, William	window shade mfact'r
Park Ave 2653	1924	12554	Penrod, Carl A.	C	D-5 606	Paige, Francis G.	clerk, Woods Bros. Corp.
Park Ave 2660	1925	14611	Alexander, John M.	C	D-5 599	Van Doran, Eugene A.	photographer
Park Ave 2663	1934	21638	Lorenz, Felix A.	C	D-5 607	Kahoa, Evelyn & Johnson, Bertha	Kahoa--elem. sch. principal
Plymouth Ave 2906	1924	12132	Hollenbeck, J.B.	C	E-5 241		
Plymouth Ave 2926	1925	14143	Klinker, John	C	E-5 163		
Plymouth Ave 2927	1935	23383	Hinman Bros. Inc.	C	E-5 145		
Plymouth Ave 2937	1952	57600	Mansfield, Wayland & Alice	C	E-5 323	Mansfield, Wayland & Alice	asst sec., Woodman Accident Life

**United States Department of the Interior
National Park Service**

**National Register of Historic Places
Continuation Sheet**

Boulevards Historic District

Name of Property

Lancaster County, Nebraska

County and State

Section number 7 Page 18

Address	BP Date	BP #	Builder/Architect	Status	NeHBS LC13:	Occupant	Occupation
Plymouth Ave 2938	1919	8041	Woods, Chas D.	C	E-5 162		
Plymouth Ave 2942	1919	7866	Madden, Herbert B.	C	E-5 161		
Plymouth Ave 2949	1919	7894	Burford & Randolph	C	E-5 146		
Plymouth Ave 2952	1919	8154	Fullagar, William G.	C	E-5 160		
Plymouth Ave 2957	1917	7072	Rathbone, S.H.	C	E-5 147		
Plymouth Ave 2958	1916	6839	Keller, Jesse	C	E-5 159		
Plymouth Ave 3001	1927	16266	Rathbone Carpenter Co.	C	E-5 148		
Plymouth Ave 3002	1919	8177	Sheridan Park Inv. Co.	C	E-5 158		
Plymouth Ave 3010	1920	8514	Madden, Herbert B.	C	E-5 157		
Plymouth Ave 3015	1925	14181	Bstandig, Ed J.	C	E-5 149		
Plymouth Ave 3018	1919	8141	Madden, Herbert B.	C	E-5 156		
Plymouth Ave 3019	1922	10579	Grubb, W.G.	C	E-5 150		
Plymouth Ave 3024	1927	16399	Chambers, Oscar Y.	C	E-5 155		
Plymouth Ave 3027	1922	10280	Rathbone Co., Harvey	C	E-5 151		
Plymouth Ave 3032	1924	13168	Rathbone Carpenter Co.	C	E-5 154		
Plymouth Ave 3035	1941	34198	Solheim, Selmer A.	C	E-5 152	Zelen, Max (Celia)	asst dist. mngr, John Hancock Life Insur.
Plymouth Ave 3100	1925	14112	Davis & Wilson	C	E-5 153	Sheridan Elementary School	
Plymouth Ave 3140	1951	54367	Howard, H. W.	C	E-5 345		
Plymouth Ave 3200	1953	60802	Bartlett, Ray L.	C	E-5 353		
Plymouth Ave 3210	1948	48609	Fiene, Oscar	C	E-5 354		
Plymouth Ave 3211	1951	54866	Schmidt, Herman	C	E-5 377		
Plymouth Ave 3219	1952	58640	Wehrli, Glen C.	C	E-5 376		
Plymouth Ave 3220	1951	no permit	unknown	C	E-5 355		
Plymouth Ave 3229	1948	48155	Finke, L. M.	C	E-5 375		
Plymouth Ave 3230	1956	68066	Schubbach, Paul	C	E-5 356		
Plymouth Ave 3235	1948	48407	Fiene, Oscar	C	E-5 374		
Plymouth Ave 3249	1951	54867	Schmidt, Herman	C	E-5 373		
Plymouth Ave 3255	1953	60036	Schubbach, Paul	C	E-5 372		
Puritan Ave 3014	1927	16156	Alexander, John M.	C	E-5 144		
Puritan Ave 3026	1917	7031	Cooper, John	C	E-5 143		

**United States Department of the Interior
National Park Service**

**National Register of Historic Places
Continuation Sheet**

Boulevards Historic District

Name of Property

Lancaster County, Nebraska

County and State

Section number 7 Page 19

Address	BP Date	BP #	Builder/Architect	Status	NeHBS LC13:	Occupant	Occupation
Puritan Ave 3028	1920	8370	Madden, Herbert B.	C	E-5 142		
Puritan Ave 3040	1926	15016	Bstandig, Ed J.	C	E-5 141		
Puritan Ave 3045	1923	11977	Rathbone Carpenter Co.	C	E-5 137		
Puritan Ave 3050	1926	15196	Rathbone Carpenter Co.	C	E-5 139		
Puritan Ave 3064	1924	12119	Rathbone Co., Harvey	C	E-5 138		
Puritan Ave 3100	1941	34653	Rathbone Co., Harvey	C	E-5 341	Lincoln Housing Co./Turner, Ivan (Eleanor)	trav. rep., Phillips Petro.
Puritan Ave 3110	1946	42140	Farrens, A. H.	C	E-5 379		
Puritan Ave 3115	1946	42172	Sweeney-Solheim Co.	C	E-5 443		
Puritan Ave 3128	1941	35583	Hoesch, Albert W.	C	E-5 380		
Puritan Ave 3135	1946	42171	Sweeney-Solheim Co.	C	E-5 442		
Puritan Ave 3138	1941	35538	Solheim, Selmer A.	C	E-5 140		
Puritan Ave 3147	1940	32114	Maxey, J. W.	C	E-5 441		
Puritan Ave 3148	1939	31070	Hazen, Bruce/Rathbone, Harvey Co.	C	E-5 381	Lincoln Housing Co./Kelly, E. Lynn (Margery)	exec. asst, FSA
Puritan Ave 3158	1939	31443	Hazen, Bruce/Rathbone, Harvey Co.	C	E-5 382	Lincoln Housing Co./Sutherland, C. Austin (Ellen)	insurance
Puritan Ave 3168	1939	31069	Lincoln Housing Co.	C	E-5 383	Lincoln Housing Co.	
Puritan Ave 3169	1940	33011	Wilscam, Charles A.	C	E-5 440	Keriakedes, John J.	
Puritan Ave 3175	1945	41059	Sweeney-Solheim Co.	C	E-5 439		
Puritan Ave 3178	1946	41768	Galter, Simon	C	E-5 384		
Puritan Ave 3188	1950	52299	Peterson, Harold F.	C	E-5 385		
Rathbone Rd 2315	1925	13315	Rathbone Carpenter Co.	C	E-5 129		
Rathbone Rd 2500	1949	50692	Witt & Juckette	C	E-5 126		
Rathbone Rd 2501	1952	56926	Bartlett, Ray L.	C	E-5 127		
Rathbone Rd 2508	1923	11682	Rathbone Carpenter Co.	C	E-5 125		
Rathbone Rd 2509	1923	11684	Rathbone Carpenter Co.	C	E-5 128		
Rathbone Rd 2516	1924	12073	Rathbone Carpenter Co.	C	E-5 124		
Rathbone Rd 2522	1940	33418	Wilscam, Charles A.	C	E-5 123	Bemis, Robt (Barbara)	VP, Conservative Inv. Co.
Rathbone Rd 2525	1925	14287	Penrod, Carl A.	C	E-5 130		
Rathbone Rd 2530	1939	31322	Nootz, C.A.	C	E-5 122	Lancaster, Lane W. (Mary)	prof., U of NE
Rathbone Rd 2539	1925	13325	Rathbone Carpenter Co.	C	E-5 131		
Rathbone Rd 2540	1929	18591	Decker, H.M.	C	E-5 121		

**United States Department of the Interior
National Park Service**

**National Register of Historic Places
Continuation Sheet**

Boulevards Historic District

Name of Property

Lancaster County, Nebraska

County and State

Section number 7 Page 20

Address	BP Date	BP #	Builder/Architect	Status	NeHBS LC13:	Occupant	Occupation
Rathbone Rd 2600	1905	11681	Rathbone Carpenter Co.	C	E-5 120		
Rathbone Rd 2601	1925	14228	Webber, R.C.	C	E-5 132		
Rathbone Rd 2609	1923	11685	Rathbone Carpenter Co.	C	E-5 133		
Rathbone Rd 2610	1926	15189	King, C.W.	C	E-5 119		
Rathbone Rd 2616	1924	12072	Rathbone Carpenter Co.	C	E-5 118		
Rathbone Rd 2625	1924	12179	Rathbone Carpenter Co.	C	E-5 134		
Rathbone Rd 2626	1923	11680	Rathbone Carpenter Co.	C	E-5 117		
Rathbone Rd 2632	1938	28951	Aitken, Martin	C	E-5 116	Carlson, Norman (Helen)	dentist
Rathbone Rd 2633	1924	12180	Rathbone Carpenter Co.	C	E-5 135		
Rathbone Rd 2640	1924	13169	Rathbone Carpenter Co.	C	E-5 115		
Rathbone Rd 2641	1923	11683	Rathbone Carpenter Co.	C	E-5 136		
Rathbone Rd 2656	1924	12071	Rathbone Carpenter Co.	C	E-5 114		
Rathbone Rd 2700	1926	15896	Robertson, George M.	C	E-5 113		
Rathbone Rd 2714	1924	12070	Rathbone Carpenter Co.	C	E-5 112		
Rathbone Rd 2734	1924	12090	Miller, Jesse B.	C	E-5 111		
Rathbone Rd 2755	1935	22878	Hazen, N. Bruce	C	E-5 66		
Rathbone Rd 2760	1931	20274	Hazen, N. Bruce	C	E-5 110		
Rathbone Rd 2772	1928	17329	Nootz, C.A.	C	E-5 109		
Rathbone Rd 2775	1931	20042	Davis & Wilson	C	E-5 64		
Royal Court 2700	1950	51936	Clark & Enerson	C	E-4 128		
Royal Court 2705	1940	33581	Unthank, John O.	C	E-4 119	Speidell, Max (Nellie)	sales mngr, C. E. Speidell
Royal Court 2727	1945	41312	Craig, Fritz	C	E-4 120		
Royal Court 2736	1941	34861	Miller, A.W. Co., Inc.	C	E-4 127	Whitney, Ramey (Doris)	agri. economist
Royal Court 2737	1950	54047	Cornell & Sampson	C	E-4 121		
Royal Court 2740	1942	35829	Miller, A.W. Co., Inc.	C	E-4 126		
Royal Court 2747	1949	51039	Penton, H. M.	C	E-4 122		
Royal Court 2757	1940	33716	Anderson, A. O. & Sons	C	E-4 123	Steffensmeyer, Wm C (Eleanor)	br mng, Sidies Co.
Ryons 2401	1916	6425	Ryman, C.W.	C	D-5 7		
Ryons 2412	1921	9105	Fullagar, William G.	C	D-5 61		
Ryons 2421	1921	9159	Madden, Herbert B.	C	D-5 150		
Ryons 2424	1921	9028	Fullagar, William G.	C	D-5 60		

**United States Department of the Interior
National Park Service**

**National Register of Historic Places
Continuation Sheet**

Section number 7 Page 21

Boulevards Historic District

Name of Property

Lancaster County, Nebraska

County and State

Address	BP Date	BP #	Builder/Architect	Status	NeHBS LC13:	Occupant	Occupation
Ryons 2427	1919	8284	Lindblad, Axel L.	C	D-5 151		
Ryons 2434	1924	13034	Hanson, Paul	C	D-5 59		
Ryons 2437	1921	9129	Ryman, C.W.	C	D-5 152		
Ryons 2444	1921	8977	Woods Brothers	C	D-5 58		
Ryons 2454	1925	14639	Robertson, A.N.	C	D-5 57		
Ryons 2455	1914	5532	Burford & Randolph	C	D-5 153		
Ryons 2465	1976	114507	Equity Homes	NC	D-5 462	Miller, Dan	
Ryons 2611	1925	14271	Kingery Construction Co.	C	D-5 576	Albin, Joseph	sec., Lincoln Liberty Life
Ryons 2617	1921	9262	Hanson, Paul G.	C	D-5 577	Stout, Richard (Anna)	attorney
Ryons 2625	1925	14169	Bridge Bros.	C	D-5 578	Whitfield, Wm W.	prominent Mason
Ryons 2629	1924	12522	Alexander, John M.	C	D-5 579	Reese, Sidney O. (Elizabeth)	surgeon
Ryons 2635	1909	3222	Gibbs & Beeman	C	D-5 580	Silsbee, Evan (Clara)	
Ryons 2645	1922	10560	Hanson, Paul G.	C	D-5 581	Hadley, Addie B.	widow of Seth S. Hadley
Ryons 2653	1913	5183	Wagner, J.	C	D-5 582	Madsen, Julius	grocer, 14th & O
Ryons 2659	1925	13677	Alexander, John M.	C	D-5 583	Olson, Aug. B.	dept. mngr, Bankers Life
Ryons 2700	1921	9297	Harvey Enslow Lumber Co.	C	E-5 299	Bennett, John R.	dentist
Ryons 2703	1922	10455	Hilton Bros.	C	E-5 298	Stilson, Earl B.	salesman, Cushman Motor Works
Ryons 2710	1923	11016	Proudfit, W.H.	C	E-5 300	Proudfit, William (Frances)	
Ryons 2711	1918	7573	Rathbone Co., Harvey	C	E-5 297	Spigle, Julius	mngr, Remington Typewriter Co.
Ryons 2716	1922	9812	Gaddis, E.W.	C	E-5 301	Stonesifer, Eugene F.	inspector
Ryons 2722	1919	8166	Madden, Herbert B.	C	E-5 302	Wood, Daniel (Ethel)	insurance agent
Ryons 2725	1921	9046	Farrell, L.F.	C	E-5 296	Steffensmeyer, William C.	treas., Carter Transfer
Ryons 2729	1919	7860	Harvey Enslow Lumber Co.	C	E-5 295	Erickson, David L.	longtime City Engineer
Ryons 2732	1917	6948	Unthank, George R.	C	E-5 303	Gronquist, Alvin (Katharyne)	real estate
Ryons 2741	1919	7859	Rathbone Co., Harvey	C	E-5 294	Hilton, Roy (Edna)	reporter, Lincoln Star
Ryons 2742	1917	6947	Unthank, George R.	C	E-5 304	Cochrane, Robt. L. (Aileen)	Governor 1935-41
Ryons 2802	1919	8218	Madden, Herbert B.	C	E-5 305	Steward, F. E. (Laura)	sec., Woods Bros
Ryons 2812	1922	9598	Star Real Estate Co.	C	E-5 306	Backer, William G.	retired circulation mngr, Star newspaper, Postmaster
Ryons 2820	1921	9548	Rathbone Carpenter Co.	C	E-5 307	Jerner, Orion E.	
Ryons 2912	1922	10234	Rathbone Carpenter Co.	C	E-5 227	Miles, John M.	Real Estate Co. mngr

**United States Department of the Interior
National Park Service**

**National Register of Historic Places
Continuation Sheet**

Boulevards Historic District

Name of Property

Lancaster County, Nebraska

County and State

Section number 7 Page 22

Address	BP Date	BP #	Builder/Architect	Status	NeHBS LC13:	Occupant	Occupation
Ryons 2924	1922	9638	Hillyer, F.P.	C	E-5 206	Hillyer, F.P.	
Ryons 2931	1919	7813	Sheridan Park Inv. Co.	C	E-5 205		
Ryons 2935	1933	21249	A. Robertson, A.	C	E-5 204		
Ryons 2936	1920	8594	Vogel, George	C	E-5 207		
Ryons 2941	1922	10259	Rudeen, John	C	E-5 203		
Ryons 2948	1919	8244	Sheridan Park Inv. Co.	C	E-5 208		
Ryons 2954	1919	7797	Star Real Estate Co.	C	E-5 209		
Ryons 2955	1919	7814	Sheridan Park Inv. Co.	C	E-5 202		
Ryons 3000	1923	10821	Rathbone Co., Harvey	C	E-5 210		
Ryons 3001	1922	10049	Star Real Estate Co.	C	E-5 201		
Ryons 3010	1924	12244	Guardian Mortgage Securities	C	E-5 211		
Ryons 3011	1924	12068	Rathbone Carpenter Co.	C	E-5 200		
Ryons 3019	1919	8242	Sheridan Park Inv. Co.	C	E-5 199		
Ryons 3020	1919	8243	Sheridan Park Inv. Co.	C	E-5 212		
Ryons 3027	1922	10655	Rathbone Carpenter Co.	C	E-5 198		
Ryons 3028	1922	10603	Rathbone Carpenter Co.	C	E-5 213		
Ryons 3035	1947	44112	Solheim, Selmer A.	C	E-5 197		
Ryons 3036	1947	44111	Solheim, Selmer A.	C	E-5 214		
Ryons 3100	1950	53670	Wilsam, Charles A.	C	E-5 455		
Ryons 3105	1950	52395	Tyler, Lawrence	C	E-5 454		
Ryons 3114	1950	51588	Wilsam, Charles A.	C	E-5 456		
Ryons 3115	1951	54326	Danielson, J. Arthur	C	E-5 453		
Ryons 3126	1950	51589	Wilsam, Charles A.	C	E-5 457		
Ryons 3131	1951	54780	Petty, H.	C	E-5 452		
Ryons 3132	1951	55978	Wilsam, Charles A.	C	E-5 458		
Ryons 3142	1952	no permit	unknown	C	E-5 459		
Ryons 3145	1956	68675	Stewart, Frank	C	E-5 451		
Ryons 3150	1953	60671	Howard, H. W.	C	E-5 460		
Sewell 2404	1920	8485	Madden, Herbert B.	C	D-5 159		
Sewell 2409	1912	4439	Hanson, Paul G.	C	D-5 249		
Sewell 2416	1920	8617	Madden, Herbert B.	C	D-5 158		

United States Department of the Interior
National Park Service

National Register of Historic Places
Continuation Sheet

Section number 7 Page 23

Boulevards Historic District

Name of Property

Lancaster County, Nebraska

County and State

Address	BP Date	BP #	Builder/Architect	Status	NeHBS LC13:	Occupant	Occupation
Sewell 2421	1919	8088	Lincoln Loan & Ins. Co	C	D-5 250		
Sewell 2425	1914	5798	Park, A.F.	C	D-5 251		
Sewell 2426	1919	8098	Madden, Herbert B.	C	D-5 157		
Sewell 2434	1916	6689	Burford & Randolph	C	D-5 156		
Sewell 2435	1914	5649	Hanson, Paul G.	C	D-5 252		
Sewell 2443	1909	3441	Ross, T.B.	C	D-5 253		
Sewell 2450	1936	24687	Miller, A.W. Co., Inc.	C	D-5 155		
Sewell 2453	1919	7848	Woods, Chas D.	C	D-5 254		
Sewell 2461	1922	9737	Fullagar, William G.	C	D-5 255		
Sewell 2464	1911	4102	Wilson, George	C	D-5 154		
Sewell 2465	1915	6066	Fullagar, Edwin	C	D-5 256		
Sewell 2626	1917	7076	Fullagar, William G.	C	D-5 591	Yost, Arthur H.	Yost Lumber Co.
Sewell 2631	1919	8266	Madden, Herbert B.	C	D-5 592	Birdzell, Charles A.	Rudge & Guenzel Dept. Store
Sewell 2636	1925	13676	Howey, W. H.	C	D-5 590	Howey, Waldron H.	mng. Rovident Ins. Agency
Sewell 2641	1921	9251	Christiansen, C.P.	C	D-5 593	Blore, Elbert M.	seed grower
Sewell 2645	1925	13372	Sewell, E.L.	C	D-5 594	Kumpf, Otto M.	musician, salesman
Sewell 2646	1919	7925	Bogan, John J.	C	D-5 589	Shirey, John (Lillian)	salesman
Sewell 2648	1925	13485	Alexander, John M.	C	D-5 588	Morrison, John	supt., Woods Bros. Corp.
Sewell 2657	1923	11301	Shurtleff, W.B.	C	D-5 595	Getaz, Louis	salesman
Sewell 2660	1919	8074	Beck, Robert	C	D-5 587	Zook, Oliver G.	salesman
Sewell 2665	1928	17463	Blettmer, Henry	C	D-5 596	Stephenson, Sam C. (Vera)	president, Lincoln School Supply
Sewell 2668	1921	9123	Cooper, John	C	D-5 586	Heller, Edwin B.	dept mng, Speier's Clothing
Sewell 2672	1921	9543	Cooper, John	C	D-5 585	Murphy, Charles G.	reverend
Sewell 2675	1924	13042	Robey, Frank A.	C	D-5 597	Raymond, LaForrest V.	salesman
Sewell 2701	1917	7062	Rathbone Co., Harvey	C	E-5 277	Stryker, Raymond (Elizabeth)	
Sewell 2702	1922	9796	Harvey Enslow Lumber Co.	C	E-5 284	Martin, Walter Earl	buyer
Sewell 2710	1923	10691	Harvey Enslow Lumber Co.	C	E-5 285	Owens, Herbert (Stella)	insurance agent
Sewell 2713	1924	12610	Rathbone Carpenter Co.	C	E-5 276	Goettl, Frank	laborer, Lincoln Pkg. Co.
Sewell 2723	1922	9829	Rathbone Carpenter Co.	C	E-5 275	Dill, Bryon E.	v.p., University Publish. Co.
Sewell 2726	1923	10808	Lowell, E.L.	C	E-5 286	Nordella, Estella	

United States Department of the Interior
National Park Service

National Register of Historic Places
Continuation Sheet

Section number 7 Page 24

Boulevards Historic District

Name of Property

Lancaster County, Nebraska

County and State

Address	BP Date	BP #	Builder/Architect	Status	NeHBS LC13:	Occupant	Occupation
Sewell 2730	1919	7830	Harvey Enslow Lumber Co.	C	E-5 287	Carper, Chas. M (Vera)	
Sewell 2738	1919	7991	Fullagar, William G.	C	E-5 288	Hood, Geo. W. (Mildred)	mngnr, Long Seed Co.
Sewell 2746	1924	12559	Robey, Frank A.	C	E-5 289	Handley, Archibald (Odessa)	district agent, Bankers Life
Sewell 2823	1921	9176	Jeary, Clark	C	E-5 254		
Sewell 2929	1921	9249	Madden, Herbert B.	C	E-5 187		
Sewell 2930	1922	9634	Rathbone Carpenter Co.	C	E-5 188		
Sewell 2933	1921	9250	Madden, Herbert B.	C	E-5 186		
Sewell 2936	1923	10734	Rudeen, John	C	E-5 189		
Sewell 2939	1923	10810	Merritt, B.O.	C	E-5 185		
Sewell 2940	1923	10735	Rudeen, John	C	E-5 190		
Sewell 2945	1922	10281	Rathbone Co., Harvey	C	E-5 184		
Sewell 2952	1923	11082	Holden, H.	C	E-5 191		
Sewell 3002	1922	10462	Seng, William	C	E-5 192		
Sewell 3010	1920	8647	Sheridan Park Inv. Co.	C	E-5 193		
Sewell 3013	1923	11469	Rathbone Carpenter Co.	C	E-5 183		
Sewell 3015	1924	12508	Guardian Mortgage Ins. Co.	C	E-5 182		
Sewell 3020	1938	28523	Leverton, E.R.	C	E-5 194		
Sewell 3026	1919	8178	Sheridan Park Inv. Co.	C	E-5 195		
Sewell 3027	1922	10641	Elliott, Frank A.	C	E-5 181		
Sewell 3034	1922	9620	Bstandig, Ed J.	C	E-5 196	Vifquain, Joseph	
Sewell 3037	2008		unknown	NC	E-5 445		
Sewell 3100	1956	67977	Harney, Herman	C	E-5 446		
Sewell 3112		no permit	unknown	C	E-5 447		
Sewell 3124	1950	54031	Wilscam, Charles A.	C	E-5 448		
Sewell 3132	1950	54032	Wilscam, Charles A.	C	E-5 449		
Sewell 3140	1951	54341	Strauss, James	C	E-5 450		
Sheridan Blvd 2110	1925	14566	Davis & Wilson	C	D-5 1	Westminster Presbyterian Church	
Sheridan Blvd 2121	1910	3749	Sherrer, O.L.	C	D-5 460	Leet, Eugene & Allie	sec., Wright Leet Grain Co.
Sheridan Blvd 2140	1913	5077	Ringler, J.F.	C	D-5 519	Rankin, Willis (Mattie)	mngnr, Rumley Threshing Mach. Co.
Sheridan Blvd 2141	1925	14309	Robertson, George M.	C	D-5 461	Purbaugh, Jacob F.	Lanc. Cty extension agent

**United States Department of the Interior
National Park Service**

**National Register of Historic Places
Continuation Sheet**

Section number 7 Page 25

Boulevards Historic District

Name of Property

Lancaster County, Nebraska

County and State

Address	BP Date	BP #	Builder/Architect	Status	NeHBS LC13:	Occupant	Occupation
Sheridan Blvd 2200	1925	14394	Chambers, Oscar Y.	C	D-5 518	Carr, E. Arthur (Florence)	physician & surgeon developer, sister of Gen. Pershing
Sheridan Blvd 2210	1909	3261	Schaaf, C. A.	C	D-5 517	Butler, Mrs. J. J. (Mary E.)	
Sheridan Blvd 2221	1909	No BP	Fiske, Ferdinand C.	C	D-5 463	Frank Spalding	pres, Spalding Lumber Co
Sheridan Blvd 2222	1913	5073	Cordner, J.G.	C	D-5 516	Mattison, Raymond E.	gen. mngr, LT&T
Sheridan Blvd 2232	1950	54091	Worthwest Realty Co.	C	D-5 515	Tincher, Thelma	Coordinator, home ec, LPS
Sheridan Blvd 2241	1975	112491	Joyce, Jerry	NC	D-5 464		
Sheridan Blvd 2248	1925	13533	Fullagar, William G.	C	D-5 514	Woodward, Wm. A.	Woodward Bros., loans; city councilman
Sheridan Blvd 2304	1922	9612	Fullagar, William G.	C	D-5 513	Woodward, Geo. (Zula)	Woodward Bros., loans
Sheridan Blvd 2310	1910	3706	Miller, Burd F./Y. P. Harrison	C	D-5 512	Johnston, Geo & Wilford	Lincoln Gas & Electric
Sheridan Blvd 2320	1926	no permit	unknown	C	D-5 511	Vold, Lawrence	UNL law professor Abel Construction; U. S. Senator
Sheridan Blvd 2335	1915	5952	Fiske & Meginnis/Kramer, H. F.	C	D-5 465	Abel, George & Hazel	investments; remained in Martin family thru 1965
Sheridan Blvd 2340	1928	17800	Alexander, John M.	C	D-5 510	Martin, Morton R. (Elsa)	
Sheridan Blvd 2400	1926	14969	Fullagar, William G.	C	D-5 509	Smith, Van B.	osteopathic physician
Sheridan Blvd 2401	1950	52560	Miller, Palmer	C	D-5 466	Miller, Palmer	
Sheridan Blvd 2411	1950	52097	Unthank, George R./Witt & Juckette	C	D-5 467	Ludwick, Ralph Sr.	dentist
Sheridan Blvd 2420	1935	23595	Anderson, A. O. & Sons	C	D-5 508	Apperson, Sarah & Conlee, Benj.	Apperson: teacher
Sheridan Blvd 2421	1926	15374	Alexander, John M.	C	D-5 468	Swanholm, Karl	salesman
Sheridan Blvd 2426	1924	12382	Hiller, George E.	C	D-5 507	Roelfs, Mary E.	
Sheridan Blvd 2431	1925	13465	Alexander, John M.	C	D-5 469	Nebr. State Journal "Firesafe home"/Crook, Ira C.	v.p., Lincoln Liberty Life Insurance
Sheridan Blvd 2450	1929	18942	Alexander, John M.	C	E-5 50		
Sheridan Blvd 2501	1916	No BP	Hyland, Paul V.	C	D-5 470	Woods, Frank & Nelle (Cochrane)	LT&T, Woods Aitken Law Firm, Woods Bros.
Sheridan Blvd 2540	1950	53109	Hazen & Robinson	C	D-5 502	Rodgers, Bert	pres, Union Nat'l Life Ins.
Sheridan Blvd 2700	1949	50198	Anderson, M.W.	C	E-5 43	Cunningham, Col. Harry	architect
Sheridan Blvd 2701	1923	11027	Rathbone Carpenter Co.	C	E-5 1	Winnett, Dr. Hiram	orthopedics
Sheridan Blvd 2720	1940	33068	Craig, Fritz	C	E-5 44	Krause, William	Roofing & sheetmetal
Sheridan Blvd 2730	1938	28507	Miller, A.W. Co., Inc.	C	E-5 45		
Sheridan Blvd 2733	1922	9900	Miller, Jesse B	C	E-5 2	Hitchcock, Wm. F. and Birdie	auto dealer
Sheridan Blvd 2804	1920	8416	Madden, Herbert B.	C	E-5 46	Hellerich, Chris and Selma	

United States Department of the Interior
National Park Service

National Register of Historic Places
Continuation Sheet

Boulevards Historic District

Name of Property

Lancaster County, Nebraska

County and State

Section number 7 Page 26

Address	BP Date	BP #	Builder/Architect	Status	NeHBS LC13:	Occupant	Occupation
Sheridan Blvd 2816	1918	7606	Miller, Jesse B.	C	E-5 47	Calhoun Family	
Sheridan Blvd 2821	1960	75117	Karst, E.	NC	E-5 3	Knapp, Royce	
Sheridan Blvd 2828	1927	16493	Gustin, Clark	C	E-5 48	Fowler, John & Mildred	pres., Conservative Mtge Co.
Sheridan Blvd 2833	1926	16013	Rathbone Carpenter Co.	C	E-5 4	Maher, John	pres. Old Line Life Insur.
Sheridan Blvd 2838	1925	13685	Fiske & Meginnis	C	E-5 49	Nefsky, Samuel	Hub Clothing Co.
Sheridan Blvd 2850	1929		Davis & Wilson	C	E-5 50	Coryell, Levi Leland, Jr.	real estate, etc.
Sheridan Blvd 2900	1917	7073	Rische, F.W.	C	E-5 51	Dierks, Edward	lumberman
Sheridan Blvd 2907	1919	8040	Parks, William N.	C	E-5 5	Herzog, Edw. H.	sales mngr, Nebraska Aircraft Corp.
Sheridan Blvd 2920	1922	10152	Fiske & Meginnis	C	E-5 52	Gardner, Nathaniel	insurance
Sheridan Blvd 2934	1925	13570	Fullagar, William G.	C	E-5 53	DeBrown, Leroy	auto dealer
Sheridan Blvd 2943	1923	10840	Fiske & Meginnis	C	E-5 6	Sartor, Ernest	jeweler
Sheridan Blvd 2950	1921	9197	Parks, William N.	C	E-5 54	Webster, Fred & Carrie	dentist
Sheridan Blvd 2961	1939	31425	Hazen, N. Bruce	C	E-5 7	Hohlen, Karl & Mina	physician
Sheridan Blvd 2990	1938	27413	Kaiser, John H.	C	E-5 55	Frerichs, Edward (Elsie)	supt of agents, Sec. Mutual Life Ins.
Sheridan Blvd 3000	1933	21339	Miller, Estella B.	C	E-5 56	Miller, Albert & Estella	insurance
Sheridan Blvd 3009	1927	16298	Miller & Craig	C	E-5 8	Walt, Rubin	grocer
Sheridan Blvd 3020	1928	17481	Miller & Craig	C	E-5 57	Kohn, Henry	Western Mattress Co.
Sheridan Blvd 3024	1925	13754	Rathbone Carpenter Co.	C	E-5 58	Peterson, C. Petrus	Speaker of House (Unicameral)
Sheridan Blvd 3025	1942	35768	Meginnis & Schaumberg	C	E-5 9	Orme, Fern & Emmett	First woman City Councilor, legislator; pres. Union Insurance
Sheridan Blvd 3030	1924	12069	Rathbone Carpenter Co.	C	E-5 59	Noble, Hilbert	
Sheridan Blvd 3035	1923	11015.5	Davis & Wilson	C	E-5 10	Lord, Charles & Nellie	auto dealer
Sheridan Blvd 3042	1921	9447	Williams, John P.	C	E-5 60	Williams, John P.	physician
Sheridan Blvd 3055	1925	14006	Rathbone Carpenter Co.	C	E-5 11	Grainger, Harry & Louise	grocer
Sheridan Blvd 3060	1926	15050	Woods, A.W.	C	E-5 61	McNaulty, Homer	pres. Nebraska Casket Co.
Sheridan Blvd 3065	1933	21209	Miller & Craig	C	E-4 12	Koehler, David & Leona	construction
Sheridan Blvd 3070	1946	42090	Unthank, John O.	C	E-5 62	Cook, George	CEO, Bankers Life
Sheridan Blvd 3084	1932	20688	Meginnis & Schaumberg	C	E-5 63	Talbot, Robert	
Sheridan Blvd 3101	1951	56598	Embury, Paul	C	E-4 15		
Sheridan Blvd 3115	1951	56560	Anderson, M.W.	C	E-4 16		

**United States Department of the Interior
National Park Service**

**National Register of Historic Places
Continuation Sheet**

Boulevards Historic District

Name of Property

Lancaster County, Nebraska

County and State

Section number 7 Page 27

Address	BP Date	BP #	Builder/Architect	Status	NeHBS LC13:	Occupant	Occupation
Sheridan Blvd 3121	1926	16008	Rathbone Carpenter Co.	C	E-4 17	Proudfit, George E.	pres., R. S. Proudit (lumber) Co.
Sheridan Blvd 3135	1930	19345	Pierson, A. E.	C	E-4 18	Stenten, Albert & Caroline	
Sheridan Blvd 3140	1941	34713	Meginnis & Schaumberg	C	E-4 40	Dobson, Arthur A.	Dobson & Robinson Construction Co.
Sheridan Blvd 3141	1931	20225	Sweeney & Co.	C	E-4 19	Misco, George & Irene	physician
Sheridan Blvd 3144	1917	No BP	Fiske & Meginnis (1923 remodel)	C	E-4 39	Arthur A. Dobson	Contractor
Sheridan Blvd 3158	1917	No BP	Roberts, Artemas	C	E-4 33	Charles Roberts	Roberts Construction Company
Sheridan Blvd 3166	1924	12336	Bielharz, W.T.	C	E-4 32	Zimmer, Jack & Muriel	salesman
Sheridan Blvd 3172	1928	18012	Pierson, A. E.	C	E-4 31	Carter, Earl	lumberman
Sheridan Blvd 3175	1930	19297	Fullagar, William G.	C	E-4 20		
Sheridan Blvd 3185	1926	15777	Anderson, M.W.	C	E-4 21	Gadd, Arthur	printer
Sheridan Blvd 3188	1928	18250	Rathbone Carpenter Co./Curtis Plan Co.	C	E-4 30	built as duplex	
Sheridan Blvd 3193	1941	35453	Unthank, John O.	C	E-4 22	Miller, A. W. & Co./Reudi, Jack H (Jessie M.)	salesman
Sheridan Blvd 3195	1942	35820	Unthank, John O.	C	E-4 23	Miller, A. W. & Co.	
Sheridan Blvd 3200	1937	26108	Miller, Jesse B.	C	E-4 29	built as duplex, by Wm. A. Dailey	pres. White Motor Co.
Sheridan Blvd 3210	1928	17771	Dailey, H.B.	C	E-4 28	Dailey, Wm. A.	pres. White Motor Co.
Sheridan Blvd 3215	1948	48705	Pauley, R.H.	C	E-4 25		
Sheridan Blvd 3219	1954	62238	Davis & Wilson/Assenmacher Construction Co.	C	E-4 26	Congregation Tifereth Israel Synagogue	
Sheridan Blvd 3220	1946	42726	Miller, Jesse B.	C	E-4 27		
Sheridan Blvd 3225	1951	56822	Lorenz, Everett/Witt & Juckette	C	E-4 216	Doan, Ron	
Sheridan Blvd 3227	1956	68470	Calbert, J.P.	C	E-4 214		
Sheridan Blvd 3230	1976		unknown	NC			
Sheridan Blvd 3233	1956	67839	Hampton, Joseph R.	C	E-4 215		
Sherman St 2800	1951	54815	Phillips, Hugh L.	C	E-4 275	Phillips, Hugh L.	
Sherman St 2815	1951	54540	Kessler, Clarence E.	C	E-4 277	Kessler, Clarence E.	
Sherman St 2840	1950	52950	Jensen, A. T.	C	E-4 298	Akin, Dr. Fred M.	
Sherman St 2900	1939	31401	Hazen, Bruce/Fullagar, W. G.	C	E-4 307	Blankinship, Mr.&Mrs. L. M.	
Sherman St 2945	1951	55132	Jensen, A. T.	C	E-4 332	Ensign, L. A.	
Smith Street 2002	1955	65189	Irwin, Rayburn	C	D-5 623	Irwin, Rayburn	
Smith Street 2020	1890	no permit	unknown	NC	D-5 615	Golden Rule Dairy	rotated on foundation

**United States Department of the Interior
National Park Service**

**National Register of Historic Places
Continuation Sheet**

Section number 7 Page 28

Boulevards Historic District

Name of Property

Lancaster County, Nebraska

County and State

Address	BP Date	BP #	Builder/Architect	Status	NeHBS LC13:	Occupant	Occupation
Smith Street 2030	1977	120812	Schleiming, Don	NC	D-5 624	Schuster, Paul	
Smith Street 2044	1948	48490	Johnson, Harry C.	C	D-5 625	Johnson, Harry C.	
Smith Street 2100	1946	42053	Solheim, Selmer A.	C	D-5 626	Sweeney-Solheim & Co.	
Smith Street 2112	1924	12893	Stone, D. A.	C	D-5 627	Hoffman, Mrs. Myrtle	
Smith Street 2118	1921	9198	Traudt, Mrs. Katharine	C	D-5 618	Traudt, Mrs. Katharine	
Smith Street 2124	1923	11348	Hirsch & Bastron	C	D-5 628	Newbert, George	
Smith Street 2132	1926	15386	Dennis, Charles	C	D-5 629	Dennis, Charles	
Smith Street 2201	1944	39773	Pierson, A. E.	C	D-5 543	Ritter, Jerome & Margery	physician City Street Super., USArmy major, Cowgill Coal Co.
Smith Street 2210	1921	9157	Cowgill, Allen P.	C	D-5 542	Cowgill, Allen P.	
Smith Street 2215	1944	39774	Pierson, A. E.	C	D-5 544		
Smith Street 2218	1926	15258	Alexander, John M.	C	D-5 541	Gallagher, Don C.	attorney
Smith Street 2226	1951	56728	Wiltshire, Merril B.	C	D-5 540	Beals, Alfred	
Smith Street 2234	1922	9949	Hillyer, F.P.	C	D-5 539	Faulkner, Richard W. & Dorothy	Woodman Accident Life
Smith Street 2239	1924	12897	Miller, Jesse B.	C	D-5 545		
Smith Street 2249	1921	9293	Fullagar, William G.	C	D-5 546		
Smith Street 2252	1923	10725	Grubb, W.G.	C	D-5 538	Beers, Frank & Margaret	teacher, State Chemist; GOP worker
Smith Street 2300	1927	17092	Alexander, John M.	C	D-5 537	Gillaspie, Thomas E. & Nora	insurance, Lanc. Cty Comm.
Smith Street 2301	1927	16613	Alexander, John M.	C	D-5 547		
Smith Street 2309	1927	17031	Alexander, John M.	C	D-5 548		
Smith Street 2310	1927	16633	Fullagar, William G.	C	D-5 536	Harley, J. Burks	pharmacist, Harley Drug Co.
South 20th 2530	1987	147548	move-on	NC	D-5 641	Rosenow, John	
South 20th 2620	1951	54894	Dietrich, Carl	C	D-5 622	Jackson, R. L.	
South 22nd 2116	1917	6992	Thompson, George F.	C	D-5 043		
South 22nd 2212	1919	8028	Star Real Estate Co.	C	D-5 137		
South 22nd 2535	1922	10391	Chambers, Oscar Y.	C	D-5 608	Slothower, R. S.	
South 22nd 2540	1946	42054	Solheim, Selmer A.	C	D-5 528	Sweeney-Solheim Co.	
South 22nd 2631	1925	14628	Carter, N.	C	D-5 609	Passmore, E. W.	
South 22nd 2745	1926	15033	Meginnis & Schaumberg/Olson Const. Co.	C	D-5 004	Irving Middle School	
South 24th 2108	1917	6987	Burford & Randolph	C	D-5 53		
South 24th 2304	1941	35180	Johnson, A.L.	C	D-5 248	Gorman, Alf (Rachel)	adv mngr, Tel Co

United States Department of the Interior
National Park Service

National Register of Historic Places
Continuation Sheet

Boulevards Historic District

Name of Property

Lancaster County, Nebraska

County and State

Section number 7 Page 29

Address	BP Date	BP #	Builder/Architect	Status	NeHBS LC13:	Occupant	Occupation
South 24th 2505	1950	53120	Penrod & Penrod	C	D-5 454	Marx, Paul D.	physician
South 24th 2510	1928	17562	Baker & Holder	C	D-5 479	Chubb, Chester & Edith	pres., IA-NE Light & Power
South 24th 2525	1954	63179	Dietrich, Carl J.	NC	D-5 521	Hersch, Harry	post-modernist modifications
South 24th 2530	1951	54515	Meginnis & Schaumberg/ Anderson, MW Const. Co.	C	D-5 480	Kalin, L. M.	
South 24th 2601	1953	60970	Anderson, M.W.	C	D-5 534	Mowbray, C. R.	
South 24th 2610	1927	16319	Miller & Craig/Assenmacher, WJ Meginnis & Schaumberg/Fullagar, WG	C	D-5 481	Pringle, Wayne & Erna	chief engineer, Woods Bros.
South 24th 2626	1937	26517		C	D-5 482	Andrews, Clayton & Mildred	physician
South 24th 2633	1937	25785	Meginnis & Schaumberg	C	D-5 535	Swanson, Clarence E. & Helen	sec/treas. Hovland-Swanson Co.
South 24th 2705	1930	19426	Asshumacker, W.J.	C	D-5 549		
South 24th 2720	1925	14785	Miller & Craig/Jobst, BJ Bldg Co.	C	D-5 485	Raymond, J. W.	Raymond Bros. wholesale grocers
South 24th 2811	1923	11487	Davis, Ellery	C	D-4 18	Gere, Mariel	Tchr. Lincoln High School
South 24th 2818	1925	13741	Decker, H.M.	C	D-4 43	Truman, Ernest (Cath)	Pres Austin Credit Co
South 24th 2824	1937	26774	Sweeney Construction Co.	C	D-4 44	Wendelin, Mrs. Gertrude	sec Clinton J Campbell
South 24th 2829	1927	16552	Meginnis & Schaumberg	C	D-4 39	Barkley, William E. (Edna M)	pres Lincoln Joint Stock Land Bank
South 24th 2832	1939	31331	Anderson, A. O. & Sons	C	D-4 45	Gaddis, Albert M. (Agnes A)	design eng State Dept Rds & Irrig
South 24th 2840	1931	20451	Sweeney & Co.	C	D-4 46	Hollingsworth, John E. (Pearl D)	service mgr Evans Lndry
South 24th 2843	1934	22063	Davis & Wilson	C	D-4 40	Ward, Chester K. (Hazel L)	Capital Bridge Co
South 24th 2900	1947	46128	Penrod & Penrod	C	D-4 47	Popenhagen, Charles E. (Della S)	
South 24th 2905	1951	56257	Aitken, Martin	C	D-4 41	Tallman, Gene H. (Hazel)	v-pres Om Lincoln & Beatrice Railway Co
South 24th 2908	1927	16440	Rogers, Walter	C	D-4 48	Desmond, J. Gerald (Aileen)	mgr Citizens Lmbr Co
South 24th 2920	1938	27233	Unthank, John O.	C	D-4 49	Reudi, Jack H. (Jessie M)	trav slsmn
South 24th 2929	1950	53293	Ristow, R.A.	C	D-4 42	Henkle, Giles C. (Dolores)	pres Henkle & Joyce Hardware 800 Q St
South 24th 2975	1921	9170	Fiske & Meginnis	NC	D-4 19	Tobin, Louis B. (Ida)	Vice Pres. & Gen Mngr. Star Publishing Co.
South 24th 3100	1961	79324	Ristow, R.A.	NC	D-4 53	Country Club of Lincoln	John F. Carey Mgr
South 24th 3120	1929	18653	Scharff, William	C	D-4 55	Simpson, Ward E. (Harriet E)	mgr Lamson Bros & Co
South 24th 3132	1940	31804	Rush, Clyde D.	C	D-4 56	McMurtrey, Marvin S. (Grace)	supvr US Soil Conservation Service
South 24th 3140	1940	32784	Rush, Clyde D.	C	D-4 57	Stoesz, Abraham D. (Justina)	emp US Soil Conservation Service

United States Department of the Interior
National Park Service

National Register of Historic Places
Continuation Sheet

Boulevards Historic District

Name of Property

Lancaster County, Nebraska

County and State

Section number 7 Page 30

Address	BP Date	BP #	Builder/Architect	Status	NeHBS LC13:	Occupant	Occupation
South 25th 2800	1941	35634	Unthank, John O.	C	D-4 73	Best, Arthur C. (Maude)	v-pres The Royal Highlanders dentist 606 Security Mut Life bldg
South 25th 2815	1938	27981	Pierson, A. E.	C	D-4 58	Pardee, Alton M. (Evelyn)	
South 25th 2818	1930	19611	Berlinghof, Geo	C	D-4 74	Smith, Charles A. (Leah)	chief sec Royal Highlanders
South 25th 2825	1938	28257	Hoesch, Albert W.	C	D-4 59	Bennett, Frank C. (Geneva H)	sis rep
South 25th 2826	1936	24098	Sweeney & Co.	C	D-4 75	Macdonald, Mrs. Helen M.	Widow Fredk B./photog 218 N 11th
South 25th 2901	1936	25572	Lorenz, Felix A.	C	D-4 60	Borgelt, Francis	bkpr Farmers Mut Ins Co
South 25th 2908	1930	19309	Putzer, S.R.	C	D-4 94	Rabe, Frederick (Emma)	instr Martin Luther Seminary
South 25th 2916	1936	25095	Rudeen, John	C	D-4 95	Gere, John C. (Mary)	appr State Journal Prtg Co
South 25th 2919	1931	19971	Sweeney & Co.	C	D-4 61	Stephenson, Gerald D. (Frances J)	sec-tres Lincoln School Supply Co
South 25th 2921	1932	20518	Sweeney & Co.	C	D-4 62	Tedrick, Raymond E. (Ruth)	dept mgr Freadrich Bros
South 25th 2925	1925	13531	Robey, Frank A.	C	D-4 63	Beck Leo J. (Gertrude)	teller First natl Bank
South 25th 2928	1926	16030	Rogers, Walter	C	D-4 96	Barratt, Milton (Clara)	asst plant supt Lincoln Tel & Tel Co
South 25th 2935	1928	17993	Coloer, John B.	C	D-4 64	Rathburn, Winthrop G. (Mary)	mgr Western Sup Co
South 25th 2936	1927	16359	Rogers, Walter	C	D-4 97	Minick, Wesley H. (Bernice)	adj Western Adj & Insp Co
South 25th 2945	1926	15698	Robey, Frank A.	C	D-4 66	Thomas, Fred G. (Helen)	Dentist 314 Sec Mut Life Bldg
South 25th 3120	1936	25531	Lorenz, Felix A.	C	D-4 110	Hild, Erwin C. (Dorothy)	ins and tax statistician Ia-Neb L & P Co
South 25th 3123	1924	12975	Pierson, A. E.	C	D-4 69	Sommers, Norman H. (Gladys)	Golf Instr.
South 25th 3130	1936	25520	Lorenz, Felix A.	C	D-4 111	LaFollette, William F. (Bessie E)	towermn
South 25th 3131	1929	18428	Larsen, C.M.	C	D-4 70	Mulder, Paul (Rachael)	bkpr Standard Planing Mill Co cash Johnson Supply & Coal Co
South 25th 3135	1938	28181	Bauer, W.J.	C	D-4 24	Fredrickson, Carroll M. (Ethel)	genl mgr Central Lumber Sales Co
South 25th 3136	1938	28170	Pierson, A. E.	C	D-4 112	Mulligan, Edward V. (Greta P)	
South 25th 3146	1938	28446	Nieman, Henry	C	D-4 113	Bieberstein, Paul C. (Alice H)	tchr U of N
South 25th 3147	1946	42914	Solheim, Selmer A.	C	D-4 71	Van Burg, Harold E. (Laura E)	sis mgr O'Shea-Rogers Motor Co
South 25th 3155	1939	29794	Kriz, E.J.	C	D-4 72	Austin, Wayne W. (Mildred M)	tech dept US Soil Conservation Service
South 26th 2901	1927	16811	Rogers, Walter	C	D-4 141	Andrews, Luther G. (Helen C)	Andrews Insurance Agency
South 26th 2909	1927	16661	Rogers, Walter	C	D-4 142	Westervelt, Edgar C. (Ruth)	Genl Mgr Evans Laundry Co Genl Agt Pacific Mutal Life Ins Co
South 26th 2915	1928	17793	Star Real Estate Co.	C	D-4 143	Ohlheiser, Paul V. (Marie)	
South 26th 2916	1937	26577	Fullagar, William G.	C	D-4 152	Henrion, Walter S. (Virginia D)	office wkr Central Health Co

United States Department of the Interior
National Park Service

National Register of Historic Places
Continuation Sheet

Section number 7 Page 31

Boulevards Historic District

Name of Property

Lancaster County, Nebraska

County and State

Address	BP Date	BP #	Builder/Architect	Status	NeHBS LC13:	Occupant	Occupation
South 26th 2924	1926	15422	Hazen, N. Bruce	C	D-4 153	Hazen, N. Bruce (Marian)	architect
South 26th 2925	1925	14827	Penrod, Carl A.	C	D-4 144	Cranford, Wade (Helen)	slsman Neb Buick Auto Co
South 26th 2932	1938	27272	Pierson, A. E.	C	D-4 154	Hein, Harold E. (Joy M)	sismn la-Neb L&P Co
South 26th 2935	1925	14829	Penrod, Carl A.	C	D-4 145	Butler, Mrs. Bernice C. (Elcie C)	Lord Auto Co
South 26th 2940	1938	28528	Peterson, Erwin E.	C	D-4 155	Studer, Edward (Clara)	
South 26th 2941	1926	15887	Shafer, H.L.	C	D-4 146	Good, O. Maurice (Elvira)	
South 26th 3002	1930	19328	Lowell, E.L.	C	D-4 156	Brisack, Elmer (Maxine)	trav
South 26th 3009	1937	26634	Rush, Clyde D.	C	D-4 148	Beal, Charles C. (Naoma)	cond CB&QRR credit mgr A R A Indep Oil & Gas Co
South 26th 3010	1927	17105	Rogers, Walter	C	D-4 157	Easterling, Bernhard K. (Ethel)	mgr Stanard Oil Co
South 26th 3018	1948	47235	Aukerman, L.W.	C	D-4 158	McCoy, Jacob W. (Alice C)	chf maintenance clk CB&QRR
South 26th 3026	1939	29719	Lorenz, Felix A.	C	D-4 159	Kane, Paul A. (Helen L)	teacher, Bancroft School
South 27th 2225	1920	8809	Cooper, John	C	D-5 584	Shugart, Mrs. Nettie	Coffman's Bakery
South 27th 2316	1945	41163	Johnson & Shafer	C	E-5 278	Coffman, Forrest (Beulah)	Sweeney Realty Co.
South 27th 2317	1924	13040	Robey, Frank A.	C	D-5 598	Sweeney, Wm. F.	
South 27th 2324	1957	69378	Johnson & Shafer	C	E-5 279		
South 27th 2334	1923	11877	Rathbone Co., Harvey	C	E-5 280	Miller, William A. (Hazel)	Acme Plumbing Co.
South 27th 2340	1927	16451	Larsen, C.M.	C	E-5 181		
South 27th 2340	1927	16451	Larsen, C.M.	C	E-5 281	Holland, Lyle Clifton	attorney
South 27th 2352	1922	9938	Goldstone, Harry	C	E-5 282	Hay, Ronald H.	sec/treas Central Tire & Repair
South 27th 2358	1922	10682	Rathbone Carpenter Co.	C	E-5 283	Nugent, Harry (Marian)	treas/gen. mngr H. Herpolsheimer Co.
South 27th 2457	1929	19070	Irvine, Frank	C	D-5 503	Stephens, D. V. & Paige, F. G.	built as 4 dwellings
South 27th 2810	1925	14805	Fiske, Ferdinand C.	C	E-4 3		
South 27th 2827	1925	13998	Bstandig, Ed J.	C	D-4 2	Matson, Carl R. (Nelle)	purch dept Cornell Supply Co
South 27th 2835	1928	18084	Anderson, F.A.	C	D-4 3	Muff, Mrs. Ella	Widow Benjamin J.
South 27th 2845	1937	26309	Miller, A.W. Co., Inc.	C	D-4 4	Pool, Raymond J. (Martha M)	prof U of N
South 27th 2900	1947	45428	Pierson, A. E.	C	E-4 130		
South 27th 2905	1928	17297	Meginnis & Schaumberg	C	D-4 5	Avery, Samuel (May)	instr Uni of Neb
South 27th 2910	1950	54020	Community Bldg & Fmpr.	C	E-4 129		
South 27th 2919	1924	12886	Whited, R.B.	C	D-4 6	Smith, Mrs. Rozeltha	Widow Jerome H.
South 27th 2929	1926	15599	Miller & Craig	C	D-4 7	Flanburg, Leonard A. (Frances C)	Lawyer - Hainer, Flansburg & Lee

**United States Department of the Interior
National Park Service**

**National Register of Historic Places
Continuation Sheet**

Boulevards Historic District

Name of Property

Lancaster County, Nebraska

County and State

Section number 7 Page 32

Address	BP Date	BP #	Builder/Architect	Status	NeHBS LC13:	Occupant	Occupation
South 27th 2945	1938	28085	Unthank, John O.	C	D-4 8	Beers, Gertrude	asst prof U of N
South 27th 3005	1941	34685	Unthank, John O.	C	D-4 9	Dodge, Mrs. Ruth M.	tchr PS
South 27th 3011	1939	29628	Suchy, Frank J.	C	D-4 10	Meyer, John R. (Edith A)	grain broker
South 27th 3015	1931	20478	Bstandig, Ed J.	C	D-4 11	Kolterman, Alfred C. (Helen M)	buyer Gold & Co
South 27th 3022	1950	51426	Hemphill, Ben	C	E-4 118		
South 27th 3026	1938	27110	Pierson, A. E.	C	E-4 117		
South 27th 3027	1938	28259	Hutchinson, Sylvan R.	C	D-4 12	Hutchinson, Sylvan R. (Perneasy)	clk RyMS
South 27th 3030	1936	25332	Meginnis & Schaumberg	C	E-4 116	Bowers, Halley (Grace)	
South 27th 3040	1928	17824	Alexander, John M.	C	E-4 115		
South 27th 3120	1950	53080	Hamann, W.G.	C	E-4 143		
South 27th 3121	1935	23452	Davis & Wilson	C	D-4 13	Freeman, Joseph R. (Helon)	mgr Grainger Bros Co
South 27th 3130	1939	31535	Brown, H. A.	C	E-4 144		
South 27th 3140	1939	30997	Fullagar, William G.	C	E-4 145	Batteen, John E. (Hazel)	Sumner Drug Store
South 27th 3150	1939	29787	Petersen, Ervin E.	C	E-4 146	Bilhome, Oscar (Lilly)	Buyer, Hardy Furniture Co.
South 27th 3210	1934	22666	Burnett, L. F./Fullagar, W. G.	C	E-4 241	Hicks, Mrs. Gertrude	
South 27th 3220	1938	27482	Miller, A. W. Co.	C	E-4 242	Walt, Herbert (Mary)	insurance
South 27th 3230	1938	28681	Miller, A. W. Co.	C	E-4 243	DeVriendt, Drew (Jane)	artist, Capital Engraving
South 27th 3240	1938	28071	Brown, H. A.	C	E-4 244	Whitworth, Arthur (Maude)	director, Miller & Paine
South 27th 3300	1939	29546	Fullagar, William G.	C	E-4 245	Cochran, Mrs. Bernice	widow William
South 27th 3310	1941	34499	Solheim, S. A./W. F. Steel Co.	C	E-4 246	Craig, Leslie F. (Nevada B.)	salesman, The Texas Co.
South 27th 3320	1941	34860	Unthank, J. O./Miller, A. W. Co.	C	E-4 247	Filipi, Theo (Olga)	pub. health eng, State Health Dept.
South 27th 3330	1939	30595	Sweeney Construction Co.	C	E-4 248	Ward, Sude B.	
South 27th 3350	1939	29533	Sievers, Bruce J.	C	E-4 249	Sievers, Bruce (Evea)	asst gen aud., LT&T Co.
South 27th 3400	1973	109078	unknown	NC	E-4 250		
South 27th 3414	1946	42085	Hazen, N. Bruce	C	E-4 251	Robinson, Marvin L.	
South 27th 3434	1949	50089	Penton, H. M.	C	E-4 252	Kreuscher, Mrs. Dale C.	
South 27th 3500	1955	66405	Hock, Adolph Jr.	C	E-4 253	Hock, Adolph Jr.	
South 28th 2900	1946	42227	Craig, Fritz	C	E-4 1		
South 28th 2928	1951	55112	M.W. Anderson Const. Co.	C	E-4 125		
South 28th 2932	1975	119146	Joyner, J.N.	NC	E-4 124		

United States Department of the Interior
National Park Service

National Register of Historic Places
Continuation Sheet

Section number 7 Page 33

Boulevards Historic District

Name of Property

Lancaster County, Nebraska

County and State

Address	BP Date	BP #	Builder/Architect	Status	NeHBS LC13:	Occupant	Occupation
South 28th 3200	1946	42156	Solheim, S. A./Sweeney Const.	C	E-4 270	Sweeney Solheim	
South 28th 3205	1940	32988	Solheim, S. A./Sweeney Const.	C	E-4 269	Ramsay, Ray (Florence)	teacher (Florence)
South 28th 3210	1946	42157	Solheim, S. A./Sweeney Const.	C	E-4 271	Sweeney Solheim	
South 28th 3220	1946	42158	Solheim, S. A./Sweeney Const.	C	E-4 272	Sweeney Solheim	
South 28th 3221	1939	30919	Solheim, S. A./Sweeney Const.	C	E-4 268	Eiche, Frederick (Betty)	inspector
South 28th 3224	1941	35356	Steele, W. F., Co.	C	E-4 273	Steele, W. F., Co.	
South 28th 3227	1941	34733	Aitken, Martin/DeVries, Everett	C	E-4 267	Hedge, John R. (Celeste B.)	mgr, Western Newspaper Union
South 28th 3232	1941	34404	Solheim, S. A./Sweeney Const.	C	E-4 274	Carroll, Joe	
South 28th 3235	1952	57962	Phillips, Hugh L.	C	E-4 266	Phillips, Hugh L.	
South 28th 3245	1941	34758	Worley, Max/Miller, A. W. Co.	NC	E-4 265	Worley, Jay (Mary)	printer
South 28th 3300	1946	42166	Solheim, S. A./Sweeney Const.	C	E-4 276	Sweeney Solheim	
South 28th 3303	1940	33719	Hoesch, Albert W.	C	E-4 264	Miller, Leo (Luana)	optometrist
South 28th 3313	1939	30724	Solheim, S./Kaiser, John H.	C	E-4 263	Leinberger, Harold (Florence)	asst cashier, Continental Nat'l Bank
South 28th 3316	1946	42164	Solheim, S. A./Sweeney Const.	C	E-4 278	Sweeney Solheim	
South 28th 3320	1951	54301	Kessler, Clarence E.	C	E-4 279	Kessler, Clarence E.	
South 28th 3323	1941	35002	Solheim, S.A./Penton, H. M.	C	E-4 262	Bookstrom, Fred. C. (Margaret)	VP Newberg & Bookstrom
South 28th 3330	1950	54085	Kessler, Clarence E.	C	E-4 280	Kessler, Clarence E.	
South 28th 3333	1941	34587	Unthank, J. O./Miller, A.W. Co.	C	E-4 261	Mattson, Russell C. (Betty)	attorney
South 28th 3340	1941	34901	Unthank, J. O./Miller, A. W. Co.	C	E-4 281	Miller, A. W. Inc./Cook, Wilford (Edna)	unit head, FSA
South 28th 3345	1939	30562	Davis, Ellery Jr./Davies, Robt.	C	E-4 260	Davies, Thomas M. (Faith)	attorney
South 28th 3400	1954	63726	Chapin, Lee	C	E-4 282	Chapin, Lee	
South 28th 3405	1939	31346	Sweeney Construction Co.	C	E-4 259	Sweeney Constr. Co./ Rosenblum, Max (Evelyn)	dept. mngr, Magee's
South 28th 3415	1955	66178	Chapin, Lee	C	E-4 258	Chapin, Lee	
South 28th 3421	1949	50593	Jensen, A. T.	C	E-4 257	Jensen, A. T.	
South 28th 3424	1951	55529	Dietrich, Carl J.	C	E-4 283	Hyland, John	
South 28th 3434	1942	35818	Hazen, N. B./Penton, H. M.	C	E-4 232	Hallett, E. Sheldon	
South 28th 3500	1952	59206	Hock, Adolph Jr.	C	E-4 284	Hock, Adolph Jr.	
South 28th 3501	1958	72389	Aitken, Martin/Sampson Const.	C	E-4 256	Sweeney, Thomas	
South 29th 2911	1935	23631	Sweeney & Co.	C	E-4 52	Fenton, William (Helen)	Sec/Treas. IA-NE Light & Power

**United States Department of the Interior
National Park Service**

**National Register of Historic Places
Continuation Sheet**

Section number 7 Page 34

Boulevards Historic District

Name of Property

Lancaster County, Nebraska

County and State

Address	BP Date	BP #	Builder/Architect	Status	NeHBS LC13:	Occupant	Occupation
South 29th 2915	1937	25745	Petersen, Ervin E.	C	E-4 53	Patterson, Chas (Ruth)	UNL philosophy professor
South 29th 2929	1941	34642	Wohlfarth, Carl A.	C	E-4 54	Davey, Seldon (Helen)	insurance clerk
South 29th 3100	1951	54429	Hock Jr., Adolf	C	E-4 159		
South 29th 3125	1940	31753	Unthank, J. O./Miller, A. W. Co.	C	E-4 155	Albers, Robert (Eunice)	economist, Fed. Soil Conservation Service
South 29th 3135	1941	33861	Unthank, J. O./Miller, A. W. Co.	C	E-4 154	Ericson, Alice	widow
South 29th 3145	1940	31655	Unthank, J. O./Miller, A. W. Co.	C	E-4 153	Schiefen, Ted (Katherine)	Kath., secty to UNL dean
South 29th 3200	1947	46775	Steele, W. F., Co.	C	E-4 302	Felton & Kysar	
South 29th 3210	1947	46708	Solheim/Duff-Bruning	C	E-4 303	Felton & Kysar	
South 29th 3219	1941	34589	Unthank, J. O./Miller, A.W. Co.	C	E-4 301	Miller, A. W. Co.	
South 29th 3220	1947	46451	Potter, Harold C./Steel, W. F. Co.	C	E-4 304	Felton & Kysar	
South 29th 3226	1947	44573	Gibson, R. W.	C	E-4 305	Gibson, R. W.	
South 29th 3227	1942	35919	Unthank, J. O./Miller, A.W. Co.	C	E-4 300	Miller, A. W. Co.	
South 29th 3232	1941	34590	Wohlfarth, Carl A.	C	E-4 306	Dworak, Mr. & Mrs. J. E.	Dwork Denture Lab
South 29th 3235	1942	35794	Unthank, J. O./Miller, A.W. Co.	C	E-4 299	Miller, A. W. Co.	
South 29th 3300	1940	31676	Unthank, J. O./Miller, A.W. Co.	C	E-4 308	Miller, A. W. Co./Graham, Duane (Edythe)	creditman, Continental Oil Company
South 29th 3303	1941	33856	Brown, H. A.	C	E-4 297	Brown, H. A./Barth, Benj.	Barth Drug store
South 29th 3310	1940	33762	Unthank, J. O./Miller, A.W. Co.	C	E-4 309	Miller, A. W. Co./Loesch, Arth. (Gertrude)	mng, Underwriters Adjusting Co.
South 29th 3315	1940	32800	Brown, H. A.	C	E-4 296	Brown, H. A./Rowe, Geo.	insurance
South 29th 3316	1940	31684	Unthank, J. O./Miller, A. W. Co.	C	E-4 310	Miller, A. W. Co./Wescott, Edgar (Jean)	advertising mng, Bankers Life Insurance Co.
South 29th 3319	1940	31764	Brown, H. A.	C	E-4 295	Brown, H. A./Weston, Clifford (Myrtle)	asst cashier, 1st Nat'l Bank
South 29th 3329	1941	34178	Dean, John E.	C	E-4 294	Dean, John E.	
South 29th 3330	1940	33397	Solheim, Mrs. Selmer A.	C	E-4 311	Solheim, Mrs. Selmer A./Anderson, Jay (Gladys)	claims adjuster, The Travellers
South 29th 3333	1941	34962	Solheim, S. A./Dean, John E.	C	E-4 293	Dean, John E.	
South 29th 3340	1941	35450	Solheim, Selmer A.	C	E-4 312	Sweeney Constr. Co.	
South 29th 3344	1941	35319	Unthank, J. O./Miller, A.W. Co.	C	E-4 313	Saylor, Galen S.	
South 29th 3345	1941	34868	R. I. Lumber Co./Dean, John E.	C	E-4 238	Kokesch, Francis	
South 29th 3400	1946	42159	Solheim, S. A./Sweeney Const.	C	E-4 314	Sweeney Solheim	
South 29th 3401	1950	52085	Groh Bros.	C	E-4 292	Weber, Dr. Harry H.	
South 29th 3408	1940	32893	Hoesch, Albert W.	C	E-4 315	Ress, Otto J.	

**United States Department of the Interior
National Park Service**

**National Register of Historic Places
Continuation Sheet**

Boulevards Historic District

Name of Property

Lancaster County, Nebraska

County and State

Section number 7 Page 35

Address	BP Date	BP #	Builder/Architect	Status	NeHBS LC13:	Occupant	Occupation
South 29th 3409	1946	42161	Solheim, S. A./Sweeney Const.	C	E-4 291	Sweeney Solheim	
South 29th 3415	1950	no permit	unknown	C	E-4 290	Sweeney, Tom	Sec. Sweeney & Co., real estate
South 29th 3420	1941	35352	Hoesch, Albert W.	C	E-4 316	Hoesch, Albert W.	
South 29th 3427	1940	32576	Solheim, S./Johnson Cash Way	C	E-4 289	Watson, H. K.	
South 29th 3430	1954	63532	McEachen, Gertrude	C	E-4 317	McEachen, Gertrude	
South 29th 3437	1951	55260	Phillips, Hugh L.	C	E-4 288	Phillips, Hugh L.	
South 29th 3500	1950	53570	Fullagar, Walter L.	C	E-4 318	Wagner, Dr.	
South 29th 3507	1947	46396	Earley, C. C.	C	E-4 287	Wells, D. E.	
South 29th 3528	1946	42273	Solheim, S. A./Sweeney Const.	C	E-4 319	Sweeney Solheim	
South 30st 3100	1975	115452	Haberlan Assoc.	NC	E-4 170	Linscott, Don	commercial real estate
South 30th 3105	1952	57565	Koupal, Howard	C	E-4 162		
South 30th 3117	1937	27192	Unthank, John O.	C	E-4 163		
South 30th 3200	1951	54249	Phillips, Hugh L.	C	E-4 339	Phillips, Hugh L.	
South 30th 3201	1951	56557	Phillips, Hugh L.	C	E-4 338	Phillips, Hugh L.	
South 30th 3210	1946	42959	Pierson, A. E.	C	E-4 340	Stenten, Bill	
South 30th 3211	1938	28409	Miller, A. W. Co.	C	E-4 337	Miller, A. W. Co.	
South 30th 3219	1939	29908	Unthank, J. O./Miller, A.W. Co.	C	E-4 336	Miller, A. W. Co.	
South 30th 3220	1939	31230	Pierson, A. E.	NC	E-4 341	Thorson, Harold	
South 30th 3225	1938	27663	Unthank, J. O./Miller, A.W. Co.	C	E-4 335	Miller, A. W. Co.	
South 30th 3232	1939	no permit	unknown	C	E-4 342		
South 30th 3235	1939	30038	Unthank, J. O./Miller, A.W. Co.	C	E-4 334	Rosenthal, J. E.	
South 30th 3242	1948	48886	P & B Investment Co.	C	E-4 343	P & B Investment Co.	
South 30th 3245	1939	31569	Unthank, J. O./Miller, A.W. Co.	C	E-4 333	Miller, A. W. Co.	
South 30th 3300	1938	28788	Unthank, J. O./A. W. Miller Co.	C	E-4 231		
South 30th 3307	1942	35831	Solheim, Selmer A.	C	E-4 331	Solheim, Selmer	
South 30th 3310	1946	42170	Solheim, S. A./Sweeney Const.	C	E-4 344	Sweeney Solheim	
South 30th 3319	1939	31485	Sweeney Construction Co.	C	E-4 330	Sweeney Constr. Co.	
South 30th 3320	1950	53466	Phillips, Hugh L.	C	E-4 345	Phillips, Hugh L.	
South 30th 3330	1954	64112	Hemphill, Ben F./Anderson, MW	C	E-4 346	Pieper, Mr&Mrs Wm	
South 30th 3333	1941	35607	Solheim, S.A./Penton, H.M.	C	E-4 329	Davie, Dr. Fred.	

**United States Department of the Interior
National Park Service**

**National Register of Historic Places
Continuation Sheet**

Boulevards Historic District

Name of Property

Lancaster County, Nebraska

County and State

Section number 7 Page 36

Address	BP Date	BP #	Builder/Architect	Status	NeHBS LC13:	Occupant	Occupation
South 30th 3337	1941	35741	Solheim, Selmer A.	C	E-4 328	Solheim, Selmer	
South 30th 3344	1951	55776	Finke, Kenneth	C	E-4 347	Baxter, Everett E.	
South 30th 3345	1938	28913	Miller, A. W. Co.	C	E-4 327	Miller, A. W. Co.	
South 30th 3400	1948	48944	Jensen, A. T.	C	E-4 348	Rosenblum, Max M.	
South 30th 3401	1941	42173	Solheim, S. A./Sweeney Const.	C	E-4 326	Sweeney Solheim	
South 30th 3414	1939	31026	Schaumberg/Fullagar, W. G.	C	E-4 349	Askey, Dr. H. A.	
South 30th 3415	1951	55300	Otto, Louis D.	C	E-4 325	Otto, Louis D.	
South 30th 3424	1948	48620	Self Constr. Co.	C	E-4 350	Cather, Myers B.	
South 30th 3425	1941	34588	Unthank, J. O./Miller, A.W. Co.	C	E-4 324	Unthank, Mr.&Mrs. J. O.	
South 30th 3434	1930	no permit	unknown	C	E-4 351		
South 30th 3435	1946	43388	Unthank, John/Westcoff	C	E-4 323	Seward, Harry	
South 30th 3500	1950	52737	Cornell & Sampson	C	E-4 352	Sweeney, Tom	
South 30th 3510	1949	50763	Penton, H. M.	C	E-4 353	Harper, Co. H. C.	
South 31st 2829	1939	31361	Davis & Wilson	C	E-4 13	Rohkar, George	construction
South 31st 2835	1928	17417	May, Joy E.	C	E-4 14		
South 31st 2900	1925	14730	Rathbone Carpenter Co.	C	E-4 188		
South 31st 3003	1940	32235	Pierson, A. E.	C	E-4 84	Carveth, Walter (Rachel)	physician
South 31st 3025	1937	26079	Miller, A.W. Co., Inc.	C	E-4 85	Smith, Ernest (Eva)	VP, gen mng, Magee's clothing
South 31st 3043	1937	26240	Miller, A.W. Co., Inc.	C	E-4 86	Beesley, Donald (Sharlet)	mechanic, Lincoln Wheel & Brake Service
South 31st 3100	1937	26407	Leverson, E.R.	C	E-4 182		
South 31st 3111	1935	23385	Miller, A.W. Co., Inc.	C	E-4 173		
South 31st 3112	1937	25746	Craig, Fritz	C	E-4 181		
South 31st 3124	1928	17754	Miller & Craig	C	E-4 180		
South 31st 3125	1935	23469	Miller, A.W. Co., Inc.	C	E-4 174		
South 31st 3130	1936	25408	Hazen, N. Bruce	C	E-4 179		
South 31st 3133	1936	25357	Miller, A.W. Co., Inc.	C	E-4 175		
South 31st 3145	1937	25690	Miller, A.W. Co., Inc.	C	E-4 176		
South 31st 3150	1934	22180	Miller, A. W. Jr. / Larson, Carl	C	E-4 178		
South 31st 3160	1935	24079	Miller, A.W. Co., Inc.	C	E-4 177		
South 31st 3200	1936	25549	Miller, A.W. Co., Inc.	C	E-4 239		
South 31st 3201	1935	22468	Miller & Larson	C	E-4 244	Paul, Herbert J. (Carrie)	adj genl Neb Natl Guards
South 31st 3215	1936	24167	Miller, A.W. Co., Inc.	C	E-4 245	Whitten, John C. (Vivian)	Asst Trust Officer First Trust Co
South 31st 3223	1935	22287	Miller & Larson	C	E-4 246	Russell, Robert C. (Helen)	v-pres Lawlor Sporting Goods Co

**United States Department of the Interior
National Park Service**

**National Register of Historic Places
Continuation Sheet**

Boulevards Historic District

Name of Property

Lancaster County, Nebraska

County and State

Section number 7 Page 37

Address	BP Date	BP #	Builder/Architect	Status	NeHBS LC13:	Occupant	Occupation
South 31st 3235	1936	24169	Miller, A.W. Co., Inc.	C	E-4 247	Ress, William N. (Alvina T)	Ress Machine & Supply Co
South 31st 3245	1937	25692	Miller, A.W. Co., Inc.	C	E-4 248	Baeke, Henry H. (Clara V)	sec Lincoln Drug Co
South 31st 3250	1919	8201	Lee, Stella P.	C	E-4 241	Lee, James A. (Stella)	Plasterer
South 31st 3260	1919	8208	Chambers, Oscar Y.	C	E-4 242	Sturdevant, Ralph S. (Jessie L)	Dentist 207 Chapin bldg.
South 31st 3268	1941	34724	Hazen, N. Bruce	C	E-4 243	Johnson, Edgar N. (Emily)	assoc prof U of N
South 31st 3280	1940	33776	Unthank, John O.	C	E-4 249	Ireland, Ralph L. (Marian B)	prof U of N
South 31st 3303	1935	23599	Kaiser, John H.	C	E-4 387	Holtz, Harold F. (Vina)	mgr Cochrane Construction Co
South 31st 3315	1936	24417	Petersen, Ervin E.	C	E-4 388	Torkelson, Torkel (Frances)	
South 31st 3335	1928	18167	Fullagar, William G.	C	E-4 389	Groth, Fred (Ethel A)	Fred Groth Ins Agency
South 31st 3400	1960	76618	unknown	NC	E-4 359		
South 31st 3401	1951	55797	Chalmers & Gorton	C	E-4 358	Chalmers, John H.	
South 31st 3410	1920	no permit	altered throughout '50s	NC	E-4 360		
South 31st 3417	1951	56012	Clark & Enersen/Duerschner, A.	C	E-4 357	Duerschner, Art	
South 31st 3420	1953	61313	Kessler, Clarence E.	C	E-4 361	Kessler, C. E.	
South 31st 3500	1953	61314	Kessler, Clarence E.	C	E-4 362	Kessler, C. E.	
South 31st 3505	1954	62076	Kessler, Clarence E.	C	E-4 356	Kessler, C. E.	
South 31st 3515	1954	64891	Kessler, C. E./later garage added	NC	E-4 355	Kessler, C. E.	
South 31st 3520	1953	61315	Kessler, Clarence E.	C	E-4 363	Kessler, C. E.	
South 31st 3535	1954	62078	Kessler, Clarence E.	C	E-4 354	Kessler, C. E.	
South 31st 3540	1953	61316	Kessler, Clarence E.	C	E-4 364	Kessler, C. E.	
South Street 2201	1908	No BP	Unknown	C	D-5 044	Sias, Ernest (Alma)	jeweler & carpenter
South Street 2211	1925	13432	Wood, W.N.	C	D-5 045		
South Street 2219	1915	5883	Alexander, John M.	C	D-5 046		
South Street 2231	1923	11955	Allen, H.D.	C	D-5 047		
South Street 2235	1909	3430	Lindle, Emma	C	D-5 48		
South Street 2243	1921	8957	Young, Jr., Fred	C	D-5 49		
South Street 2301	1946	42055	Solheim, Selmer A.	C	D-5 50		
South Street 2311	1926	15255	Vorhees, M.E.	C	D-5 51		
South Street 2419	1912	4808	Ferrier, Al Co.	C	D-5 54		
South Street 2425	1919	7933	NE Building & Investment Co.	C	D-5 55		
South Street 2435	1910	3879	Masoni, F.A.	C	D-5 56		
South Street 2501	1913	5006	Cordner, J.G./J. A. Watson	C	D-5 459	Woods, Mark W.	Woods Bros. Cos.
South Street 2675	1955	64990	Aitken, Martin	C	D-5 572	South Branch (City) Library	
South Street 2701	1921	9037	Harvey Enslow Lumber Co.	C	E-5 322	Wheeler, Elmer J.	Burlington RR car inspector pres., Colonial Red Cedar Chest Co.
South Street 2711	1923	12010	Rogers, Walter	C	E-5 321	Reed, N. E.	
South Street 2717	1936	24625	probably moved-in	C	E-5 320	Julius Zelen	Western Elec. Supply Co.
South Street 2725	1918	7574	Rathbone Co., Harvey	C	E-5 319	Van Anrooy, Peter (Louise)	traveling agent
South Street 2727	1922	10380	Guardian Mortgage Securities Co.	C	E-5 318	Heitkotter, Benj., Jr.	Heitkotter Market
South Street 2741	1919	7661	Chambers, Oscar Y.	C	E-5 317	Waggoner, Stella	
South Street 2801	1926	15120	Guardian Mortgage Securities Co.	C	E-5 316	Guardian Mtge Security Co.	rental
South Street 2811	1922	9645	Star Real Estate Co.	C	E-5 315	Mengshol, John O.	buyer, Golds Dept. store
South Street 2815	1922	10383	Star Real Estate Co.	C	E-5 314	Smith, E. E.	

**United States Department of the Interior
National Park Service**

**National Register of Historic Places
Continuation Sheet**

Boulevards Historic District

Name of Property

Lancaster County, Nebraska

County and State

Section number 7 Page 38

Address	BP Date	BP #	Builder/Architect	Status	NeHBS LC13:	Occupant	Occupation
South Street 2829	1923	11119	Stewart, Owen	C	E-5 313	Bell, Samuel J.	treas., Culberson, Roe & Bell
South Street 2923	1922	9640	Brownson, F.E.	C	E-5 223		
South Street 2931	1919	8241	Sheridan Park Inv. Co.	C	E-5 222		
South Street 2937	1923	11199	Rathbone Carpenter Co.	C	E-5 221		
South Street 2945	1947	46682	Steele, W. F. Co., Inc.	C	E-5 220		
South Street 2955	1919	7798	Star Real Estate Co.	C	E-5 219		
South Street 3001	1922	9899	Rathbone Carpenter Co.	C	E-5 218		
South Street 3011	1922	10656	Rathbone Carpenter Co.	C	E-5 217	LaFler, Rex B.	operator, Western Union
South Street 3025	1919	7976	Standard Securities Corp	C	E-5 216	Waugh, Joseph A. (Lena)	Conductor, CB&Q RR
South Street 3033	1923	10818	Rathbone Carpenter Co.	C	E-5 215		
South Street 3033	1954	64273	Chapin, Lee	C	E-5 215		
Stratford Ave 2700	1920	8723	Wright, George L.	C	E-5 91		
Stratford Ave 2701	1957	72565	Hazen & Robertson	C	E-5 90		
Stratford Ave 2717	1922	9997	Hanson, Paul G.	C	E-5 89		
Stratford Ave 2724	1918	7390	Rathbone Co., Harvey	C	E-5 92		
Stratford Ave 2729	1923	11435	Rathbone Co., Harvey	C	E-5 88		
Stratford Ave 2741	1925	14213	Bstandig, Ed J.	C	E-5 87		
Stratford Ave 2744	1917	7081	Kneeland, A.A.	C	E-5 93		
Stratford Ave 2753	1925	13655	Alexander, John M.	C	E-5 86		
Stratford Ave 2765	1923	11878	Harver	C	E-5 65		
Stratford Ave 2801	1924	12695	Kincaide, Jennie A.	C	E-5 85		
Stratford Ave 2808	1926	16073	Joy, George C.	C	E-5 94		
Stratford Ave 2815	1925	14166	Robey, Frank A.	C	E-5 84		
Stratford Ave 2825	1923	11090	Woods, C.H.	C	E-5 83		
Stratford Ave 2828	1920	8435	Ridgway, George	C	E-5 95		
Stratford Ave 2834	1920	8431	Ridgway, George	C	E-5 96		
Stratford Ave 2900	1927	17023	Miller & Craig	C	E-5 97		
Stratford Ave 2901	1925	14421	Crown Const. Co.	C	E-5 80		
Stratford Ave 2921	1925	13320	Robertson, George M.	C	E-5 79		
Stratford Ave 2939	1917	7211	Rathbone Co., Harvey	C	E-5 78		
Stratford Ave 2942	1917	7064	Rathbone Co., Harvey	C	E-5 98		
Stratford Ave 2947	1926	14934	Whalen, C.L.	C	E-5 208		
Stratford Ave 2955	1927	16930	Alexander, John M.	C	E-5 76		
Stratford Ave 3000	1917	7210	Rathbone Co., Harvey	C	E-5 99		
Stratford Ave 3001	1917	6976	Parks, William N.	C	E-5 75		
Stratford Ave 3004	1918	7551	Parks, William N.	C	E-5 100		
Stratford Ave 3015	1922	10629	Rathbone Carpenter Co.	C	E-5 74		
Stratford Ave 3021	1925	13326	Larsen, Clarence H.	C	E-5 73		
Stratford Ave 3024	1919	7949	Erickson/Park, Wm. M.	C	E-5 101	Dobson, Ellen	mother of Arthur Dobson
Stratford Ave 3032	1919	8240	Sheridan Park Inv. Co.	C	E-5 102		
Stratford Ave 3039	1923	11756	Aberman, Charles	C	E-5 72		
Stratford Ave 3040	1924	12178	Rathbone Carpenter Co.	C	E-5 103		
Stratford Ave 3045	1925	13343	Burford & Randolph	C	E-5 71		
Stratford Ave 3050	1925	14091	Grubb, W.G.	C	E-5 104		

United States Department of the Interior
National Park Service

National Register of Historic Places
Continuation Sheet

Boulevards Historic District

Name of Property

Lancaster County, Nebraska

County and State

Section number 7 Page 39

Address	BP Date	BP #	Builder/Architect	Status	NeHBS LC13:	Occupant	Occupation
Stratford Ave 3053	1922	10311	Hanson, Paul G.	C	E-5 70		
Stratford Ave 3060	1928	18166	Fullagar, William G.	C	E-5 105		
Stratford Ave 3067	1919	8180	Sheridan Park Inv. Co.	C	E-5 69		
Stratford Ave 3070	1923	11976	Rathbone Carpenter Co.	C	E-5 106		
Stratford Ave 3080	1924	13091	Rathbone Carpenter Co.	C	E-5 107		
Stratford Ave 3085	1940	31716	Unthank, John O.	C	E-5 68		
Stratford Ave 3095	1925	14118	Rathbone Carpenter Co.	C	E-5 67		
Summit Blvd 2906	1927	16268	Rathbone Carpenter Co.	C	E-4 189		
Summit Blvd 2920	1936	25594	Miller, A.W. Co., Inc.	C	E-4 190		
Summit Blvd 3000	1926	15521	Rathbone Carpenter Co.	C	E-4 191		
Summit Blvd 3005	1925	14546	Ryman, C.W.	C	E-4 187		
Summit Blvd 3010	1928	17299	Pierson, A. E.	C	E-4 192		
Summit Blvd 3011	1931	20048	Pierson, A. E.	C	E-4 186		
Summit Blvd 3017	1926	15763	Rathbone Carpenter Co.	C	E-4 185		
Summit Blvd 3020	1927	17181	Hirsch, O.C.	C	E-4 193		
Summit Blvd 3024	1939	29909	Unthank, John O.	C	E-4 194		
Summit Blvd 3030	1925	14005	Rathbone Carpenter Co.	C	E-4 195		
Summit Blvd 3040	1939	30114	Bstandig, Ed J.	C	E-4 196		
Summit Blvd East 3201	1952	57613	Kessler, Clarence E.	C	E-4 217	Kessler, C. E.	
Summit Blvd East 3211	1952	57614	Kessler, C. E.	C	E-4 218	Kessler, C. E.	
Summit Blvd East 3220	1959	75336	Hampton, Joseph	NC	E-4 213	Beezley, Paul	
Summit Blvd East 3221	1952	57615	Kessler, C. E.	C	E-4 219	Kessler, C. E.	
Summit Blvd East 3227	1956	68470	Colbert, J. P.	C	E-4 214		
Summit Blvd East 3230	1957	71844	Hof, Claud R./Hampton, Joe	C	E-4 212	Hampton, Joe	
Summit Blvd East 3231	1952	57616	Kessler, C. E.	C	E-4 220	Kessler, C. E.	
Summit Blvd East 3240	1961	78242	Dalton Const. Co.	NC	E-4 211	Bartlett, Ray L.	
Summit Blvd East 3241	1952	57617	Kessler, C. E.	C	E-4 221	Kessler, C. E.	
Summit Blvd East 3251	1952	58959	Porter, James/Kessler, C. E.	C	E-4 222	Kessler, C. E.	
Summit Blvd So 3223	1957	70530	Assenmacher Const. Co.	C	E-4 208	Edgren, Robert A.	
Summit Blvd So 3235	1954	62351	Ramsey, George	C	E-4 209	Ramsey, George	
Summit Blvd So 3250	1954	63311	Cornell-Sampson	C	E-4 210	Wilson, Robert	
Summit Blvd So 3265	1953	60581	Kessler, C. E.	C	E-4 207	Kessler, C. E.	
Summit Blvd West 3101	1953	58433	Penton, H. M.	C	E-4 198		
Summit Blvd West 3125	1963	83834	VerMaas, John D.	NC	E-4 199	Martin, Roy	
Summit Blvd West 3135	1952	58132	Vogel, Ed	C	E-4 200	Eckle, Carl F.	
Summit Blvd West 3145	1960	77537	Lindburg, Les	NC	E-4 201	Lindburg, Les	
Summit Blvd West 3211	1962	80938	Strauss Bros.	NC	E-4 202	Stemm, Robert M.	
Summit Blvd West 3215	1953	60294	Fogerty, Edward J.	C	E-4 203	Fogerty, Edward J.	
Summit Blvd West 3225	1955	67480	Witt & Juekette	C	E-4 204	Saski, Witold	
Summit Blvd West 3226	1952	58955	Kessler, C. E.	C	E-4 226	Kessler, C. E.	
Summit Blvd West 3234	1952	58956	Kessler, C. E.	C	E-4 225	Kessler, C. E.	
Summit Blvd West 3242	1952	58957	Kessler, C. E.	C	E-4 224	Kessler, C. E.	
Summit Blvd West 3245	1962	82269	Brandt, Norval	NC	E-4 205	Knudsen, Mr. & Mrs. Richard	
Summit Blvd West 3252	1952	58958	Kessler, C. E.	C	E-4 223	Kessler, C. E.	

United States Department of the Interior
National Park Service

National Register of Historic Places
Continuation Sheet

Section number 7 Page 40

Boulevards Historic District

Name of Property

Lancaster County, Nebraska

County and State

Address	BP Date	BP #	Builder/Architect	Status	NeHBS LC13:	Occupant	Occupation
Summit Blvd West 3255	1966	93604	Bischof, Leo/Strauss Bros.	NC	E-4 206	Trend Homes	
Van Dorn 2135	1947	45314	Schwarck, James D.	C	D-4 38	Gearke, Earl H. (Helene C)	slsmn
Van Dorn 2147	1947	45750	Jensen, Dean L.	C	D-4 67	Loesch, Truman L. (Marie J)	sec-treas City Market Inc/ Marie - buyer Ben Simon & Sons
Van Dorn 2200	1947	46777	Reed, Irl	C	D-5 571		
Van Dorn 2201	1947	46781	Schwarck, James D.	C	D-4 14	Gartner, Robert D. (Hulda M)	Gartner Foot Clinic
Van Dorn 2210	1939	29245	Wohlfarth, Carl A.	C	D-5 570		
Van Dorn 2211	1947	46783	Schwarck, James D.	C	D-4 15	Levy, Sidney M. (Mary)	jwlr 1340 O St
Van Dorn 2222	1950	54166	Meyer, R.L.	C	D-5 569		
Van Dorn 2223	1946	42636	Solheim, Selmer A.	C	D-4 16	Finkle, Beverly A. (Edna)	phys 1419-21 Sharp bldg
Van Dorn 2242	1935	23949	Trotten, Tobe	C	D-5 567		
Van Dorn 2300	1925	13729	Robey, Frank A.	C	D-5 566		
Van Dorn 2330	1928	17352	Fiske, Ferdinand C.	C	D-5 565		
Van Dorn 2345	1947	46774	Anderson, M.W.	C	D-4 17	deBrown, Leroy H. (Jane R)	mgr
Van Dorn 2401	1924	13129	Assenmacher, W.J.	C	D-4 20	Mattison, Raymond E. (Katheryn)	Gen. Mngr. Lincoln Telegraph & Telephone Co.
Van Dorn 2425	1933	21093	Bullock, R.A.	C	D-4 21	Desmond, J. Gerald (Aleen)	Desmond Lumber Co - 944 N 22nd
Van Dorn 2525	1926	15524	Peterson, Frank	C	D-4 82	Peterson, Frank A. (Selma E)	Lawyer 444 Natl Bank of Commerce Bldg
Van Dorn 2535	1928	17977	Alexander, John M.	C	D-4 83	Day, William (Lulu)	Travelers Ins Co
Van Dorn 2545	1932	20780	Burnett, Knox F.	C	D-4 84	Burnett, Knox F. (Lela)	archit 525 S 13th
Van Dorn 2551	1924	12736	Rogers, Walter	C	D-4 85	Merritt, Gerald (Faye)	D H Merritt & Sons
Van Dorn 2557	1925	14381	Robey, Frank A.	C	D-4 86	Fox, Jay B. (Gladys E)	mgr F W Woolworth Co
Van Dorn 2573	1925	13897	Fullagar, William G.	C	D-4 87	Harrison Robert H. (Edith H)	
Van Dorn 2601	1937	26624	Petersen, Ervin E.	C	D-4 121	Johnson, Troval P. (Grace M)	prin College View High School
Van Dorn 2615	1926	15039	Hanson, Paul G.	C	D-4 129	Perry, Roscoe S. (Genevieve)	pres. R S Perry Lmbr & Coal
Van Dorn 2627	1925	13866	Hanson, Paul G.	C	D-4 130	Lemon, William L. (Margt E)	aud Lincoln Tel & Tel Co
Van Dorn 2645	1925	13541	Hanson, Paul G.	C	D-4 131	Hollenbeck, Frank (Alice)	physician
Van Dorn 2700	1927	16232	Meginnis & Schaumberg	C	E-5 42		
Van Dorn 2710	1952	57090	Cook, George, Const. Co.	C	E-5 41		
Van Dorn 2720	1927	16820	Fullagar, William G.	C	E-5 40	Hyland, Leo S.	lumberman
Van Dorn 2731	1927	17169	Meginnis & Schaumberg	C	E-4 4		
Van Dorn 2736	1931	20441	Hazen, N. Bruce	C	E-5 39	Baylor, F. B. & Georgia	attorney
Van Dorn 2740	1924	13084	Davis & Wilson	C	E-5 38	Davis, Ellery L.	architect, Davis & Wilson
Van Dorn 2801	1925	13488	Schaumberg	C	E-4 5		
Van Dorn 2819	1924	13115	Meginnis & Schaumberg	C	E-4 6		
Van Dorn 2829	1924	13252	Miller & Craig	C	E-4 7		
Van Dorn 2845	1922	9608	Baker, J.	C	E-4 8		
Van Dorn 2929	1929	18919	Nootz, C.A.	C	E-4 9		
Van Dorn 2930	1929	19036	Hazen, N. Bruce/Bstandig, EJ	C	E-5 12	Williams, John & Kathryn	physician, ENT
Van Dorn 2945	1957	69421	Peterson, A.G.	C	E-4 10		
Van Dorn 3100	1923	11297	Mutz, Chris	C	E-5 108		
Van Dorn 3132	1941	33785	Petersen, Ervin E.	C	E-5 329		

**United States Department of the Interior
National Park Service**

**National Register of Historic Places
Continuation Sheet**

Boulevards Historic District

Name of Property

Lancaster County, Nebraska

County and State

Section number 7 Page 41

Address	BP Date	BP #	Builder/Architect	Status	NeHBS LC13:	Occupant	Occupation
Van Dorn 3166	1922	10453	Wright, W. R.	C	E-5 407		
Van Dorn 3170	1920	no permit	unknown	C	E-5 324	Babcock, Elmer (Ida)	physician
Van Dorn 3171	1924	13029	Miles, George	C	E-4 365		
Van Dorn 3175	1924	12059	Zimmer, P. F.	NC	E-4 366		
Van Dorn 3176	1941	34619	Wohlfarth, Carl A.	C	E-5 408	Schleicher, G. G.	
Van Dorn 3185	1951	55470	Johnson, Harold J.	C	E-4 367		
Van Dorn 3195	1939	31298	Shurtleff, Woodruff	C	E-4 368		
Van Dorn 3199	1939	31616	Shurtleff, Woodruff	C	E-4 369		
Van Dorn 3200	1939	31417	unknown	C	E-5 409	Arnold, Fred & Elizabeth	
Van Dorn 3210	1940	31679	Shurtleff, Woodruff	C	E-5 410		
Van Dorn 3226	1920	8678	Seifert, Charles E.	C	E-5 411		
Van Dorn 3236	1956	69477	Tyler, Harold	C	E-5 412		
Van Dorn 3244	1954	62438	Turrentine, J. F.	C	E-5 413		
Van Dorn 3260	1958	73006	Christofferson, G. L.	C	E-5 414		
Wendover Ave 2927	1924	12148	Nootz, C.A.	C	E-5 164		
Wendover Ave 2928	1927	16746	Hanson, Paul G.	C	E-5 173		
Wendover Ave 2933	1923	10820	Rodgers, Burt	C	E-5 165		
Wendover Ave 2935	1923	11724	Rudeen, John	C	E-5 166		
Wendover Ave 2945	1923	11996	Star Real Estate Co.	C	E-5 167		
Wendover Ave 2948	1918	7318	Rathbone Co., Harvey	C	E-5 174		
Wendover Ave 2950	1921	9452	Ridgway, George	C	E-5 175		
Wendover Ave 2955	1922	10392	Rudeen, John	C	E-5 168		
Wendover Ave 3000	1941	34671	Petersen, Ervin E.	C	E-5 176		
Wendover Ave 3001	1920	8680	Hanson, Paul G.	C	E-5 169		
Wendover Ave 3009	1921	9149	Star Real Estate Co.	C	E-5 170		
Wendover Ave 3010	1926	15147	Larsen, C.M.	C	E-5 177		
Wendover Ave 3020	1923	11790	Burford & Randolph	C	E-5 178		
Wendover Ave 3027	1919	8179	Sheridan Park Inv. Co.	C	E-5 171		
Wendover Ave 3030	1939	29453	Petersen, Ervin E.	C	E-5 179		
Wendover Ave 3034	1923	11039	Lowell, E.L.	C	E-5 180		
Wendover Ave 3035	1923	11398	Rathbone Carpenter Co.	C	E-5 172		
William St 2800	1947	46100	Elder, Wm E.	C	E-4 385		
William St 2816	1951	56619	Hof, Claud R.	C	E-4 384		
William St 2820	1955	65209	Chapin, Lee	C	E-4 383		
William St 2821	1950	51921	Turner, Alice	C	E-4 370		
William St 2838	1950	52954	Pegler, Don Jr.	C	E-4 382		
William St 2845	2000		Cook, Steve	NC	E-4 371		
William St 2848	1950	52237	Mahoney, J. Phillip	C	E-4 381		
William St 2850	1952	57064	Plochy, Ronald R.	C	E-4 380		
William St 2900	1951	54681	McGlossen, Bonnie	C	E-4 379		
William St 2901	1950	53255	Hinnis, W. L.	C	E-4 233		
William St 2911	1951	56653	Schultz, Richard K.	C	E-4 372		
William St 2920	1951	56618	Meirhenry, W. C.	C	E-4 378		
William St 2925	1950	52955	Trott, Grace A.	C	E-4 373		

United States Department of the Interior
National Park Service

National Register of Historic Places
Continuation Sheet

Boulevards Historic District

Name of Property

Lancaster County, Nebraska

County and State

Section number 7 Page 42

Address	BP Date	BP #	Builder/Architect	Status	NeHBS LC13:	Occupant	Occupation
William St 2931	1950	52539	Hartman, Ray	C	E-4 374		
William St 2940	1952	56841	Snyder, Wm J.	C	E-4 377		
William St 3000	1950	53299	Dean, John	C	E-4 376		
William St 3020	1951	54832	Gatenby & Son	C	E-4 375	McGlossen, Bonnie	
Winthrop Rd 2310	1951	54690	Pritz, Harold W.	C	E-5 362		
Winthrop Rd 2400	1950	54131	Palmer & Pritz	C	E-5 349		
Winthrop Rd 2410	1949	50713	Herriott, Bruce M.	C	E-5 350		
Winthrop Rd 2415	1950	54083	Moser, M. D.-Becker, S. S.	C	E-5 348		
Winthrop Rd 2420	1949	51152	Wilscom, Charles A.	C	E-5 351		
Winthrop Rd 2425	1951	54394	Moser, M. D.	C	E-5 347		
Winthrop Rd 2430	1951	56344	Moser, Melvin Dale	C	E-5 352		
Winthrop Rd 2435	1949	50485	Fiene, Oscar W.	C	E-5 346		
Winthrop Rd 2500	1953	61436	Shenk, William	C	E-5 378		
Winthrop Rd 2501	1951	56798	Johnson & Shafer	C	E-5 344		
Winthrop Rd 2515	1951	54432	Johnson & Shafer	C	E-5 343		
Winthrop Rd 2525	1949	50915	Johnson & Shafer	C	E-5 342		
Winthrop Rd 2601	1940	32659	Lincoln Housing Co.	C	E-5 340		
Winthrop Rd 2602	1950	52809	Schwartz, Arthur	C	E-5 444		
Winthrop Rd 2614	1949	50848	Sweeney-Solheim Co.	C	E-5 431		
Winthrop Rd 2615	1946	41890	Carter, Earl/Westcott, Lee W.	C	E-5 326	Lloyd Corp.	
Winthrop Rd 2619	1947	46343	Joy, George C.	C	E-5 339		
Winthrop Rd 2620	1944	39053	Sweeney-Solheim Co.	C	E-5 432		
Winthrop Rd 2621	1940	32678	Pauley, C. R.	C	E-5 338		
Winthrop Rd 2627	1940	31779	Lincoln Housing Co.	C	E-5 337		
Winthrop Rd 2630	1941	35359	Franklin, Morton J.	C	E-5 433		
Winthrop Rd 2631	1946	42561	Ames, John C.	C	E-5 336		
Winthrop Rd 2633	1939	30881	Lessenhop, John H.	C	E-5 335		
Winthrop Rd 2647	1950	52157	Ayres, Mr. Joyce	C	E-5 334		
Winthrop Rd 2700	1940	31761	Mahoney, J. Phillip	C	E-5 406		
Winthrop Rd 2703	1941	35485	Fisher, Carl L.	C	E-5 333		
Winthrop Rd 2707	1940	31880	Miller, L. A.	C	E-5 332		
Winthrop Rd 2715	1940	31774	Morgan, Fred W.	C	E-5 331		
Winthrop Rd 2727	1940	32450	Solheim, S. A./Sweeney Const.	C	E-5 330	Teal, Dr. Fritz	
Winthrop Rd 2808	1927	17161	Baker & Holder	C	E-4 38		
Winthrop Rd 2814	1926	15371	Rathbone Carpenter Co.	C	E-4 37		
Winthrop Rd 2820	1928	17472	Robey, Frank A.	C	E-4 36		
Winthrop Rd 2840	1926	15634	Fiske, Ferdinand C.	C	E-4 35		
Winthrop Rd 2850	1975	111741	Peterson Const. Co.	NC	E-4 34		
Woodleigh Ln 2501	1958	73105	Chapin, Lee	C	D-5 477	DeBrown, Frank	
Woodleigh Ln 2541	1956	68156	Aitken, Martin/Fullagar, Walt	C	D-5 476	Agee, Richard	
Woodleigh Ln 2600	1955	67046	Schaumberg & Freeman/Fullagar, Walter	C	D-5 472	Scott, Wardner	
Woodleigh Ln 2601	1959	74131	Aitken, Martin/Lindburg, Les	NC	D-5 475	Ames, Mrs. E. C.	
Woodleigh Ln 2620	1961	79465	Evans & Evans	NC	D-5 474		

**United States Department of the Interior
National Park Service**

**National Register of Historic Places
Continuation Sheet**

Boulevards Historic District

Name of Property

Lancaster County, Nebraska

County and State

Section number 7 Page 43

Address	BP Date	BP #	Builder/Architect	Status	NeHBS LC13:	Occupant	Occupation
Woodleigh Ln 2640	1956	68730	Dutton, H.J.	C	D-5 473	Martin, John H.	
Woodscrest Ave 2200	1948	47857	Allgood, R.C.	C	D-5 557	Allgood, Richard	brig. general, USArmy Reserve; exec sec, NE Assoc. Insurance Agents; jogger
Woodscrest Ave 2201	1923	10789	Rische, Albert E.	C	D-5 558	Foss, Frederick (Amelia)	mechanic, NE Buick
Woodscrest Ave 2210	1948	48282	Glenn, Robert	C	D-5 556	Glenn, Rbrt J. (Carole Jean)	mechanical engineer
Woodscrest Ave 2211	1949	50667	Wilscom, Charles A.	C	D-5 559	Redenbow, Lela	
Woodscrest Ave 2215	1942	35837	Johnson, A.L.	C	D-5 560	Peterson, Frank A.	Lanc. Cty & U. S. Atty for NE
Woodscrest Ave 2218	1954	64463	Cornell & Sampson	C	D-5 555	Linscott, J. H.	
Woodscrest Ave 2225	1941	35756	Johnson, A.L.	C	D-5 561	Fitts, Allen L. (Margaret)	mgr., Rock Island Labor Co
Woodscrest Ave 2226	1940	31708	Unthank, John O./Miller, A.W.Co.	C	D-5 554	Clements, L. D. (Gladys)	Super., State Voc. Ed.
Woodscrest Ave 2234	1921	9358	Bstandig, Ed J.	C	D-5 553	Beers, Mrs. H. P.	widow of William
Woodscrest Ave 2237	1919	8124	Fullagar, William G.	C	D-5 562	McGreer, John T.	director, Beatrice Foods
Woodscrest Ave 2242	1921	9409	Bstandig, Ed J.	C	D-5 552	Hoffman, Wm (Myrtle L.)	asst sales mngr, Gooch Mill
Woodscrest Ave 2310	1928	17473	Fiske, Ferdinand C./Hirsch, O.C.	C	D-5 551	Skiles, C. M.	lawyer, U. S. Commissioner
Woodscrest Ave 2323	1929	18628	Bstandig, Ed J.	C	D-5 563	Van Pelt, Robert	attorney
Woodscrest Ave 2330	1925	13957	Fiske, Meginnis & Schaumberg	C	D-5 550	Walt, Fred (Lela)	pres., Union Fire Ins. Co.
Woodscrest Ave 2331	1930	19859	Davis & Wilson	C	D-5 564	Aitken, Grace & Gertrude	teacher (Gertrude)
Woodscrest Ave 2401	1963	84189	Unknown	NC	D-5 491	Smith, Elwin T.	
Woodscrest Ave 2433	1919	7919	Parks, William N.	C	D-5 492	Everett, H. H. & Blanche	surgeon
Woodscrest Ave 2464	1919	8081	Larsen, C. H. & Co./Burford & Randolph	C	D-5 486	Raymond, Wm. H.	Raymond Bros, wholesale grocers
Woodscrest Ave 2465	1935	22412	Meginnis & Schaumberg/Robey, Frank A.	C	D-5 493	Campbell, John D.	insurance
Woodscrest Ave 2485	1922	10143	McArthur, Joseph G./Burford & Randolph	C	D-5 494	Faulkner, Bert & Eugenia	vp, gen mngr, Woods Bros Constr. Co.
Woodscrest Ave 2500	1925	13293	Fiske & Meginnis/Hirsch, O.C.	C	D-5 487	Hilton, David C. & Sarah	surgeon
Woodscrest Ave 2525	1951	56289	Unthank & Unthank/Anderson, MW	C	D-5 495	Rogers, Richard H.	
Woodscrest Ave 2540	1927	16699	Davis & Wilson/Assenmacher, W. J.	C	D-5 488	Caldwell, Fred	wholesale groceries & Franklin Ice Cream Co.
Woodscrest Ave 2600	1930	19394	Davis & Wilson/Olson Cnstrcn	C	D-5 501	Campbell, RE & Dorothy	pres., Miller & Paine
Woodscrest Ave 2601	1936	24494	Hazen, N. Bruce/Fullagar, WG	C	D-5 496	Thompson, J. C. (Florence)	physician
Woodscrest Ave 2635	1954	64001	Aitken, Martin/Anderson, M.W. Const. Co.	C	D-5 490	Ammon, Wm B.	
Woodscrest Ave 2636	1927	16183	Davis & Wilson/Alexander, John/landscape by E. Herminghaus	C	D-5 500	Miller, Donald	vp Miller & Paine
Woodscrest Ave 2645	1963	83769	Unthank & Unthank	NC	D-5 489	Forke, Avery & Dorothy	
Woodscrest Ave 2710	1921	9252	Meginnis/Joy, Geo. C.	C	D-5 499	Dorgan, J. T. & Caroline	vp Beatrice Creamery, pres. Whitebrest Coal & Lmbr
Woodscrest Ave 2750	1928	17682	Davis & Wilson/Baker & Holder	C	D-5 498	Seacrest, Joseph W.	pres., Lincoln Journal etc.
Woodscrest Ave 2770	1933	21171	Davis & Wilson/Rokahr, E & Son	C	D-5 497	Woodruff, R. D. & Lucille	Woodruff Printing Co.
Woodsdale Blvd 2028	1937	26265	Miller, A.W. Co., Inc.	C	E-4 87	Cadwallader, C. Ned (Audrey)	sec/treas Cadwallader Fur Co.
Woodsdale Blvd 2120	1947	46190	Bowen, Leslie	C	D-4 31	Jordan, Harry G. (Stella)	furn 2701 O St.
Woodsdale Blvd 2130	1948	47349	Unthank, John O.	C	D-4 32	Mowbray, J. William (Jeanne M)	sec-treas-mgr M&L Disrtibuting Co
Woodsdale Blvd 2200	1938	28627	Meginnis & Schaumberg	C	D-4 26	Holland, Lye C. (Dorothy)	Chambers Holland & Locke

**United States Department of the Interior
National Park Service**

**National Register of Historic Places
Continuation Sheet**

Section number 7 Page 44

Boulevards Historic District

Name of Property
Lancaster County, Nebraska
County and State

Address	BP Date	BP #	Builder/Architect	Status	NeHBS LC13:	Occupant	Occupation
Woodsdale Blvd 2220	1935	23236	Hazen, N. Bruce	C	D-4 34	Drake, Ellet, B. (Ruth H)	Treas Bankers Life Ins Co of Neb
Woodsdale Blvd 2240	1929	18535	Meginnis & Schaumberg	C	D-4 27	Aitken, William I. (Helen)	Woods, Woods & Aitkens (atnys)
Woodsdale Blvd 2340	1930	19296	Meginnis & Schaumberg	C	D-4 17	Polley, Edward H. (Lillian H)	exec sec Neb Good Rds Assn
Woodsdale Blvd 2416	1930	19439	Wimmer, C.B.	C	D-4 54	Cowley, Archibald D Lt Col (Mabel M)	instr USA
Woodsdale Blvd 2417	1937	26157	Latture, Sam	C	D-4 54	Gartrell, Harry R. (Evelyn H)	slsmn - 1st name as "Harvey" too
Woodsdale Blvd 2426	1928	18257	Rogers, Walter	C	D-4 65	Stephens, Robert P. (Phyllis)	slsmn Star Pub Co
Woodsdale Blvd 2427	1925	14012	Leverton, E.R.	C	D-4 68	Parks, O Millard	
Woodsdale Blvd 2500	1927	16413	Pierson, A. E.	C	D-4 98	Fieselman, Samuel J. (Atla M)	slsmn Conservative Mtge Co emp US Soil Conservation Service
Woodsdale Blvd 2501	1940	31839	Lorenz, Felix A.	C	D-4 108	Williams, Ross A. (Adelaide)	div mgr O'Shea-Rogers Motor Co
Woodsdale Blvd 2515	1937	25642	Sweeney Construction Co.	C	D-4 109	Burton, Jack B. (Rose)	chf clk Ia-Neb L & P Co
Woodsdale Blvd 2525	1935	24076	Sweeney & Co.	C	D-4 115	Fenton, Alfred E. (Effie L)	contr
Woodsdale Blvd 2526	1928	17247	Rogers, Walter	C	D-4 99	Rogers, Walter G. (Gertrude)	Widow George
Woodsdale Blvd 2536	1928	17339	Rogers, Walter	C	D-4 100	Ayers, Mrs. Susie K.	
Woodsdale Blvd 2554	1937	26561	Anderson, A. O. & Sons	C	D-4 139	Hellmers Jr., Charles R. (M Lucille)	slsmn Sidles Co Airtemp div
Woodsdale Blvd 2566	1928	17757	Sweeney & Co.	C	D-4 140	Butler Charles O. (Selma)	slsmn
Woodsdale Blvd 2580	1929	18844	Sievers, Bruce J.	C	D-4 149	Shine, Ezador (Julia R)	
Woodsdale Blvd 2590	1939	31579	Sweeney Construction Co.	C	D-4 150	Johnson, Murrell B. (Herma W)	Campus Cleaners
Woodsdale Blvd 2601	1927	16862	Sorenz, H.P.	C	D-4 164	Selders, George S. (Kathryn)	slsmn
Woodsdale Blvd 2602	1926	15094	Dennis, Charles	C	D-4 160	Carruthers, Robert D. (Carrie)	br mgr American Credit Corp
Woodsdale Blvd 2616	1931	20089	Sweeney & Co.	C	D-4 161	Crist, Earl R. (Dora A)	sec Lincoln Sales Co
Woodsdale Blvd 2619	1946	43206	Anderson, M.W.	C	D-4 166	Griffin, Leland V. (Colleen)	clk Gooch Milling
Woodsdale Blvd 2626	1941	34175	Craig, Fritz	C	D-4 162	Loder, Merle (Irma G)	dist mgr Mutual Life Ins Co of NY
Woodsdale Blvd 2627	1941	35368	Potter, Harold C.	C	D-4 167	Wiegel, Herman F.	?
Woodsdale Blvd 2635	1924	13126	Suchy, Frank J.	C	D-4 168	Southwarth, Robert (Blanche)	eng. C B & Q R R
Woodsdale Blvd 2636	1947	45250	Pierson, A. E.	C	D-4 163	Holman, Mrs. Edith D.	Widow Marquis/Merchants Delivery
Woodsdale Blvd 2639	1950	53935	Phillips, Hugh L.	C	D-4 169	Gushard Jr., Harry T. (Esther)	compounder Norden Laby
Woodsdale Blvd 2641	1938	27671	Petersen, Ervin E.	C	D-4 170)	federal veterinarian
Woodsdale Blvd 2643	1937	25813	Jackson, Roy	C	D-4 171	Strom, Roy E. (Mildred G)	slsmn
Woodsdale Blvd 2665	1937	26585	Lorenz, Felix A.	C	D-4 172	Hunt, Gerald R. (Helene)	slsmn Hardy Furn Co
Woodsdale Blvd 2675	1938	27739	Lorenz, Felix A.	C	D-4 173	Mockett, Ellis W. (Gladys D)	acct Lester M Buckley
Woodsdale Blvd 2685	1940	31816	Robinson, Marvin	C	D-4 174	Martin, Joseph N. (Mabel I)	fieldmn
Woodsdale Blvd 2705	1951	54875	Hamann, W.G.	C	E-4 142		
Woodsdale Blvd 2727	1938	27100	Lorenz, Felix A.	C	E-4 141		
Woodsdale Blvd 2728	1951	55129	Gillan, W.A.	C	E-4 100	Gillan, W.A.	
Woodsdale Blvd 2737	1938	27166	Lorenz, Felix A.	C	E-4 140		
Woodsdale Blvd 2740	1938	28813	Hoesch, Albert W.	C	E-4 99	Hoesch, Albert W. (Estrude)	contractor, hardware

United States Department of the Interior
National Park Service

National Register of Historic Places
Continuation Sheet

Boulevards Historic District

Name of Property

Lancaster County, Nebraska

County and State

Section number 7 Page 45

Address	BP Date	BP #	Builder/Architect	Status	NeHBS LC13:	Occupant	Occupation
Woodsdale Blvd 2747	1938	27965	Lorenz, Felix A.	C	E-4 139		
Woodsdale Blvd 2757	1938	28979	Lorenz, Felix A.	C	E-4 138		
Woodsdale Blvd 2800	1940	31783	Seivers, John	C	E-4 98	Palmondon, Peter (Elizabeth)	owner, Best Laundry
Woodsdale Blvd 2805	1931	19915	Richardson, R.C.	C	E-4 137		
Woodsdale Blvd 2808	1938	28348	Pierson, A. E.	C	E-4 97	DeBrown, Wallace (Helen)	treas, DeBrown Auto Co.
Woodsdale Blvd 2809	1926	15250	Rathbone Carpenter Co.	C	E-4 136		
Woodsdale Blvd 2818	1928	17611	Bstandig, Ed J.	C	E-4 96	Langerman, Walter	bookkeeper, Yankee Hill Brick
Woodsdale Blvd 2825	1929	18659	Worster, H.J.	C	E-4 135		
Woodsdale Blvd 2830	1937	25848	Lorenz, Felix A.	C	E-4 95	Olsen, Alden (Edna)	Jacob North Bookbinding
Woodsdale Blvd 2840	1951	54632	Solheim, Selmer A.	C	E-4 94	Leonard, Theodore	
Woodsdale Blvd 2845	1930	19546	Lowell, E.L.	C	E-4 134		
Woodsdale Blvd 2900	1937	25830	Pierson, A. E.	C	E-4 93	Chesen, Jacob (Sara)	owner, Capital Broom Wks
Woodsdale Blvd 2910	1929	18809	Larsen, C.M.	C	E-4 92	Howell, Thomas (Pauline)	
Woodsdale Blvd 2915	1929	18488	Robey, Frank A.	C	E-4 160		
Woodsdale Blvd 2925	1935	23174	Miller, A. W. Jr.	C	E-4 161		
Woodsdale Blvd 2928	1929	19098	Lowell, E.L.	C	E-4 91	Magee, Elmer (Evelyn)	Chairman, Magee's Clothing
Woodsdale Blvd 2944	1928	17265	Worster, Henry	C	E-4 90	McKenzie, John (Pearl)	District manager, LT&T
Woodsdale Blvd 3000	1930	19549	Lowell, E.L.	C	E-4 89	Patz, Frederick (Georgia)	attorney
Woodsdale Blvd 3015	1931	20141	Robey, Frank A.	C	E-4 171		
Woodsdale Blvd 3016	1930	19551	Lowell, E.L.	C	E-4 88	Burnett, Earle (Eugenia)	Earle: Real Estate, Eugenia: teacher
Woodsdale Blvd 3045	1936	25581	Miller, A. W. Co.	C	E-4 172		
Woodsdale Blvd 3117	1945	41458	Johnson & Shafer	C	E-4 183		
Woodsdale Blvd 3129	1951	55139	Kessler, Clarence E.	C	E-4 184		
Woodsdale Blvd 3160	1941	35112	Hazen, N. Bruce	C	E-4 197		
Woodsdale Blvd 3165	1949	50070	Schmidt, Richard	C	E-4 277		
Woodsdale Blvd 3175	1957	72517	Michaels, C.J.	C	E-4 24		

**United States Department of the Interior
National Park Service**

**National Register of Historic Places
Continuation Sheet**

Section number 8 Page 1

Boulevards Historic District

Name of Property

Lancaster County, Nebraska

County and State

The Boulevards Historic District is significant at the local level under Criteria A and C in the areas of architecture, community planning and development, landscape architecture, and transportation. The period of significance begins with the Woods Brothers development of Sheridan Place at the northwest part of the district in 1909, the Woods' and Harvey Rathbone's platting of the center of the district in 1916, the termination of streetcar service in 1945, to the completion of most of the residential structures by the 1950s.

While the Boulevards Historic District features beautiful historic houses and has been the residence of mayors, governors, business leaders, and other significant Lincolmites, its preeminent historic significance derives from its pattern of land development and the influence it exerted on Lincoln's community development.

Community Planning and Development

Summary

Lincoln originated in 1867 as the capital city of the new State of Nebraska. The Original Plat of Lincoln (1867) established a grid pattern of north-south and east-west streets which was repeated and expanded in subsequent developments through the end of the 19th century. The development of Sheridan Boulevard and its adjacent subdivisions, beginning in 1909, broke with the earlier pattern by following the topography and emphasizing landscaped boulevards. The subsequent developments eliminated alleys and eventually sidewalks to emphasize "country lanes" within the urban development. The pattern of land development of this area influenced subdivisions throughout the community for the remainder of the century.

The Woods brothers—Frank, Mark, and George—were active in Lincoln real estate development and sales from the 1889. Mark Woods recalled in 1950 that by 1889 houselots had been platted several miles in every direction from the city center, but little effort had been made to link the various development or provide utilities and transportation services.¹ Within the area of the Boulevards Historic District, parcels had been platted along South Street in the vicinity of S. 22nd-S. 24th as early as 1887. The development of the Rock Island Railroad on the east side of the future residential neighborhood in 1892 prompted platting and replatting along its right-of-way. The Woods Bros. themselves filed a small subdivision on the east side of South 27th Street in 1894 called Capitol Hill which is the southernmost portion of the Boulevards District. Like many of the far-flung, speculative subdivisions of the 1880s and early 1890s, Capitol Hill did not develop for a half-century.

All of these early subdivisions reflected the grid-pattern of streets and lots of Lincoln's Original Plat of 1867, with the single exception of the curvilinear layout of "Grandview," a picturesque suburban plan at the north central edge of the urban area (1st to 14th, north of Superior). Intended to provide a college campus as well as a residential development, the Grandview project failed when Worthington Academy was destroyed by an explosion in 1898. The only similar land development to succeed in the vicinity of Lincoln was Wyuka Cemetery, a picturesque "rural" cemetery begun in 1869 (NRHP).

¹ Mark Woods, "Lincoln Real Estate...," *Lincoln Sunday Journal Star*, January 29, 1950.

United States Department of the Interior
National Park Service

National Register of Historic Places
Continuation Sheet

Section number 8 Page 2

Boulevards Historic District

Name of Property

Lancaster County, Nebraska

County and State

Mark Woods reminisced “About 1910 [actually 1909], my brother George and I felt the development of modern residential lots with shrubbery planned and setback and building-cost restrictions would pay us for the effort as well as beautify Lincoln...” They acquired “a beautiful tract of corn field” southeast of Lincoln, feeling that creeks and existing railroads would funnel development in this direction. “The first step of this 20 year plan was Sheridan Place.”² The Woods Bros. promoted their new addition with frequent, large and bold newspaper advertisements, offering free trolley rides, free band concerts, and well-lit evening sales events: “...a Free Bank Concert will be given in Sheridan Place by Mr. Hagenow’s fine musical organization. In addition to the concert there will be a dazzling scheme of illumination, every corner of the addition being as bright as day.”³

Three aspects of the Sheridan Place development were especially noteworthy and innovative among Lincoln subdivisions. First, the developers invested significantly in infrastructure up-front, including 2.5 miles of concrete sidewalks, planting of both coniferous and deciduous street trees, complete water and sewer systems, roadways, and even a streetcar system down the center of the boulevard.⁴ Second, the Woods Bros. inserted several covenants into the deeds for the houselots, including restrictions on use (residential only) and setback from the street. They also required a minimum of \$10,000 investment in houses on Sheridan Boulevard but as little as \$4,000 for houses built on the secondary streets, explaining in their advertising “Homes for the poor as well as the rich. We have many beautiful lots in this addition that we are offering to the young men and the young women who are fighting and saving for a home.”⁵ Lastly, they oriented the Boulevard not in conformance with the Lincoln grid, but rather “on the crowning point of the ridge running southeast from the Capitol...”⁶ “We believed winding streets greatly added to the attractiveness of an addition. The low drainage area south of Sheridan [Woodsdale] lent itself marvously to this type of development.”⁷

The subsequent developments of Woodsdale, Woodscrest, Sheridan Park, and Rathbone’s Sunset Hills all followed these three precedents, especially of maximizing the topography in the layout of streets and lots. The arterial streets maintained the grid while the pattern within that framework responded to the land. The subsequent developments also utilized covenants, with the addition (by Rathbone, beginning with Sheridan Park in 1916) of racial exclusion clauses, requiring “no person other than the Caucasian race, shall be or become the grantee or leasee of said property

²*Ibid.*

³“Music and a Maze of Lights in Sheridan Place,” *Nebraska State Journal*, June 26, 1909, 3.

⁴“Lots Now on Sale in Sheridan Place,” *Sunday State Journal* [Lincoln, NE], June 20, 1909.

⁵*Ibid.*

⁶*Ibid.*

⁷Woods, “Lincoln Real Estate Developed...” *Lincoln Sunday Journal Star*, Jan. 29, 1950.

**United States Department of the Interior
National Park Service**

**National Register of Historic Places
Continuation Sheet**

Section number 8 Page 3

Boulevards Historic District

Name of Property

Lancaster County, Nebraska

County and State

except as a servant of the family living thereon..."⁸ The Woods Brothers' subsequent developments in the District did not typically utilize such race clauses, at Woodscrest (1916) or Woodsdale (1917) or Woods Bros. Country Club Addition (1919), although after 1916 they were not unique to Rathbone developments.

Smaller innovations in the District's land patterns include elimination of alleys and in some areas, omission of sidewalks. The Woods Bros.' verbose advertising did not address these features (and Sheridan Place originally had both sidewalks and alleys, and sidewalks are included throughout Sheridan Park, Woodsdale, and Woodscrest). These omissions allowed greater density without directly reducing lot sizes. They may also have been intended to create a less "urban" atmosphere in Sunset Hills, Colonial Village, and Capitol Hill—the areas built in the later decades of the period of significance.

Transportation

Summary

In addition to the landscaped roadways, the District strongly emphasized transportation by providing a street car line down the center median of Sheridan Boulevard. The initial development of Sheridan Place of 1909 included roadways, sidewalks, alleys, and streetcar service. Subsequent developments eliminated first the alleys, provided narrower roadways, and eventually eliminated even sidewalks, reflecting an evolving view of how various modes of transportation should be served.

Mark Woods stated in 1950 "The development of new additions had many difficulties...When we couldn't get transportation, we had to organize the White Line traction company, later merged into the Lincoln Traction company."⁹ The landscaped median of Sheridan Boulevard provided space for the single-track trolley line, with a double-track "switch" at Van Dorn and a double wooden trestle over the Rock Island Railroad northwest of 33rd Street. That bridge was nicknamed "Penny Bridge" for the extra fare required to pass that point on the way to the town of College View. This trolley service was one of the last two lines maintained in Lincoln, ceasing on VJ Day in the summer of 1945 when wartime restrictions on cessation of trolley service were lifted.¹⁰ The wooden streetcar trestles have been removed but the twin vehicular/pedestrian bridges, with cast concrete railings, still span the Rock Island Trail and are known as Penny Bridge.

Sheridan Place of 1909 (South Street to Lake Street, So. 24th to So. 27th) was the only one of the twentieth century developments in the district to be platted with alleys behind the houselots. Those alleys were soon vacated and all of the subsequent developments eliminated these secondary vehicular routes. Sidewalks continued to be a feature of the subdivisions as late as 1921 (Woods Bros. Country Club Addition—Woodsdale from Van Dorn to So. 24th) but began to be omitted from developments, especially by Harvey Rathbone, such as Rathbone's Sunset Hills of the mid-1920s and Rathbone's Colonial Village of 1939. On the narrow pavements in those area all the transportation modes are

⁸For instance, in Lancaster County Deed 235:466 of 1922.

⁹Woods, "Lincoln Real Estate Developed..." *Lincoln Sunday Journal Star*, Jan. 29, 1950.

¹⁰McKee, James, *Lincoln: The Prairie Capital*, 102.

**United States Department of the Interior
National Park Service**

**National Register of Historic Places
Continuation Sheet**

Section number 8 Page 4

Boulevards Historic District

Name of Property

Lancaster County, Nebraska

County and State

mingled--pedestrians as well as non-motorized and motorized vehicles, except where narrow sidewalks have been added along the curbs. Even Capitol Hill (north of Calvert Street), platted in 1894, was built-out after World War II with few sidewalks and narrow pavements.

Architecture

Summary

Lincoln's leading architects and builders were extremely active in the Boulevards District, producing Lincoln's premier collection of high-style homes of first half of the twentieth century. Although vernacular homes such as American Foursquares and bungalows occur throughout the district, period revival style residences dominate. As a Lincoln newspaper explained in 1929:

Practically all additions developed within the last ten years have been in hands of real estate operators. They are highly restricted as to set back from the front lot line, grading, type and size of home, construction, restrictions against business, and other protections for the home buyer....Another thing that comes with modern subdividing is good taste and judgement in architecture, a knowledge of which is found by real estate salesmen in most prospective home buyers. A great many homes of western architecture, the square frame houses built during the twenty years previous to 1918, have become obsolete. Instead, such types as English Colonial, New England Colonial, Southern Colonial, Dutch Colonial, and Spanish and Italian designs are in great favor.¹¹

Several builders and architects were especially active in the District, led by Harvey Rathbone himself who was responsible for nearly 10% (approximately 119) of the homes in the district and a much higher percentage within his Sheridan Park development in the 1910s and 1920s. Architect/contractor Selmer Solheim built and/or designed over 50 homes in the 1940s and 1950s, often in association with Sweeney Construction Company. Other active builders were John M. Alexander (34 houses), William G. Fullagar (33), and A. W. Miller & Co. (28 homes, plus many of Unthank's 43 houses). Ed J. Bstandig constructed 27 homes; A. E. Pierson added 24 homes; and Felix A. Lorenz of College View built 23 houses.

The leading designer after Solheim was John O. Unthank (over 40 homes). Jesse Miller and Fritz Craig designed over two dozen homes, some separately but mostly in partnership. N. Bruce Hazen was architect for 24 homes. Davis and Wilson designed 21 structures in the district including major houses and Westminster Church, Tifereth Israel Synagogue, and Sheridan School. Ellery L. Davis designed his own fine, Colonial Revival home at 2740 Van Dorn Street. Ferdinand Fiske, alone or in partnership with Harry Meginnis, designed sixteen of the largest homes in the district. Later partnerships of Meginnis & Schaumberg and Schaumberg & Freeman added 22 more buildings, including Irving Junior High

Period Revival styles are predominant in the district throughout its development, with the larger examples clustered on Sheridan Boulevard, Woodscrest, South 24th Street, Van Dorn Street, and the west end of Woodsdale Boulevard. Tudor, Colonial, and French Eclectic examples are well-represented. Smaller houses throughout the district also

¹¹*Sunday State Journal*, January 27, 1929.

**United States Department of the Interior
National Park Service**

**National Register of Historic Places
Continuation Sheet**

Section number 8 Page 5

Boulevards Historic District

Name of Property

Lancaster County, Nebraska

County and State

display Tudor and Colonial Revival characteristics, especially in Colonial Village along Plymouth, Alden, Winthrop, Puritan, and Colonial Drive, and in the southernmost part of the district on from 27th to 31st Streets. Interspersed in those post-World War II developments are numerous ranch-style houses, frequently by the same architects or builders as the Period Revival examples. South 31st Street also features two of Lincoln's few

Modernist houses at 3401 S. 31st (by John Chalmers, 1951) and next-door at 3417 S. 31st (also 1951, by Clark & Enersen for architect Art Duerschner).

Landscape Architecture

Major elements of the district were designed by Ernst Herminghaus, Nebraska's first academically educated landscape architect, and nationally-prominent, Chicago-based Jens Jensen, called "the dean of American landscape architecture" by the *New York Times* upon his death in 1951. Jensen designed both the Woodscrest Addition for the Woods Brothers and Frank Woods' own two acre house-lot (2501 Sheridan Blvd., NRHP), in 1916.¹² Lincoln native Ernst Herminghaus graduated from Harvard in 1915 and returned to Lincoln with classmate Tell Nicholet. Together they signed Harvey Rathbone's maps for his Sheridan Park subdivision of 1916.¹³ Herminghaus also designed the landscape for the individual house site at 2600 Woodscrest Avenue. Herminghaus also designed many Lincoln parks, including Pioneers Park (NRHP) and the grounds of the Nebraska State Capitol (National Historic Landmark).

¹²Sarah Davis, "Frank and Nelle (Cochran) Woods House National Register Nomination, 1995; Robert E. Grese, *Jens Jensen: Maker of Natural Parks & Gardens*, 211, 212.

¹³Richard Sutton, "Ernst H. Herminghaus, Landscape Architect," *Nebraska History*, Winter 1985, 371-391.

**United States Department of the Interior
National Park Service**

**National Register of Historic Places
Continuation Sheet**

Section number 9 Page 1

Boulevards Historic District

Name of Property

Lancaster County, Nebraska

County and State

Bibliography

Baldwin, Sara Mullin, ed., *Who's Who in Lincoln*, Lincoln, NE: Robert M. Baldwin, 1928.

Beautiful Lincoln: Nebraska's Capital City. Lincoln, Nebraska: The Woodruff Press, 1912.

Beltzer, Chris; Anna Bosshardt and Ed Zimmer, "W. F. Hitchcock House, 2733 Sheridan Blvd.," National Register nomination, 2002.

Chase, Elizabeth A., "*Sheridan: a walking tour of Lincoln's grand boulevard*," Master's project, Community & Regional Planning Program, College of Architecture, University of Nebraska-Lincoln, 2000.

Davis, Sarah H., "Frank and Nelle (Cochrane) Woods House, 2501 Sheridan Blvd.," National Register nomination, 1995.

Grese, Robert E., *Jens Jensen: Maker of Natural Parks & Gardens*, Baltimore and London: The Johns Hopkins University Press, 1992.

Hansen, Matthew, "Frank Spalding House, 2221 Sheridan Blvd.," National Register nomination, 1998.

City of Lincoln Building Permits.

City of Lincoln Deed Records.

Lincoln City Directories, (1899-1997).

Lincoln: Nebraska's Capital City 1867-1923. Lincoln, Nebraska: The Woodruff Printing Company, 1923.

McAlester, Virginia and Lee. *A Field Guide to American Houses*. New York: Alfred A. Knopf, 1996.

McKee, James, *Lincoln: The Prairie Capital*, 102.

Murphy, David. "Arthur C. Ziemer House." *National Register of Historic Places Nomination Form*. 1971.

Nebraska State Journal. "Sheridan Place Home of F.M. Spalding." April 11, 1909. 8-B:3-4.

Sanborn Fire Insurance Company. *Sanborn Fire Insurance Atlas*. 1928.

Richard Sutton, "Ernst H. Herminghaus, Landscape Architect," *Nebraska History*, Winter 1985, 371-391.

**United States Department of the Interior
National Park Service**

**National Register of Historic Places
Continuation Sheet**

Section number 9 Page 2

Boulevards Historic District

Name of Property

Lancaster County, Nebraska

County and State

Whiffen, Marcus. *American Architecture Since 1780: A Guide to the Styles*. Cambridge, MA: The M.I.T. Press, April 1979.

Woods Bros. Cos. (Newspaper Advertisements)

“Woods Investment Co. Franklin Heights,” *Sunday State Journal* (Lincoln, Nebraska), January 3, 1909, 8-B.

“Lots Now On Sale in Sheridan Place,” *Sunday State Journal* (Lincoln, Nebraska), June 20, 1909, 8-B.

“Free! Absolutely Free” [street car ride to Sheridan Place], *Nebraska State Journal* (Lincoln, Nebraska), June 24, 1909.

“Music and a Maze of Lights in Sheridan Place,” *Nebraska State Journal* (Lincoln, Nebraska), June 26, 1909, 3.

“What We Have Done and Are Doing,” *Sunday State Journal* (Lincoln, Nebraska), June 27, 1909.

“Band Concert,” *Nebraska State Journal* (Lincoln, Nebraska), June 29, 1909.

Woods, Mark W. “Lincoln Real Estate Developed From Confusion to Orderliness,” *Lincoln Sunday Journal Star*, January 29, 1950.

“Woods, Mark W.” obituary, *Lincoln Star*, June 30, 1956, 1:3.

Zimmer, Edward F. *The Near South Walking Tours Volume 1: Franklin Heights and Environs*. Lincoln, NE: Near South Neighborhood Association, 1989.

**United States Department of the Interior
National Park Service**

**National Register of Historic Places
Continuation Sheet**

Section number 10 Page 1

Boulevards Historic District

Name of Property

Lancaster County, Nebraska

County and State

Geographic Data

Additional UTM References

Zone	Easting	Northing	Zone	Easting	Northing
5 14	696300	4516625	9 14	695250	4516800
6 14	696125	4516375	10 14	694950	4517200
7 14	695625	4516375	11 14	694950	4517550
8 14	695625	4516800	12		

Verbal Boundary Description

The Boulevards Historic District is bounded on the north by South Street, from S.24th Street on the west to 3033 South Street on the east. The west boundary is S. 24th Street from South Street to Lake Street, and South 20nd from Lake Street to Van Dorn. The boundary follows the north and east edges of the Lincoln Country Club–Woodsdale Boulevard from Van Dorn to South 24th Street, South 24th Street to High Street, High Street to South 27th Street, and South 27th Street south to Calvert Street. Calvert Street is the south boundary between South 27th and South 31st Streets. The east edge of the District is the Rock Island Trail (formerly R. I. Railroad), excluding the modern development of Hanson Drive at the southeast corner, and the commercial structures and parking lots of Rathbone Village at the northeast corner. Also, see attached map.

Boundary Justification

The Boulevards Historic District centers around a series of related residential subdivisions platted by the Woods Brothers and Harvey Rathbone between 1909 (Sheridan Place) and 1939 (Rathbone’s Colonial Village). The major additions include Woodscrest Addition (1916), Sheridan Park (1916), Sheridan Heights (1916), Sheridan Summit (1916), Woodsdale (1917), and Woods Brothers Country Club Addition (1921). Also included are Homecrest Addition (S. 20th to S. 22nd, Van Dorn to Harrison) which was neither Woods Brothers nor Rathbone, but adjoins Woodscrest and completes the south side of Woodscrest’s Harrison Ave. Capitol Hill (S. 27th to S. 31st, north of Van Dorn) was platted by the Woods Bros. much earlier (1894) but did not develop for nearly half a century until post-WWII, when it built-out in very similar architectural and landscape character to the much later plats adjacent to it. The recent residential development adjacent to the district at the southeast corner was excluded because in date and type of construction it is neither consistent with, nor visible from, the streets of the District. The Rathbone Village commercial area northeast of the district is distinct from the residential area in land form, uses, and types and dates of construction.

Boulevards Historic District

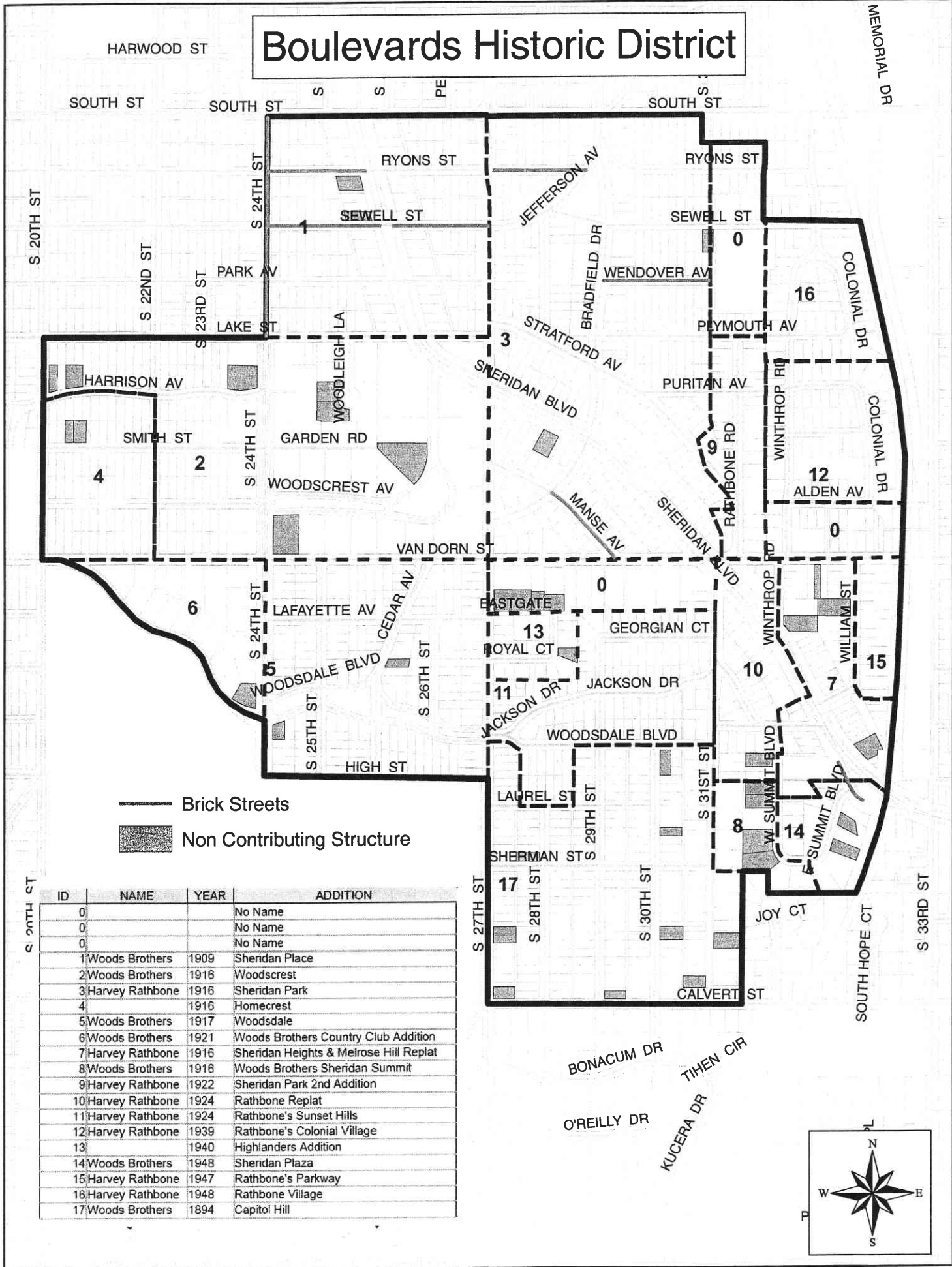

Boulevards Historic District

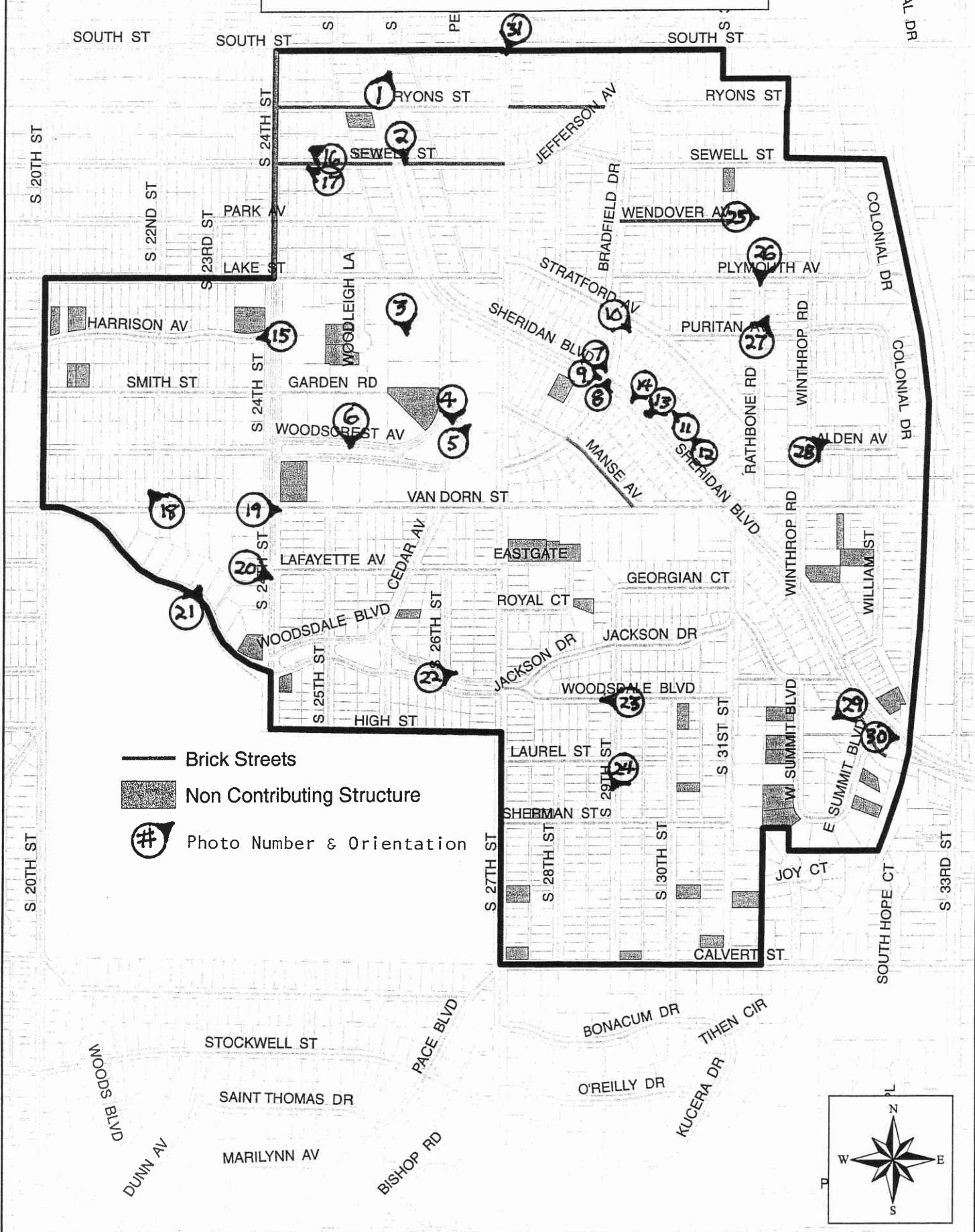

-  Brick Streets
-  Non Contributing Structure
-  Photo Number & Orientation

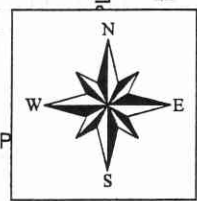



Photo 1 of 31. View from the southwest of Westminster Presbyterian Church, 2110 Sheridan Blvd., showing the principal, west facade



Photo 2 of 31. View from the northwest along the east side of Sheridan Blvd, from Sewell St



Photo 3 of 31. View of the Frank & Nelle Woods House (NRHP-listed), 2501 Sheridan Blvd., from the north-northwest. Jens Jensen was landscape architect for the Woods estate and surrounding Woodscrest Addition



Photo 4 of 31. View south on Woodscrest Avenue towards 2750 and 2770 Woodscrest Avenue



Photo 5 of 31. View from southwest of Dorgan House at right (2710 Woodcrest Ave) and Miller House at left (2636 Woodcrest Ave)



Photo 6 of 31. View south across Woodcrest Ave to Faulkner House at left (2485 Woodcrest) and John Campbell House at right (2465 Woodcrest)



Photo 7 of 31. View from northwest along east side of Sheridan Blvd from Bradfield Dr. The Dierks House (2900 Sheridan Blvd) is at left. Note the border hedges at the sidewalks and curbs



Photo 8 of 31. View from south of Bradfield Dr from Sheridan Blvd. Dierks House (2900 Sheridan Blvd) is at right



Photo 9 of 31. View from northwest Sheridan Blvd from Bradfield Dr. The Sheridan right-of-way is 150 feet wide. The Gardner House (2920 Sheridan Blvd) is at left



Photo 10 of 31. View from northwest of 2901 Stratford Ave on the corner of Bradfield Dr



Photo 11 of 31. View from southeast along Sheridan Blvd. 2990 Sheridan Blvd is at right and 2950 Sheridan Blvd is centered in the view



Photo 12 of 31. View from southeast along Sheridan Blvd showing the Kohn House (#3020) at right and the Albert Miller House at center (#3000)



Photo 13 of 31. View across Sheridan Blvd from the northeast showing (left to right) 3009, 2961, and 2943 Sheridan Blvd



Photo 14 of 31. View from northeast across Sheridan Blvd to Sartor House, 2943 Sheridan Blvd, built in 1923, Fiske & Meginnis architects



Photo 15 of 31. View from east on Harrison Ave showing William Hoppe House (#2303) at left



Photo 16 of 31. View from east southeast on Sewell St showing brick pavement. 2426 Sewell built in 1919 is at right



Photo 17 of 31. View from northeast on Sewell St showing (left to right) 2461, 2453, 2443 Sewell, built in 1922, 1919 and 1909 respectively



Photo 18 of 31. View form east southeast of Irving Middle School, 2745 S 22nd, designed by Meginnis & Schaumberg and built in 1926



Photo 19 of 31. View from west on Van Dorn St at S 24th. The Mattison House built in 1924 is at right (2401 Van Dorn)



Photo 20 of 31. View from west across S 24th St median, showing (left to right) 2900, 2908 and 2920 S 24th. These three compatible “cottages” were built over 3 decades (1947, 1927 and 1938 respectively)



Photo 21 of 31. View from the south of 2240 Woodsdale Blvd, the Aitken House of 1929, designed by Meginnis & Schaumberg.



Photo 22 of 31. View west of 2602 Woodsdale Blvd, built in 1926.



Photo 23 of 31. View from east on Woodsdale Blvd from S 29th St



Photo 24 of 31. View from north on S 29th St. 3125 S 29th is at left.



Photo 25 of 31. View from west on Wendover Ave of Sheridan Elementary School, designed by David & Wilson and built in 1925 at 3100 Plymouth Ave



Photo 26 of 31. View from Sheridan School grounds, looking south across Plymouth Ave to Rathbone Rd



Photo 27 of 31. View from southwest at intersection of Rathbone Rd and Puritan Ave, showing 2540 Rathbone Rd at right



Photo 28 of 31. View from southwest of north side of Alden Ave, east of Winthrop Rd. 3100 Alden Ave is at left, built in 1940



Photo 29 of 31. View of Congregation Tifereth Israel Synagogue from northeast at 3215 Sheridan Blvd. The synagogue was designed by Davis & Wilson and built in 1954



Photo 30 of 31. View from west of Penny Bridge carrying Sheridan Blvd over the Rock Island Railroad (now Rock Island Trail), west of S 33rd. The bridge was built in 1934



Photo 31 of 31. View from northeast of the South Branch Lincoln City Library, 2675 South St, designed by Martin Aitken and built in 1955.